



**SEA®**  
Sistemi Elettronici  
di Apertura Porte e Cancelli  
International registered trademark n. 804888

SEA S.r.l.  
DIREZIONE E STABILIMENTO:  
Zona industriale 64020 S.ATTO Teramo - (ITALY)  
Tel. 0861 588341 r.a. Fax 0861 588344

<http://www.seateam.com>  
e-mail: [seacom@seateam.com](mailto:seacom@seateam.com) (Uff. Commerciale)  
[seamec@seateam.com](mailto:seamec@seateam.com) (Uff. Tecnico meccanico)



**BATTUTA MECCANICA**  
**MECHANICAL POSITIVE STOPS**  
**FEUILLURE MÉCANIQUE**  
**TOPE MECANICO**  
**MECHANISCHER ANSCHLAG**  
**HALF TANK**

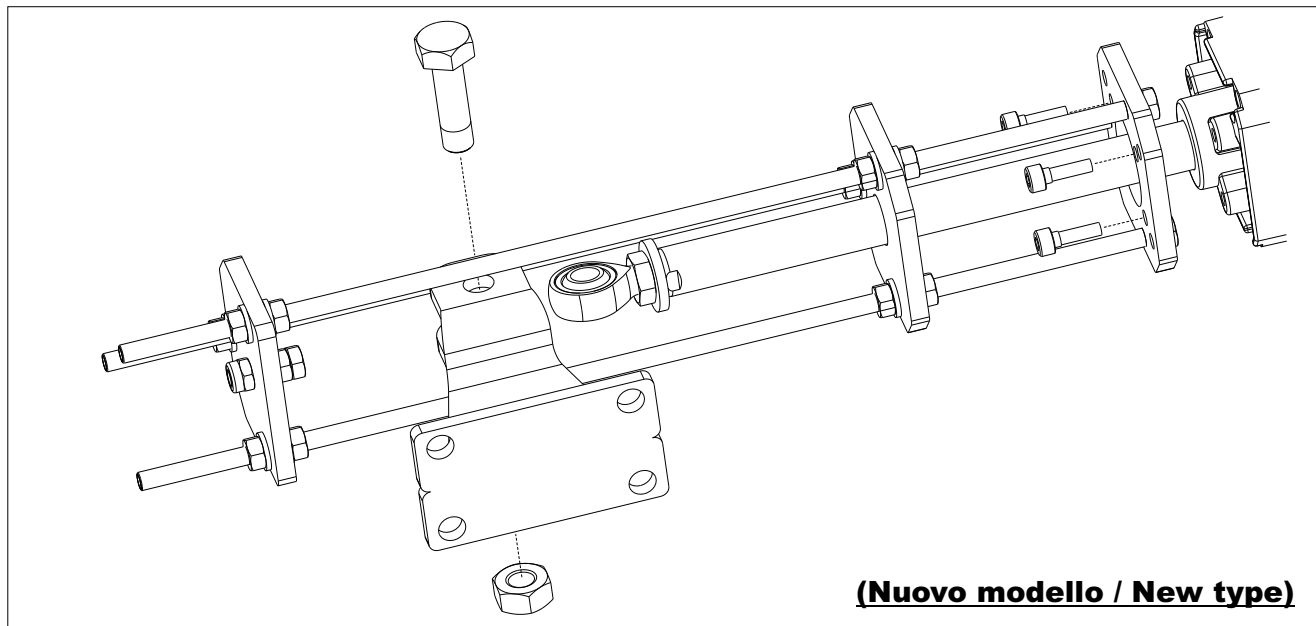

**(Nuovo modello / New type)**

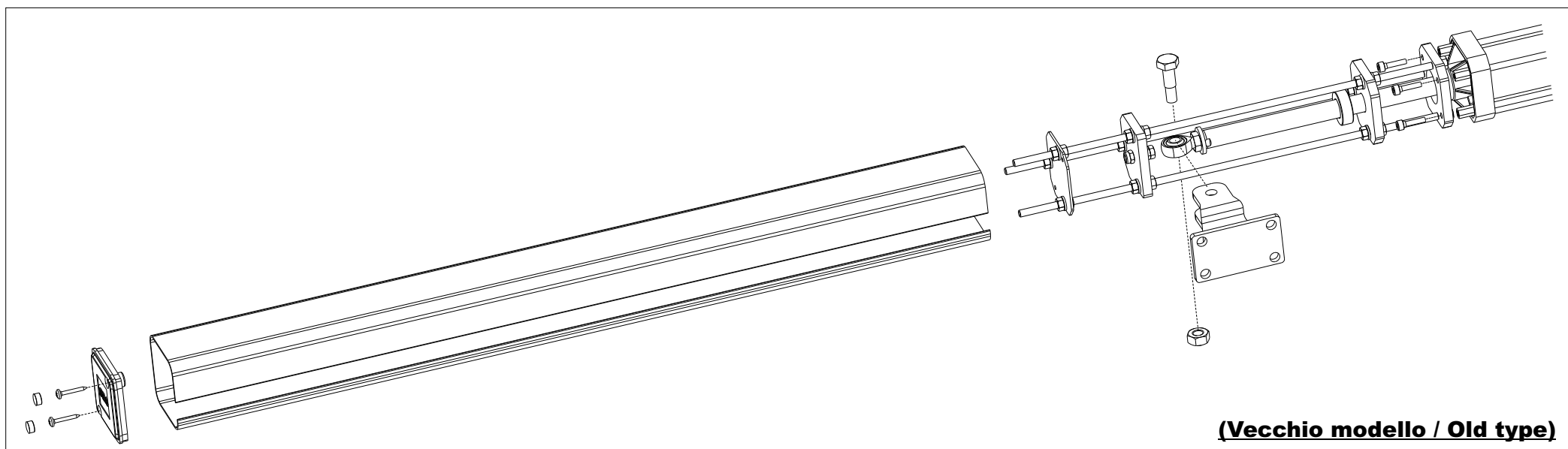

**(Vecchio modello / Old type)**



**SEA®**  
Sistemi Elettronici  
di Apertura Porte e Cancelli  
International registered trademark n. 804888

SEA S.r.l.  
DIREZIONE E STABILIMENTO:  
Zona industriale 64020 S.ATTO Teramo - (ITALY)  
Tel. 0861 588341 r.a. Fax 0861 588344



<http://www.seateam.com>  
e-mail: [seacom@seateam.com](mailto:seacom@seateam.com) (Uff. Commerciale)  
[seamec@seateam.com](mailto:seamec@seateam.com) (Uff. Tecnico meccanico)



**BATTUTA MECCANICA**  
**MECHANICAL POSITIVE STOPS**  
**FEUILLURE MÉCANIQUE**  
**TOPE MECANICO**  
**MECHANISCHER ANSCHLAG**  
**FULL TANK**

