

SEA®

Sistemi Elettronici
di Apertura Porte e Cancelli
International registered trademark n. 804888

CE

ITALIANO

BATTUTA MECCANICA REGOLABILE PER ALPHA

Nota: Se la piastra forata (A) è già montata, seguire le istruzioni iniziando dal punto 6, nel caso contrario seguire le istruzioni di montaggio iniziando dal punto 1.

1. Svitare i 2 dadi esagonali che si trovano sull'operatore ALPHA di ca. 3/5 mm o solo del minimo essenziale per inserire una pinza a punta per bloccare il tirante interno, a questo punto svitare completamente i dadi (Fig. 1).

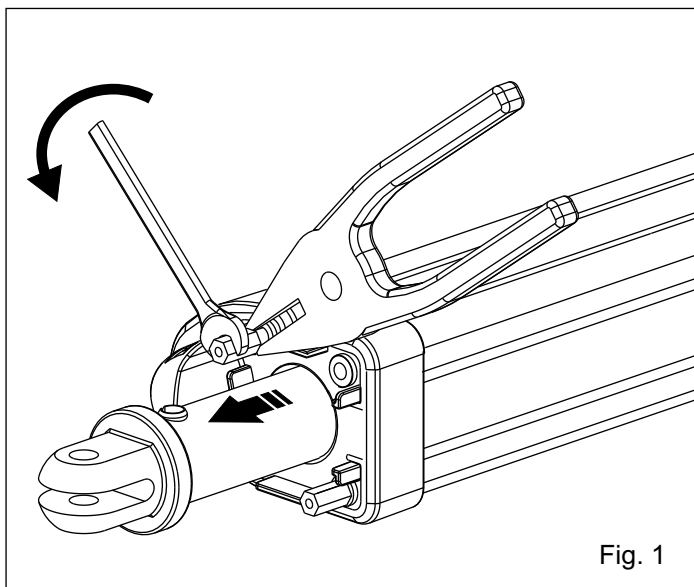

Fig. 1

2. Avvitare completamente i 2 dadi esagonali forniti con la battuta meccanica (Fig. 2).

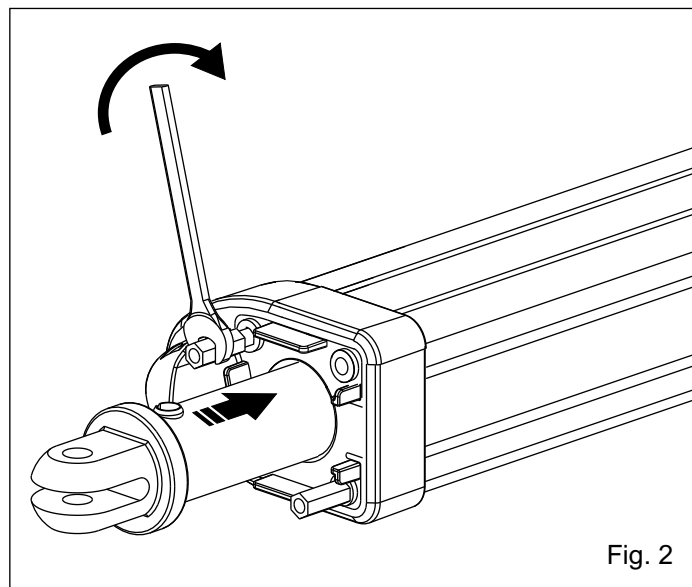

Fig. 2

3. Ruotare in senso orario lo stelo per tirarlo fuori di 15 cm ed estrarre la spina di serratura della **forcella** anteriore usando un estrattore di spine con Ø 10 ed un martello (Fig. 3).
AVVERTENZA: Verificare che tutto il lavoro sia effettuato su una superficie molto solida.

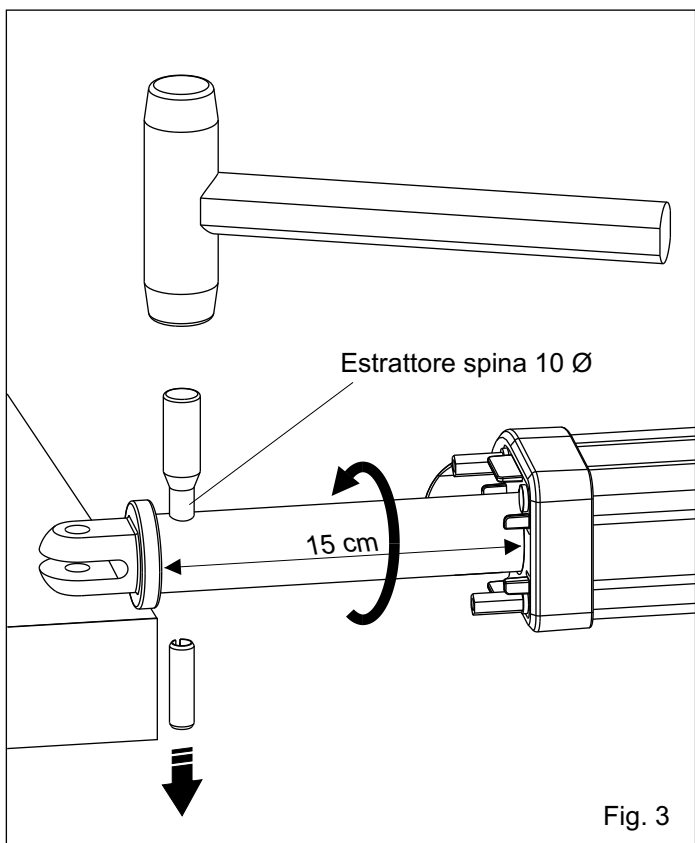

Fig. 3

4. Estrarre la forcetta anteriore ed inserire la piastra forata nello stelo come in Fig. 4.

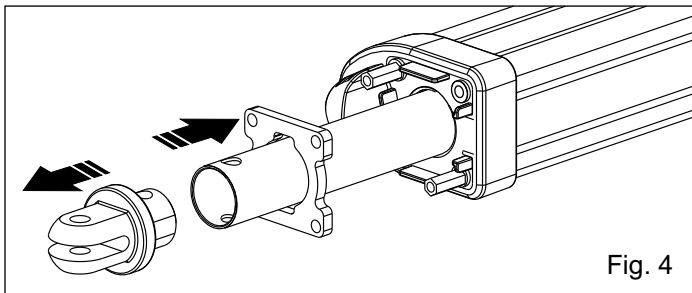

Fig. 4

5. Reinserire la forcetta anteriore nello stelo e bloccarla inserendo la spina adatta (Fig. 5). Assicurarsi che la spina fuoriesca nella stessa misura da ambo i lati.

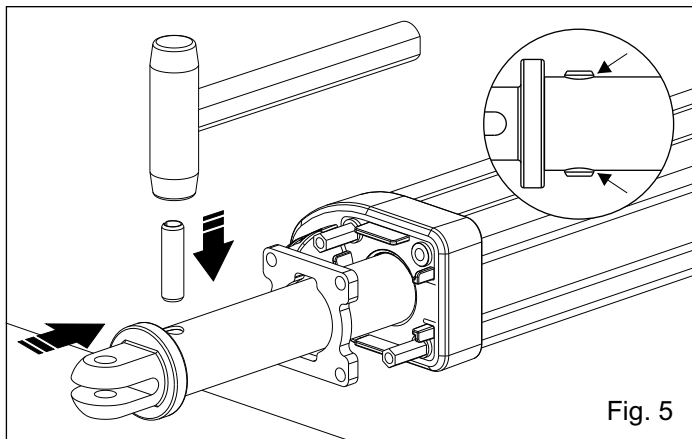
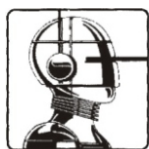

Fig. 5



SEA®

Sistemi Elettronici
di Apertura Porte e Cancelli
International registered trademark n. 804888



ITALIANO

6. Inserire i dadi ed avvitare i 4 tiranti fino al serraggio (Fig. 6).

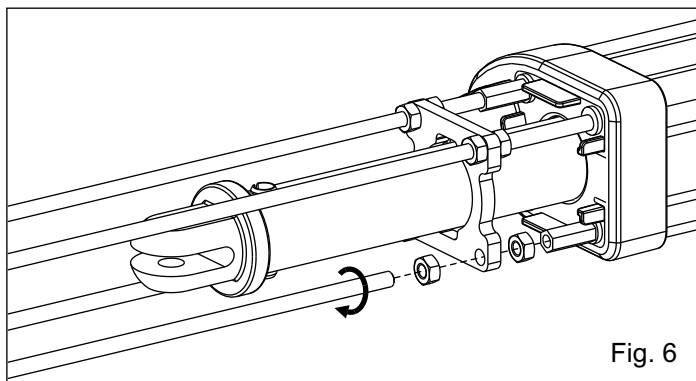

Fig. 6

7. Inserire la piastra forata nei tiranti, poi avvitare 2 dei 4 dadi precedentemente rimossi in corrispondenza delle 2 viti a morsetto del copristelo (Fig. 7).

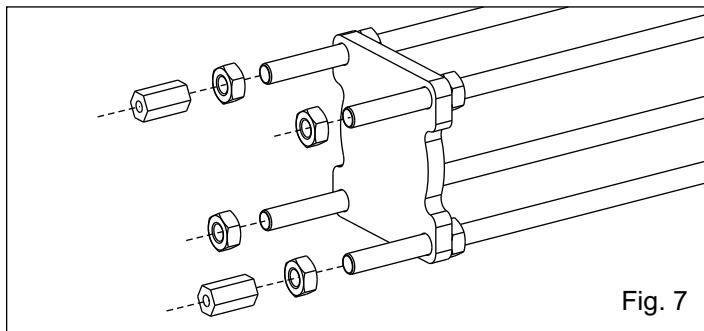

Fig. 7

8. Regolare la battuta meccanica secondo le proprie necessità, usando i dati adatti (Fig. 8).

Nota importante: la forcella anteriore deve combaciare perfettamente con la piastra 1 (fig. 9-10),

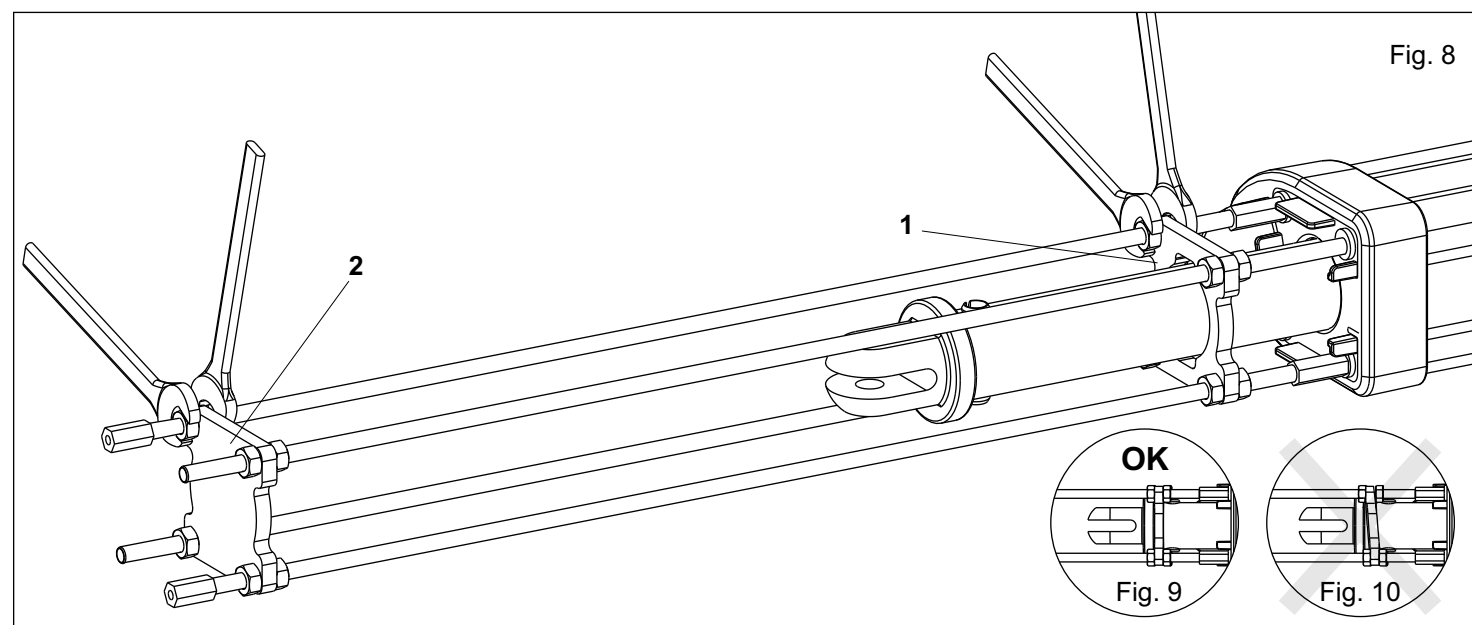

Fig. 8

9. Dopo aver terminato la regolazione, installare il copristelo (Fig. 11).

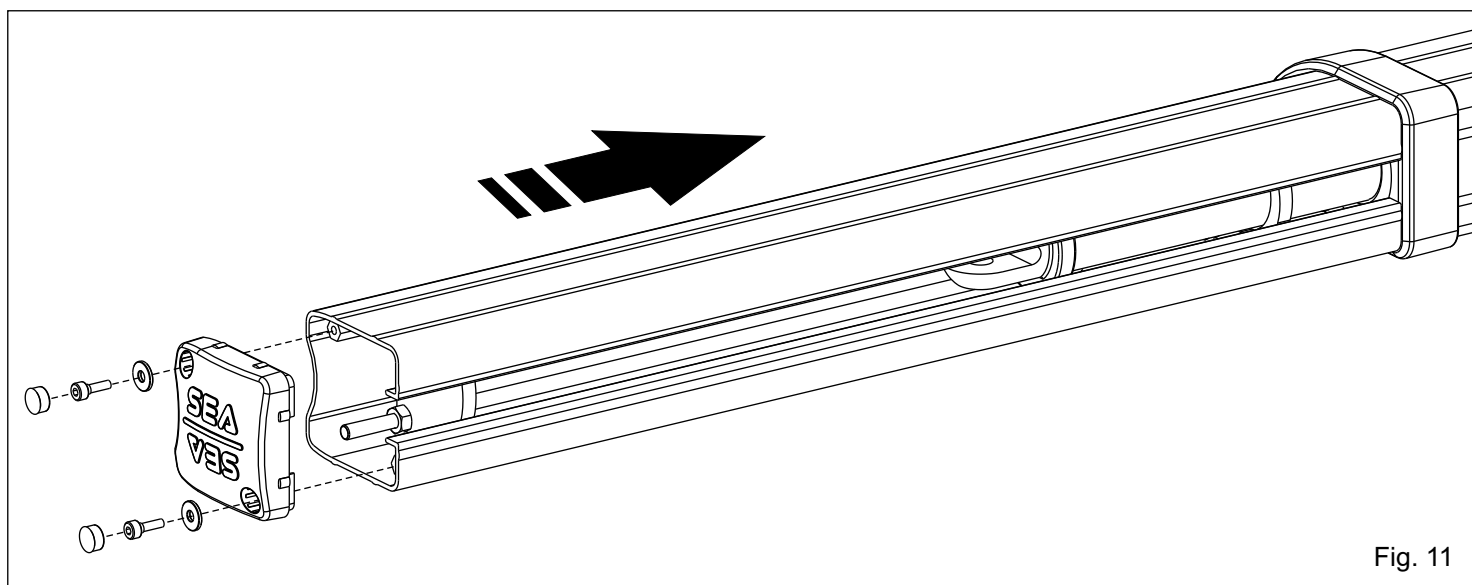
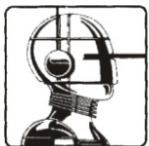

Fig. 11

Per ottimizzare la funzione dello stop, si raccomanda vivamente di installare una centralina elettronica con rallentamento in apertura e chiusura.



SEA®

Sistemi Elettronici
di Apertura Porte e Cancelli
International registered trademark n. 804888

CE

ENGLISH

ADJUSTABLE MECHANICAL STOP FOR ALPHA

Note: If the pierced plate (A) is already mounted, follow the instructions starting from point 6, in the contrary case follow the mounting instructions starting from point 1.

1. Unscrew the 2 hexagonal nuts that you find on ALPHA operator of about 3/5 mm or just the minimum essential in order to insert a tip chuck for blocking the internal tie rod, at this point unscrew completely the nuts (Fig. 1).

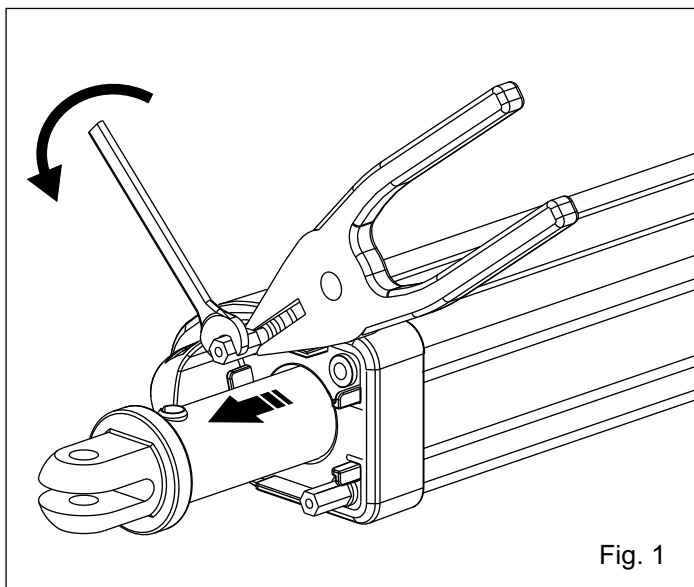

Fig. 1

2. Screw completely the 2 hexagonal nuts which are supplied with the mechanical stop (Fig. 2).

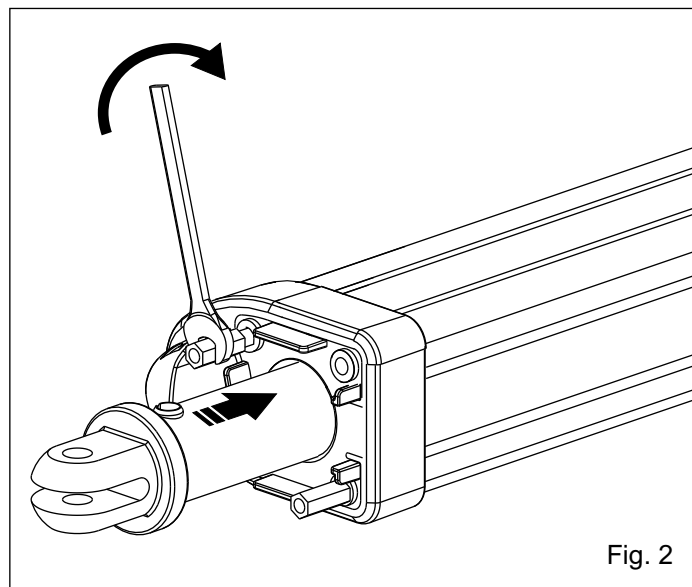

Fig. 2

3. Rotate clockwise the stem in order to pull it out of 15 cm and take out the lock pin of the front fork using a 10 Ø pin extractor and a hammer (Fig. 3).

WARNING: Take care to do everything on a very firm surface.

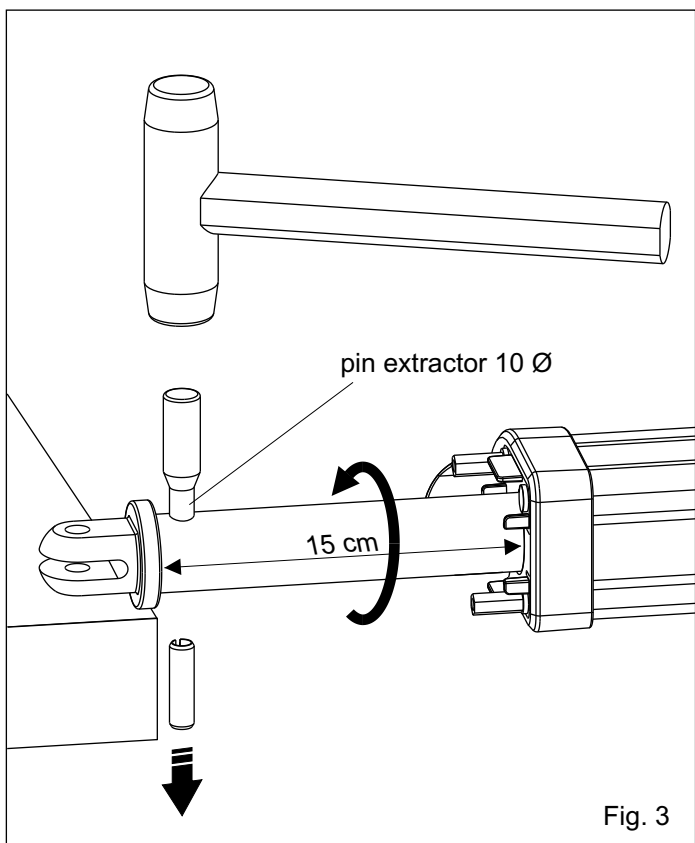

Fig. 3

4. Extract the front fork and insert the small pierced plate in the stem as in Fig. 4.

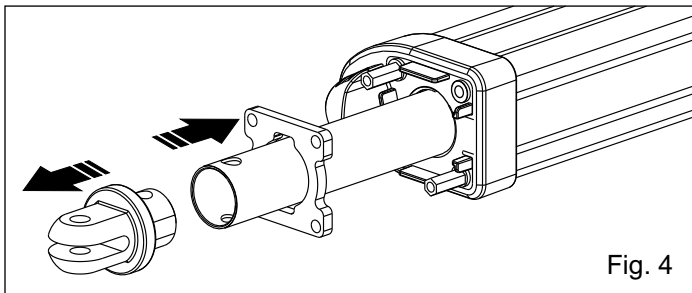

Fig. 4

5. Reinsert the front fork in the stem and lock it inserting the appropriate pin (Fig. 5).
Assure that the pin pulls in the same measure out from both sides.

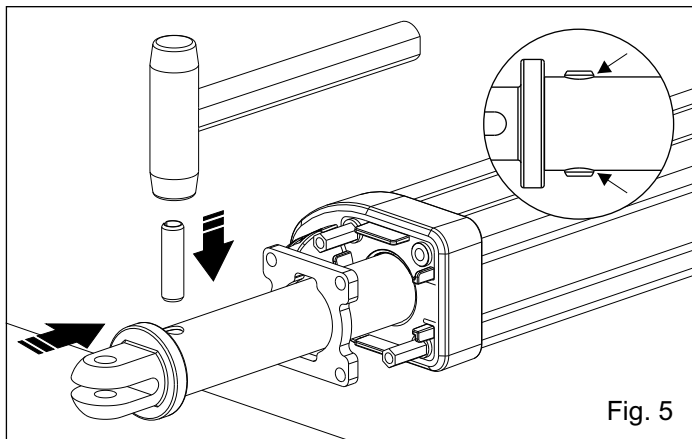
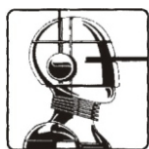

Fig. 5



SEA®

Sistemi Elettronici
di Apertura Porte e Cancelli
International registered trademark n. 804888

CE

ENGLISH

6. Insert the nuts and screw the 4 tie rods until the stop (Fig. 6).

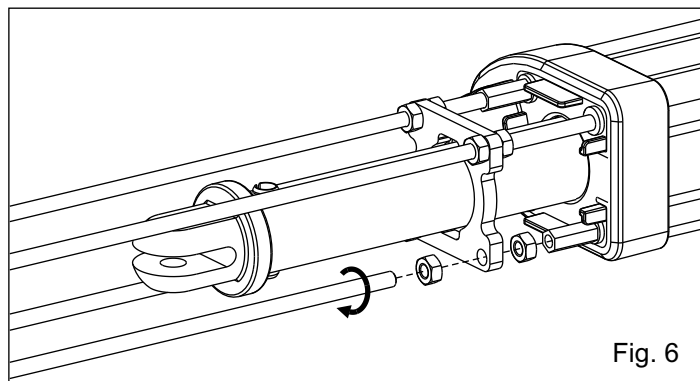

7. Insert the small pierced plate in the tie rods, after that screw 2 of the 4 previously removed nuts in correspondence with the 2 clamp screws of the stem cover (Fig. 7).

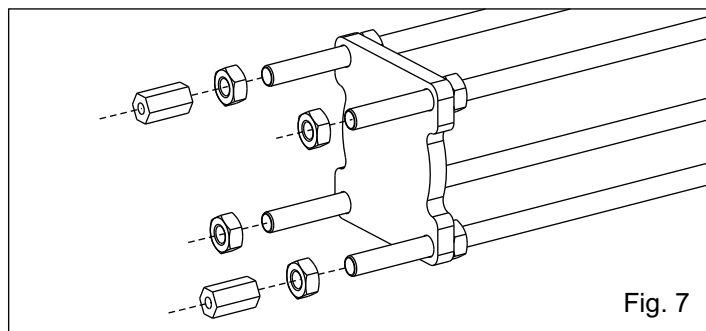

8. Adjust the mechanical stop according to one's needs using the appropriate nuts (Fig. 8).

Important note: the front fork must match completely the small plate 1 (Fig. 9-10),

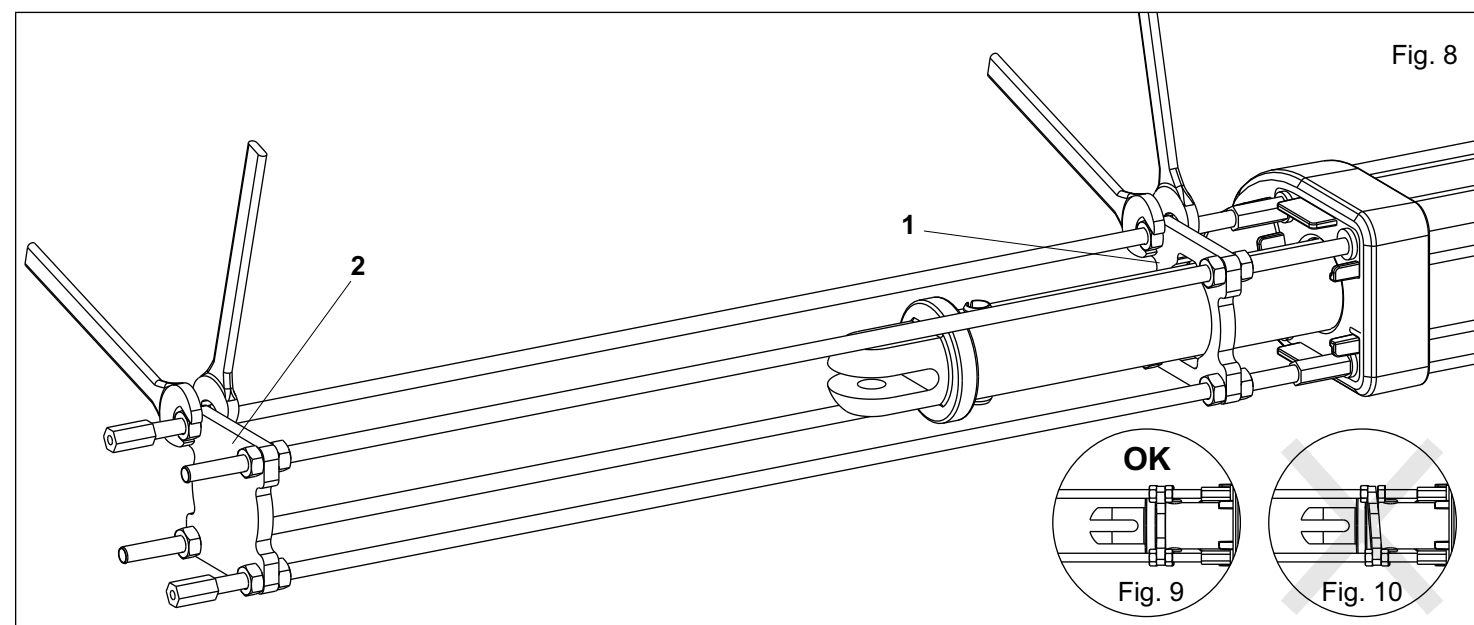

9. When you finish the adjustment, install the stem cover (Fig. 11).

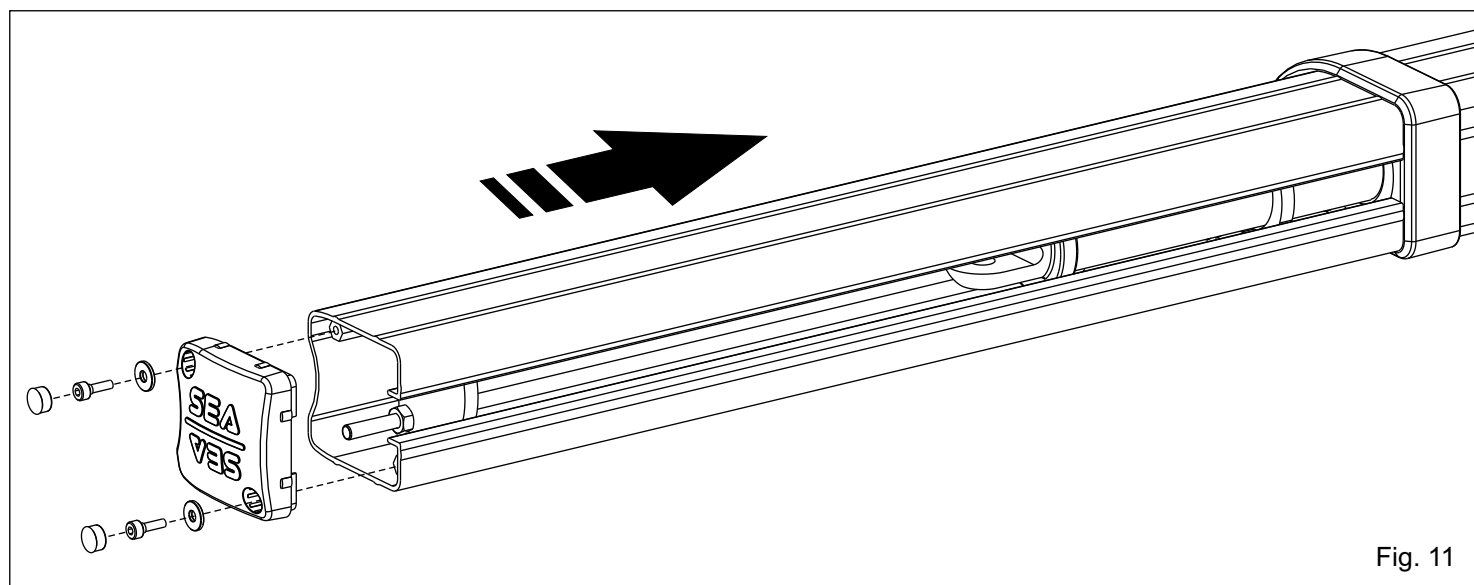

In order to get a better stop functionality, it's warmly suggested to install a control unit with slowdown in opening and closing.

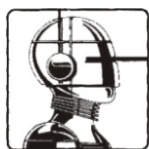

SEA®

Sistemi Elettronici
di Apertura Porte e Cancelli
International registered trademark n. 804888



FRANÇAIS

BUTÉE MECANIQUE REGLABLE POUR ALPHA

REMARQUE : Si la plaque percée, (A) est déjà montée, il faut suivre les instructions à partir du point 6, dans le cas contraire suivre les instructions d'assemblage à partir du point 1.

1. Dévisser les 2 dés hexagonaux qui se trouvent sur l'opérateur ALPHA d'environ. 3/5 mm ou seulement de l'essentiel pour insérer une pince à pointe pour bloquer le tirant intérieur, à ce point dévisser complètement les dés (Fig. 1).

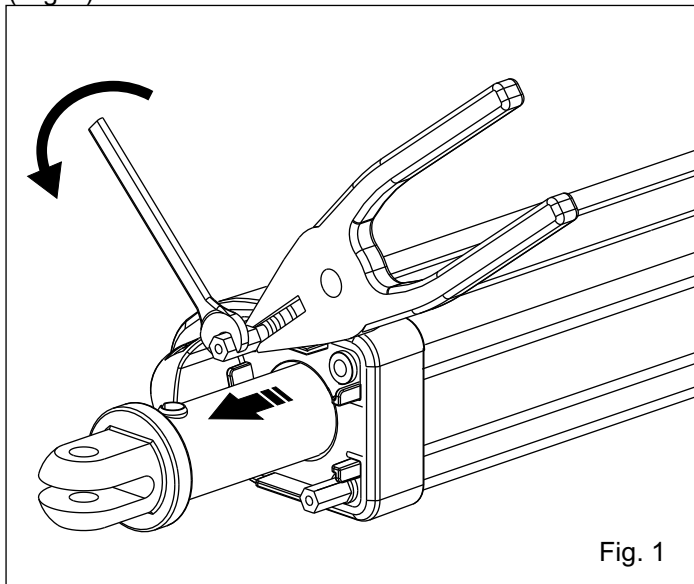

Fig. 1

2. Visser complètement les 2 dés hexagonaux fournis avec la butée mécanique (Fig. 2).

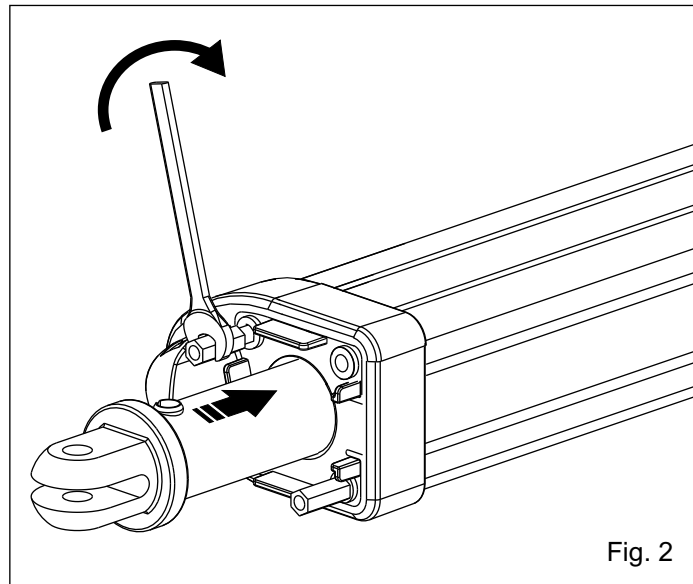

Fig. 2

3. Tourner en sens horaire la tige pour la faire sortir de 15 cm et extraire le pivot de serrage de la fourche antérieure en utilisant un extracteur de pivots de Ø 10 et un marteau (Fig. 3) **ATTENTION:** Vérifier que tout le travail soit effectué sur une surface très solide.

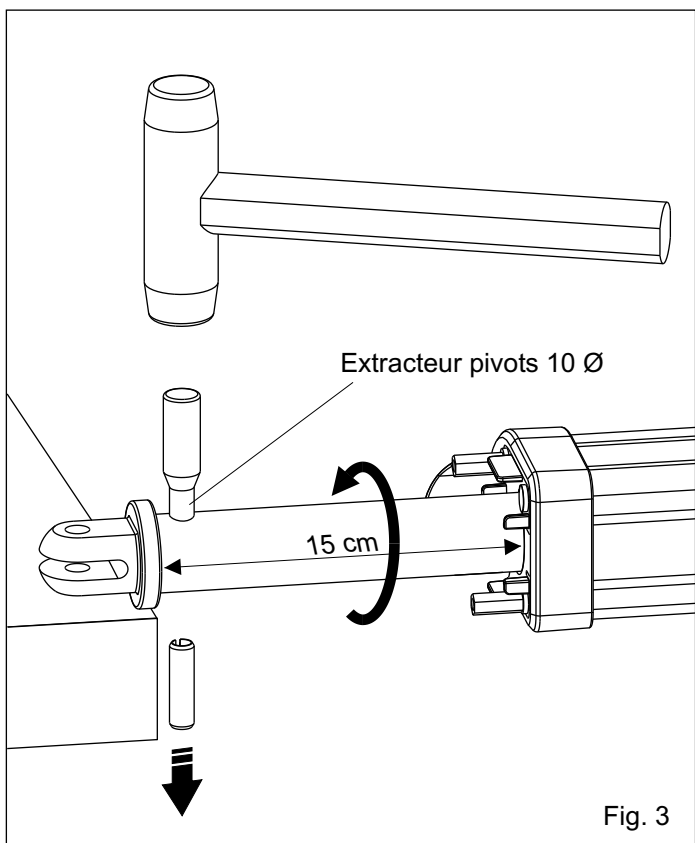

Fig. 3

4. Extraire la fourche antérieure et insérer la plaque percée dans la tige comme en Fig. 4.

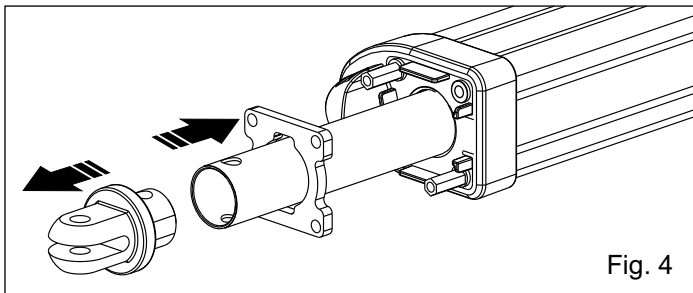

Fig. 4

5. Réinsérer la fourche antérieure dans la tige et la bloquer en insérant le pivot spécial (Fig 5). S'assurer que le pivot sort dans la même mesure des deux côtés.

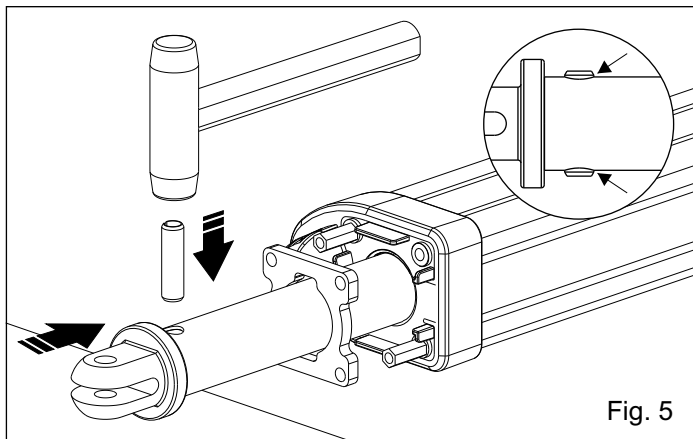
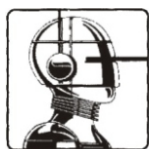

Fig. 5



SEA®

Sistemi Elettronici
di Apertura Porte e Cancelli
International registered trademark n. 804888



FRANÇAIS

6. Insérer les dés et visser les 4 tirants jusqu'à leur serrage (Fig 6)

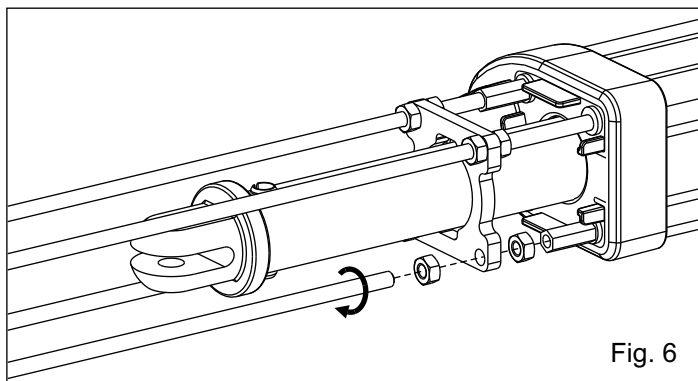

Fig. 6

7. Insérer la plaque percée dans les tirants, puis visser 2 des 4 dés précédemment enlevés correspondant aux 2 vis à borne du couvretige (Fig. 7).

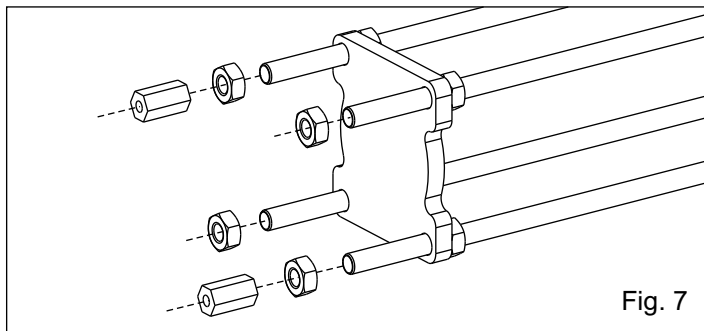

Fig. 7

8. Régler le stop mécanique selon les propres nécessités, en utilisant les dés spéciaux (Fig 8)

Remarque importante: La fourche antérieure doit parfaitement coïncider avec la plaque 1 (Fig. 9-10).

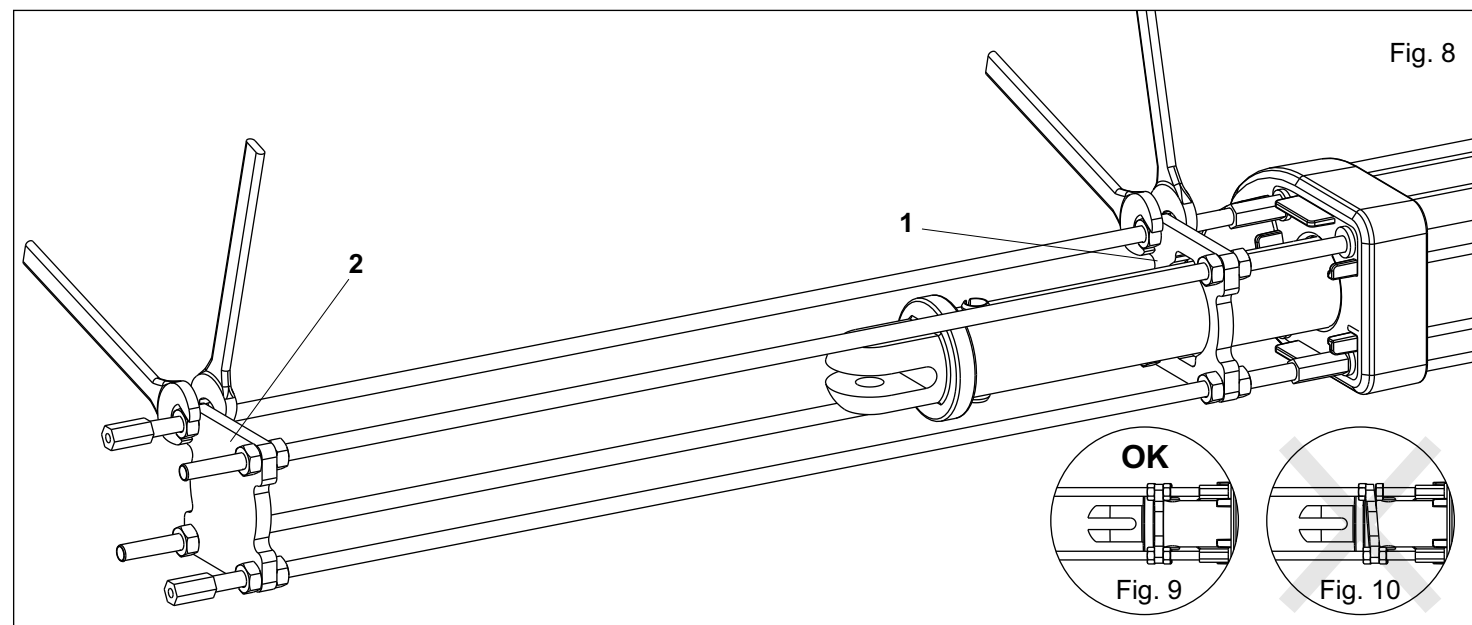

Fig. 8

9. Après avoir terminé le réglage, installer le couvretige (Fig 11).

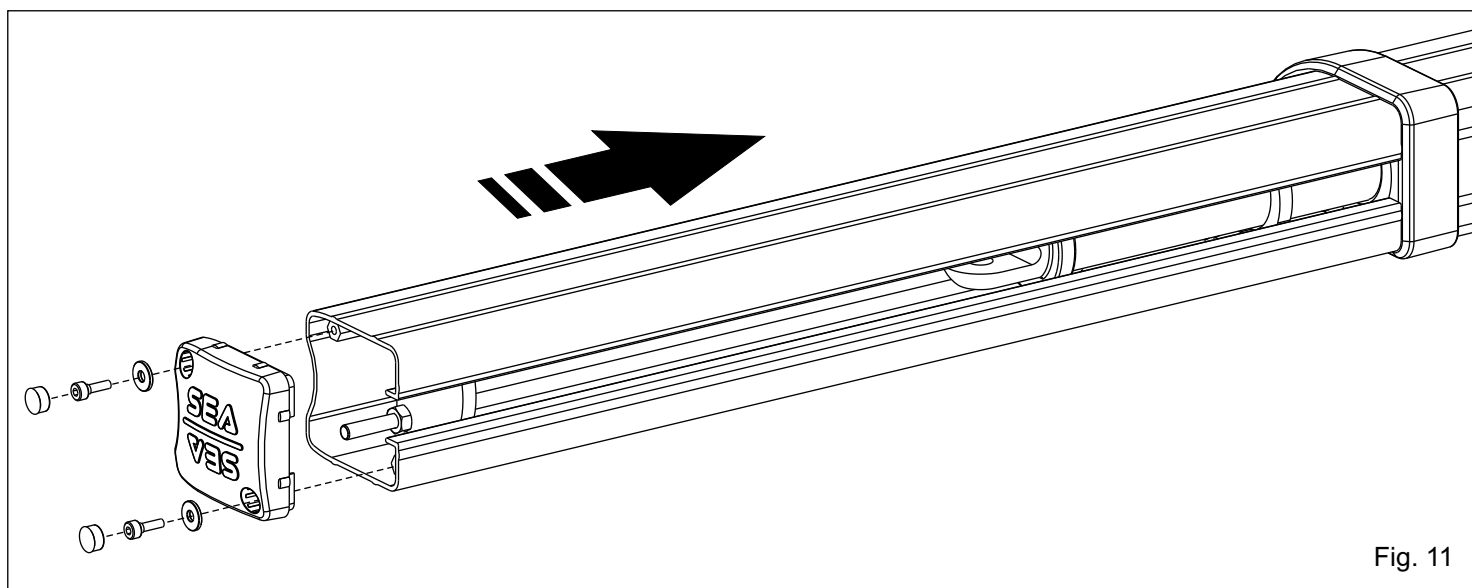
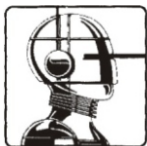

Fig. 11

Pour optimiser la fonction du stop, il est vivement recommandé d'installer une armoire électronique avec ralentissement en ouverture et fermeture.



SEA®

Sistemi Elettronici
di Apertura Porte e Cancelli
International registered trademark n. 804888

CE

ESPAÑOL

GOLPE MECÁNICO REGULABLE PARA ALPHA

Nota: si la placa perforada (A) ya está montada, seguir las instrucciones empezando por el punto 6, si no está montada seguir las instrucciones a partir del punto 1.

1. Destornillar los 2 dados hexagonales que se encuentran sobre el operador ALPHA de 3/5 mm o de lo mínimo indispensable para insertar una pinza de punta para bloquear el tirante interior, a ese punto destornillar completamente los dados (Fig. 1).

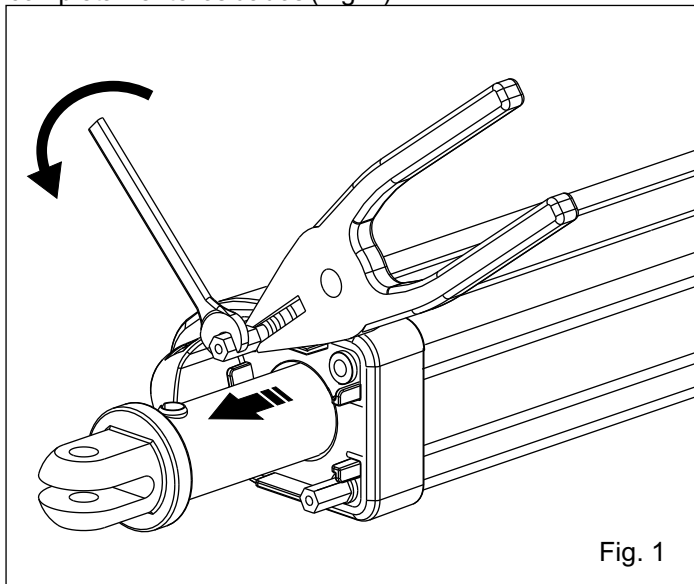

Fig. 1

2. Atornillar completamente los 2 dados hexagonales suministrados con el golpe mecánico (Fig. 2)

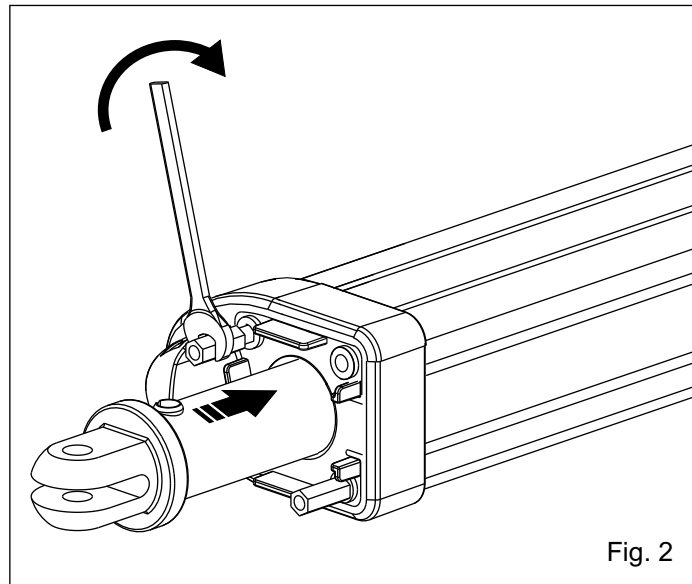

Fig. 2

3. Girar en sentido horario la barra para sacarla afuera de 15 cm; sacar la clavija de cerradura de la horquilla anterior utilizando un extractor de clavija de 10Ø y un martillo (Fig.3).

ADVERTENCIAS: asegurarse que todo el trabajo se efectue sobre una superficie sólida y segura.

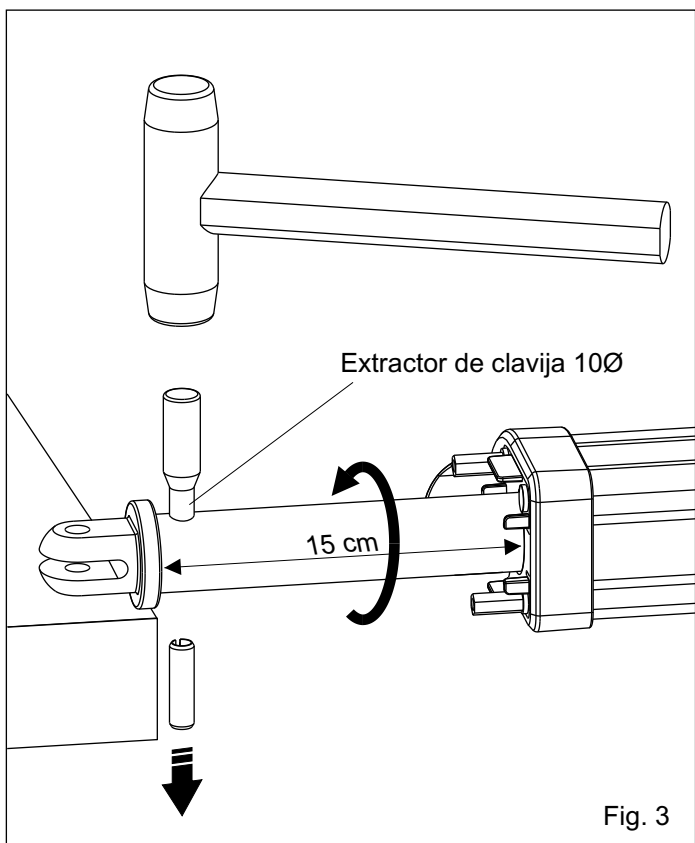

Fig. 3

4. Sacar la horquilla anterior e insertar la placa perforada en la barra como en Fig.4

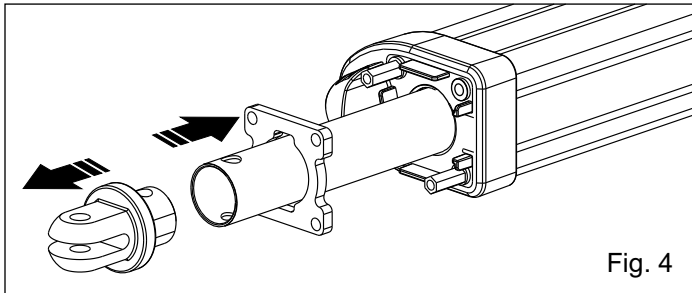

Fig. 4

5. Reinsertar la horquilla anterior en la barra y bloquearla insertando la clavija adecuada (Fig.5). Asegurarse que la clavija salga de ambos lados de la misma longitud.

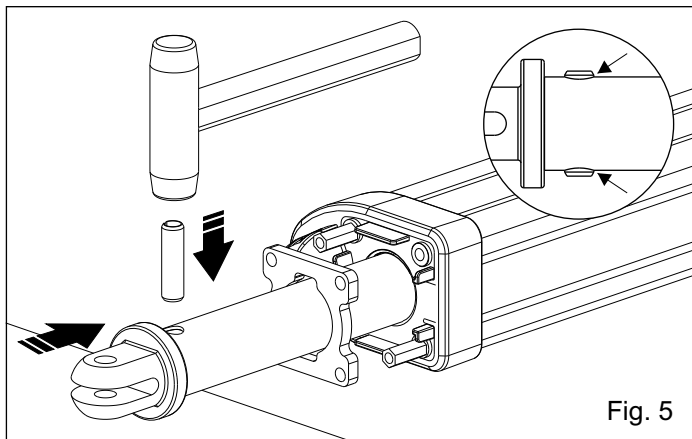
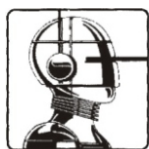

Fig. 5



SEA®

Sistemi Elettronici
di Apertura Porte e Cancelli
International registered trademark n. 804888



ESPAÑOL

6. Insertar los dados y atornillar los 4 tirantes hasta el apretamiento (Fig.6)

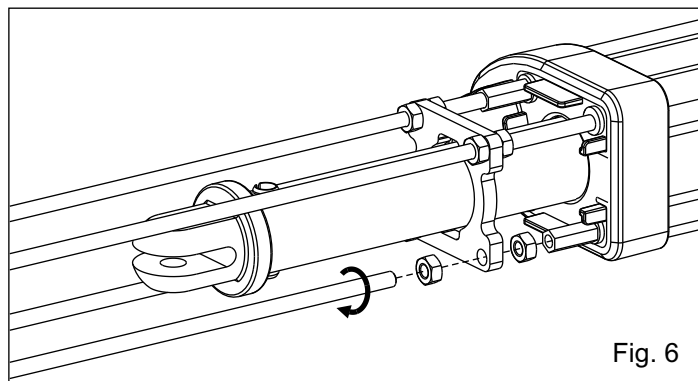

Fig. 6

7. Insertar la placa perforada en los tirantes, luego atornillar 2 de los 4 dados anteriormente removidos en correspondencia de los 2 tornillos de mordaza del

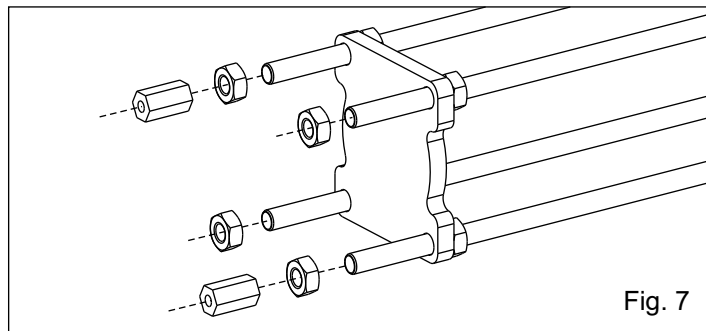

Fig. 7

8. Ajustar el golpe mecánico según sus necesidades, utilizando los dados adecuados (Fig.8)

NOTA IMPORTANTE: la horquilla anterior tiene que coincidir perfectamente con la placa 1 (Fig. 9-10)

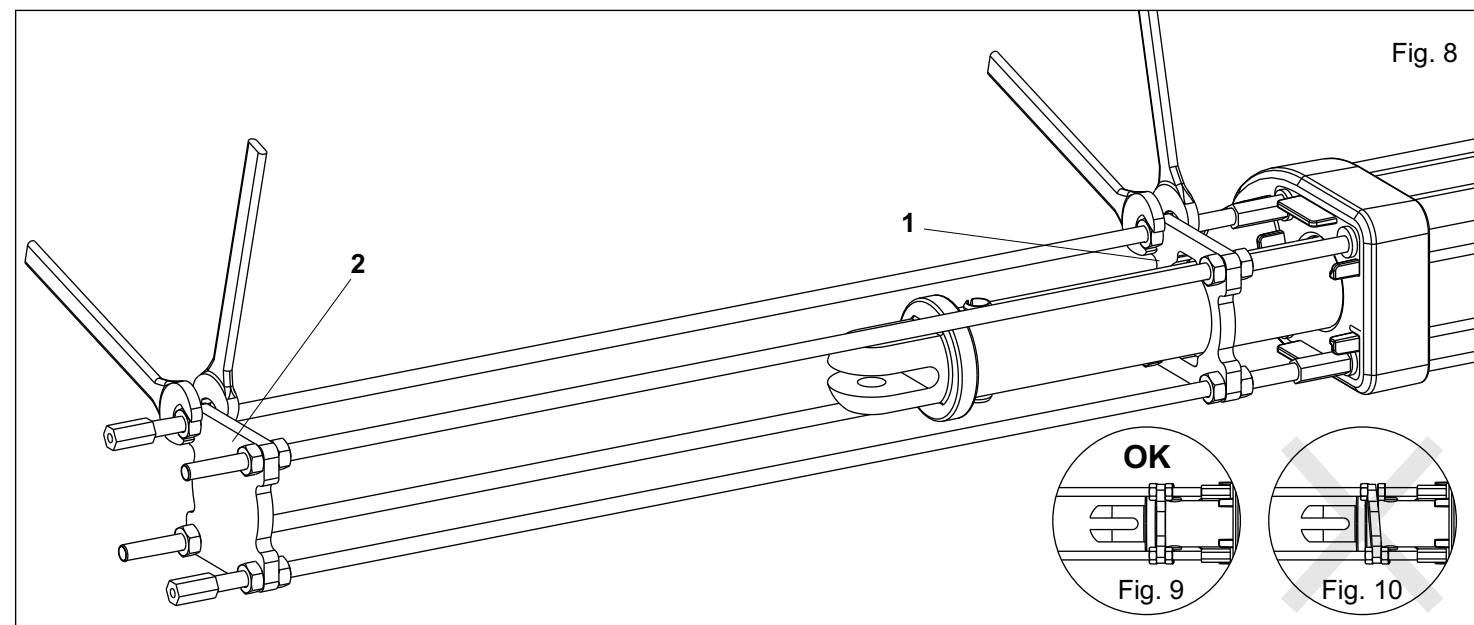

Fig. 8

9. Después de haber terminado las regulaciones, instalar el cubrebarra (Fig. 11)

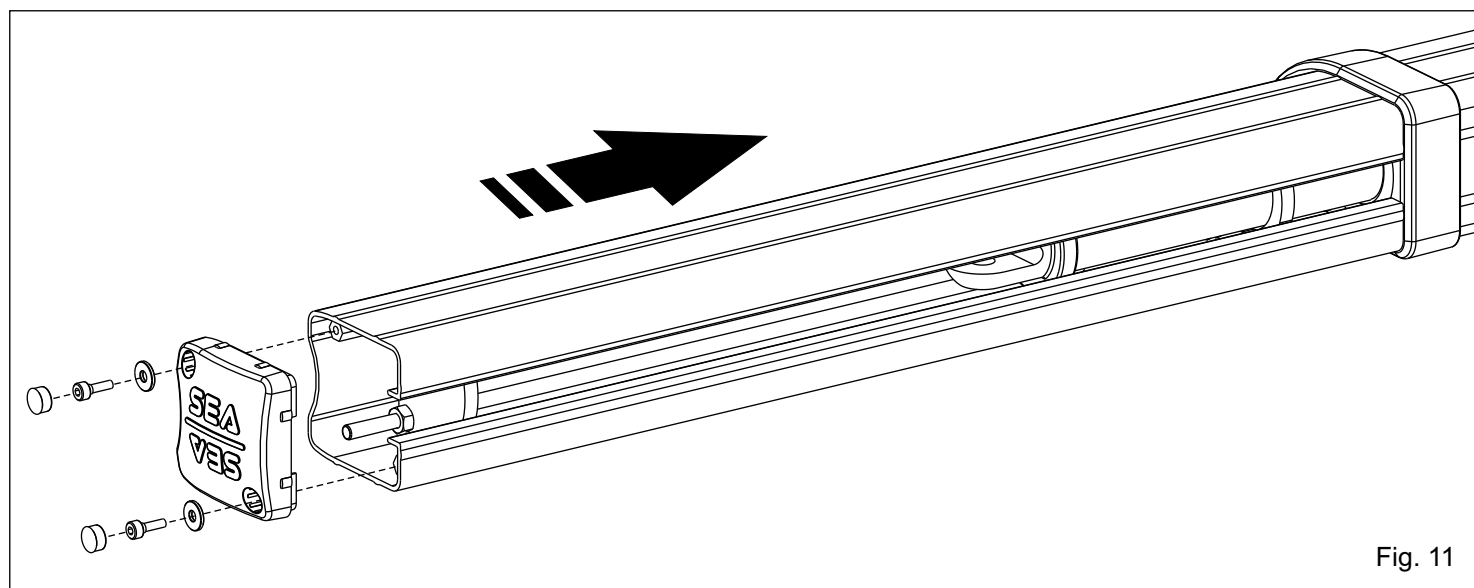
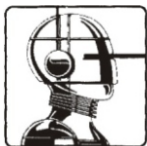

Fig. 11

Para optimizar la función de STOP, se recomienda instalar una tarjeta electrónica con deceleración en apertura y cierre.



SEA®

Sistemi Elettronici
di Apertura Porte e Cancelli
International registered trademark n. 804888

CE

DEUTSCH

EINSTELLBARER MECHANISCHER ANSCHLAG FÜR ALPHA

Hinweis: Wenn die gelochte Platte (A) bereits montiert wurde, folgen Sie den Anweisungen ab Punkt 6, andernfalls folgen sie den Montageanweisungen, ab Punkt 1.

1. Schrauben Sie die 2 sechseckigen Muttern auf dem ALPHA-Antrieb ungefähr 3/5 mm auf oder nur soweit, dass es möglich ist eine spitze Zange einzuführen, um die Innenstange zu blockieren, danach die Muttern vollständig abschrauben (Abb. 1).



Abb. 1

2. Schrauben Sie die 2 mitgelieferten, sechseckigen Muttern, vollständig ab (Abb. 2).

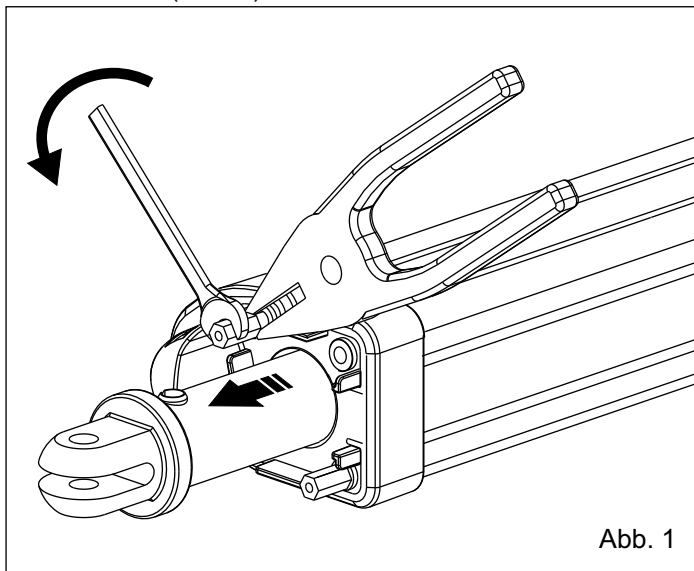

Abb. 2

3. Den Schaft im Uhrzeigersinn drehen, um 15 cm herausziehen und den Verriegelungsstift (10cm Ø) der Frontgabel herausziehen, dazu einen Stiftentferner und einen Hammer benutzen (Abb. 3).

ACHTUNG: Alles auf einer festen Oberfläche durchzuführen

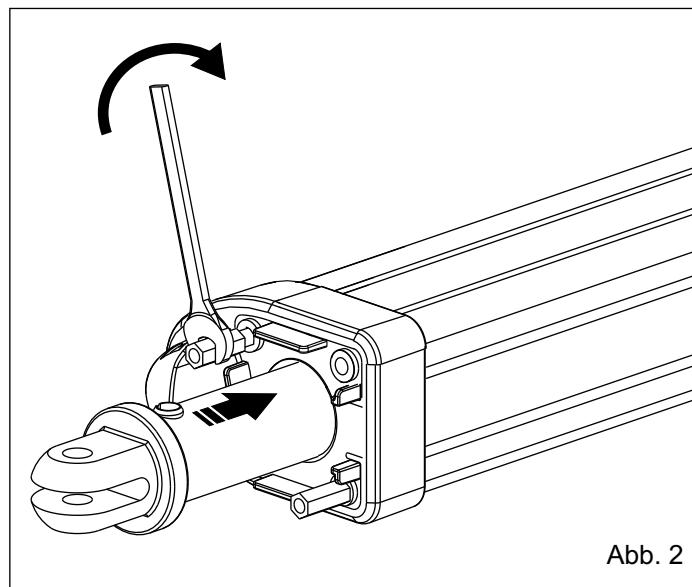

Abb. 3

4. Die Frontgabel herausziehen und die gelochte Platte in den Schaft wie in Abb. 4 einführen.

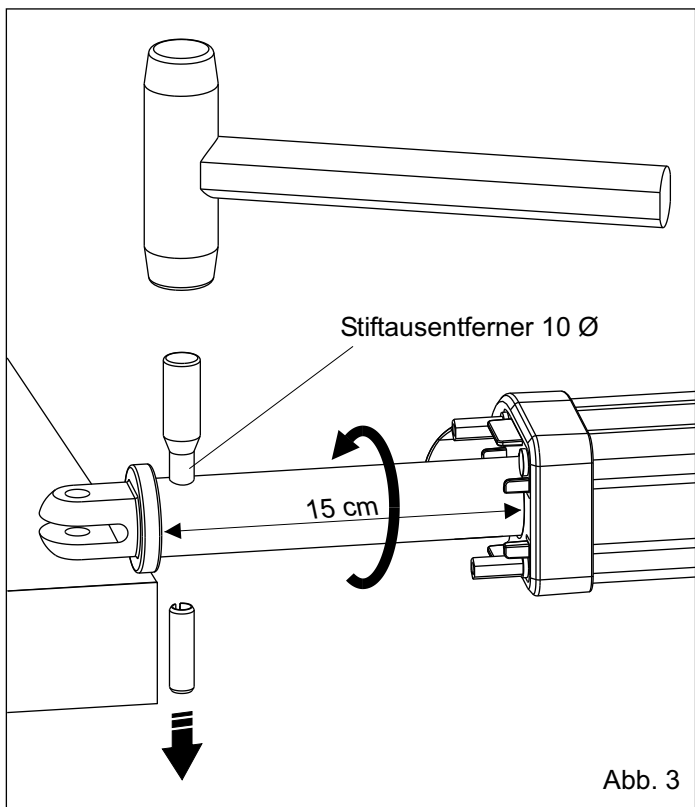
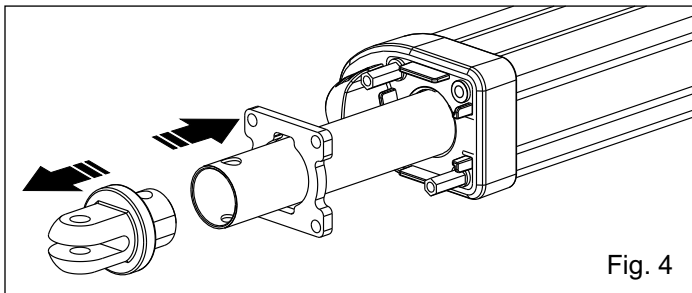

Fig. 4

5. Die Frontgabel wieder in den Schaft einführen und mit dem dazu vorgesehenen Stift blockieren (Abb. 5) Sicherstellen, dass der Stift gleichermassen aus beiden Seiten herauschaut.



Abb. 5



SEA®

Sistemi Elettronici
di Apertura Porte e Cancelli
International registered trademark n. 804888

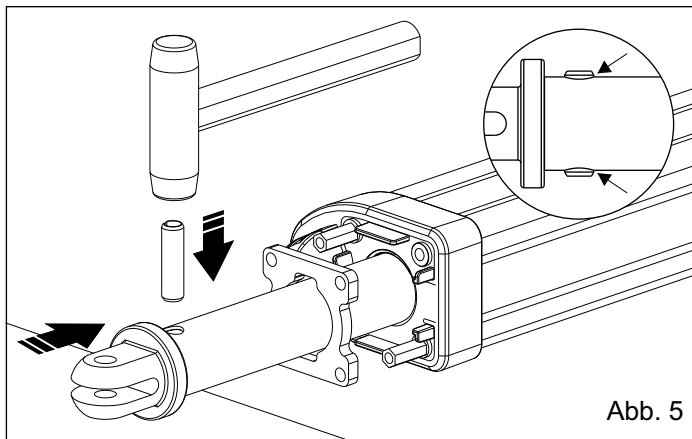
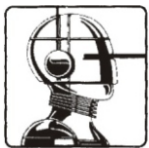
CE

DEUTSCH

6. Die Muttern einführen und die 4 Stangen bis zum Anschlag festschrauben (Fig.6)



Abb. 6

7. Die gelochte Platte in die Stangen einführen, danach 2 von den 4 zuvor entfernten Muttern in Übereinstimmung mit den 2 Klammerschrauben der Kolbenabdeckung festschrauben (Abb. 7).

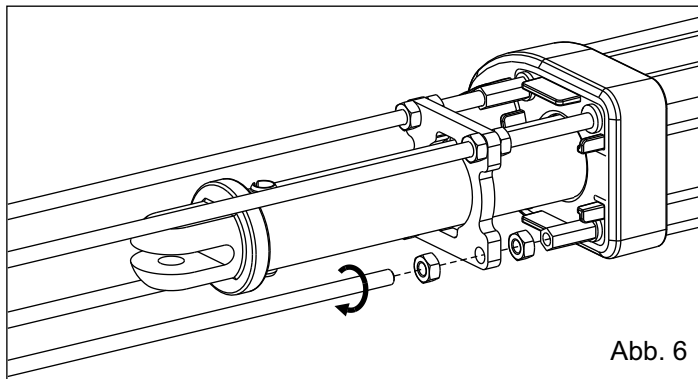

Abb. 7

8. Den mechanischen Anschlag mit den dafür vorgesehenen Muttern entsprechend ihrer Bedürfnisse einstellen, (Abb. 8).

Achtung: Die Frontgabel muß genau mit der kleinen Platte 1 (Abb. 9-10) übereinstimmen.

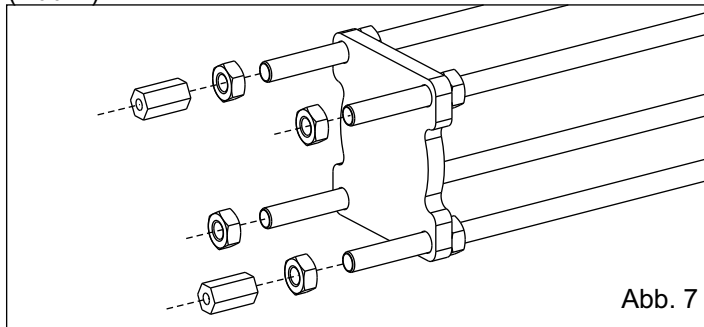

Abb. 8

9. Nach Beendigung der Einstellung die Kolbenabdeckung wieder montieren (Abb. 11).

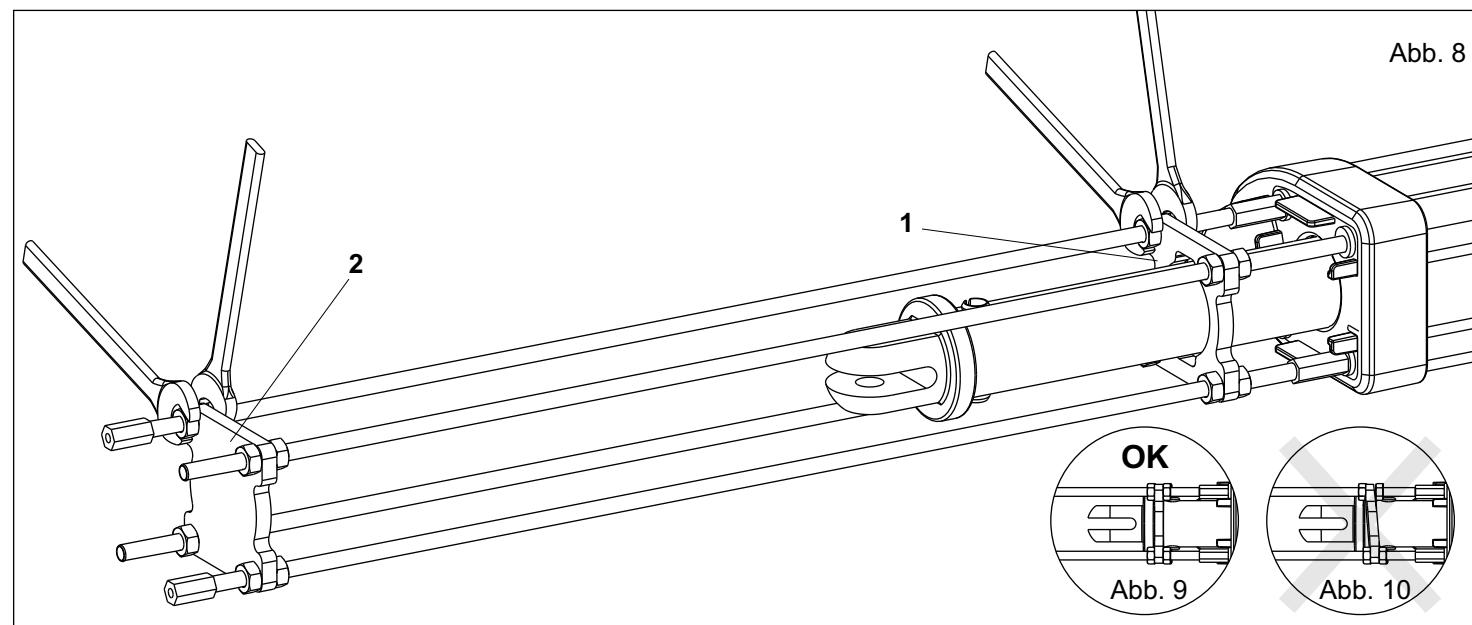

Abb. 11

Um eine bessere Stoppfunktion zu erhalten, wird empfohlen eine Steuerung mit Verzögerung in Öffnung und Schliessung zu installieren.



SEA[®]
Sistemi Elettronici
di Apertura Porte e Cancelli
International registered trademark n. 804888

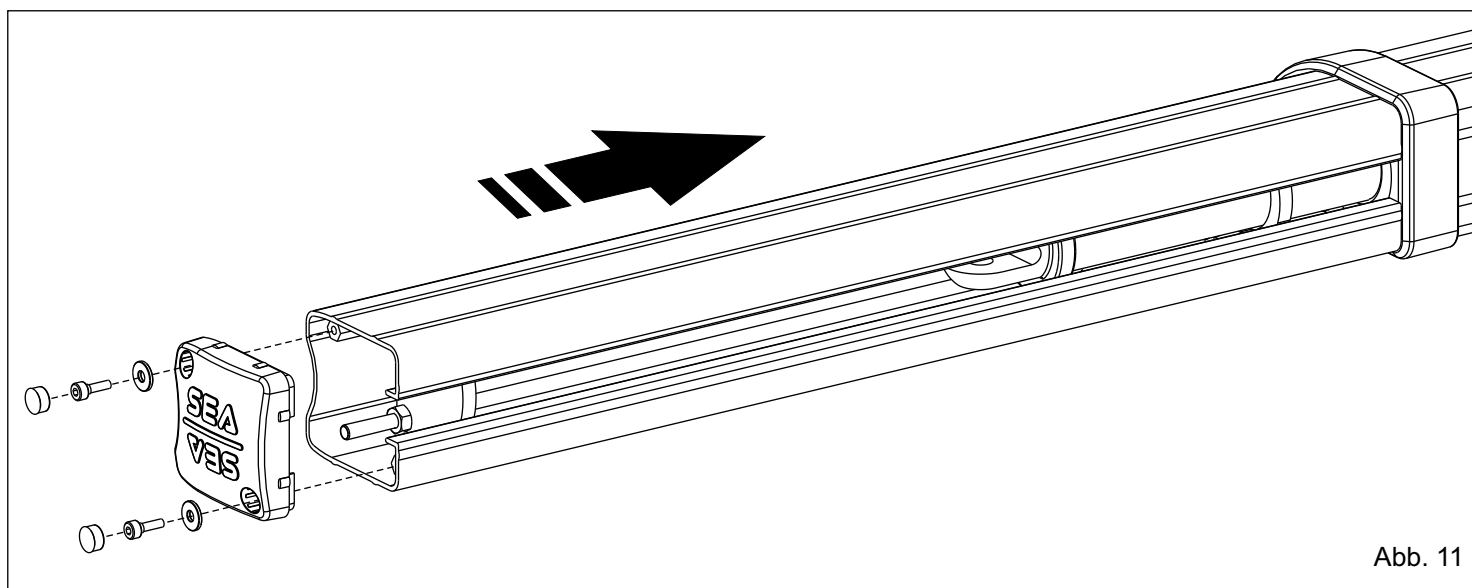
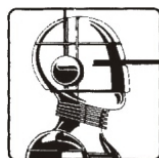

SEA S.r.l.
Zona industriale 64020 S.ATTO Teramo (ITALY)
Tel. 0861 588341 r.a. Fax 0861 588344

seacom@seateam.com

www.seateam.com