



SEA
Sistemi elettronici
di Aperture Porte e Cancelli



ARM

FITTING AND CONNECTION INSTRUCTIONS



ENGLISH

ARM is an electromechanical not reversible operator with articulated arm and grease lubrication for residential use on big pilasters and leafs with a max. weight of 180kg and 1,8m length.
24V low voltage power supply for a high safety of use.
Inversion in case of obstacle.
With articulated steel arm with adjustable mechanical stop in opening.

DIMENSIONS (mm)

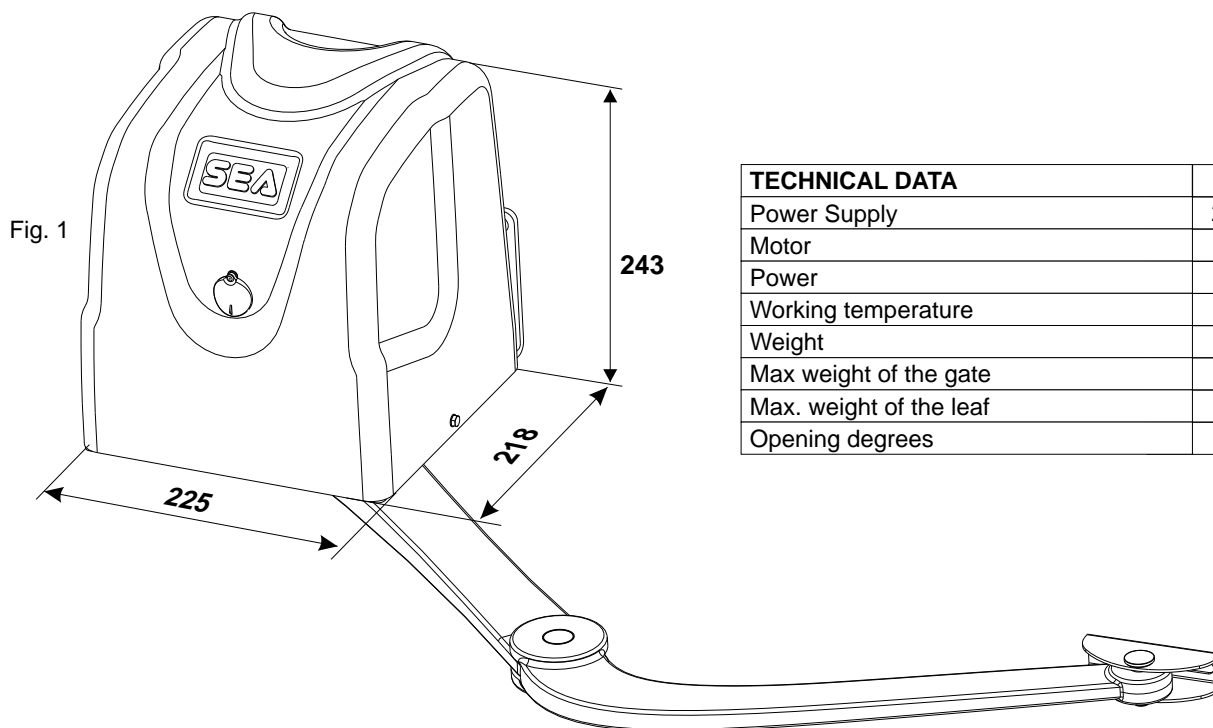

STANDARD INSTALLATION

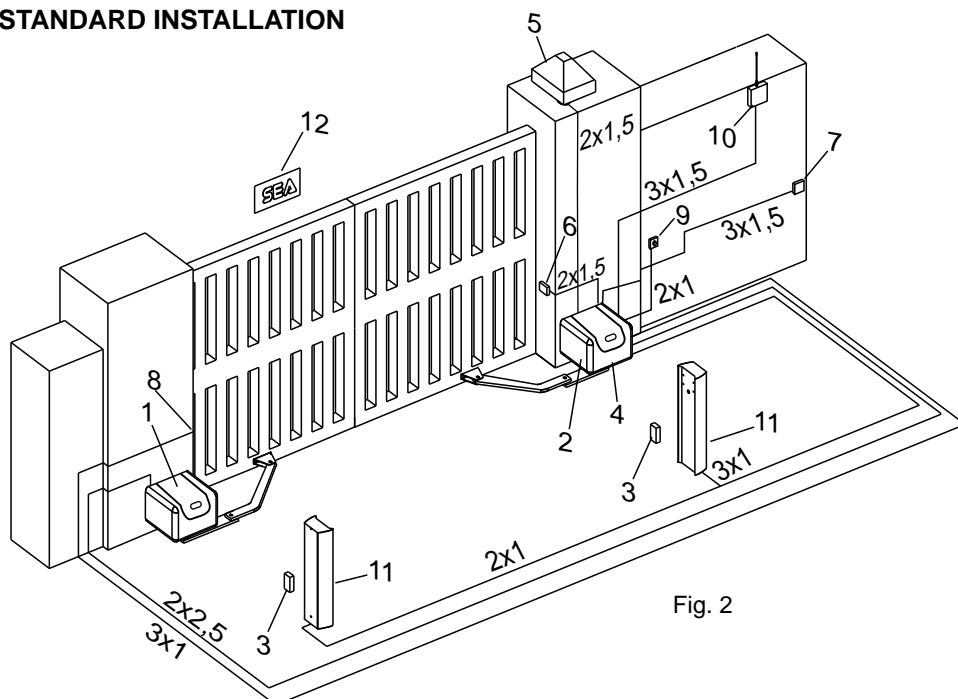

- 1 - Operator 1
- 2 - Operator 2
- 3 - Stop in opening
- 4 - Electronic unit included
- 5 - Flashing lamp
- 6 - Rx photocell
- 7 - Differential switch 16a-0,03a
- 8 - Tx photocell
- 9 - Key switch (on request)
- 10 - Radio receiver + antenna
- 11 - Column for photocell
- 12 - Warning plate

1. GATE ARRANGEMENT

It is necessary to make controls on the gate to make sure the application of ARM automation can be possible.

Make sure that:

- A.** the gate fixed and moving parts have a strong and crush-proof structure;
- B.** the length of each leaf is not over 1,8 meters;
- C.** the weight of each leaf is not over 180 Kg;
- D.** the hinges are hardly anchored and are able to support the torque of the operator; they do not have irregular movements and/or any friction during the whole movement of the leaf;

The ARM operator comes with limit switch stop in opening, nevertheless it is recommended to install mechanical limit switch stops to be fixed on the ground in closing and opening (Fig. 3).

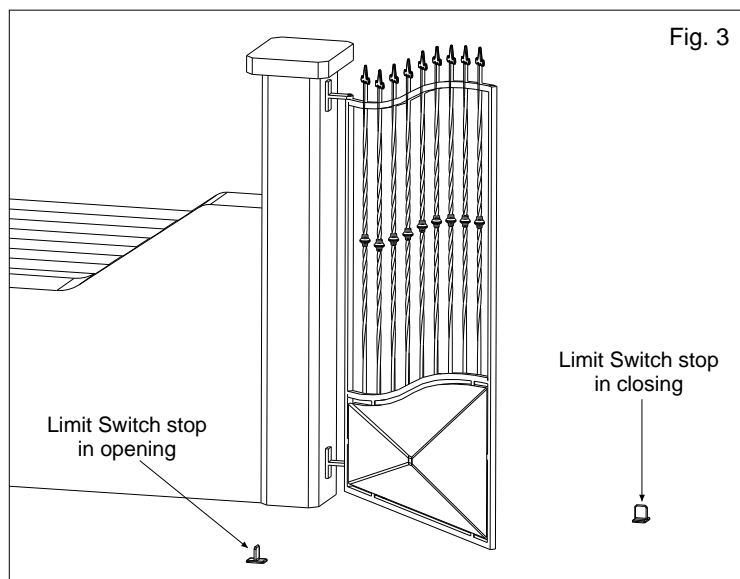

DIMENSIONS FOR THE INSTALLATION

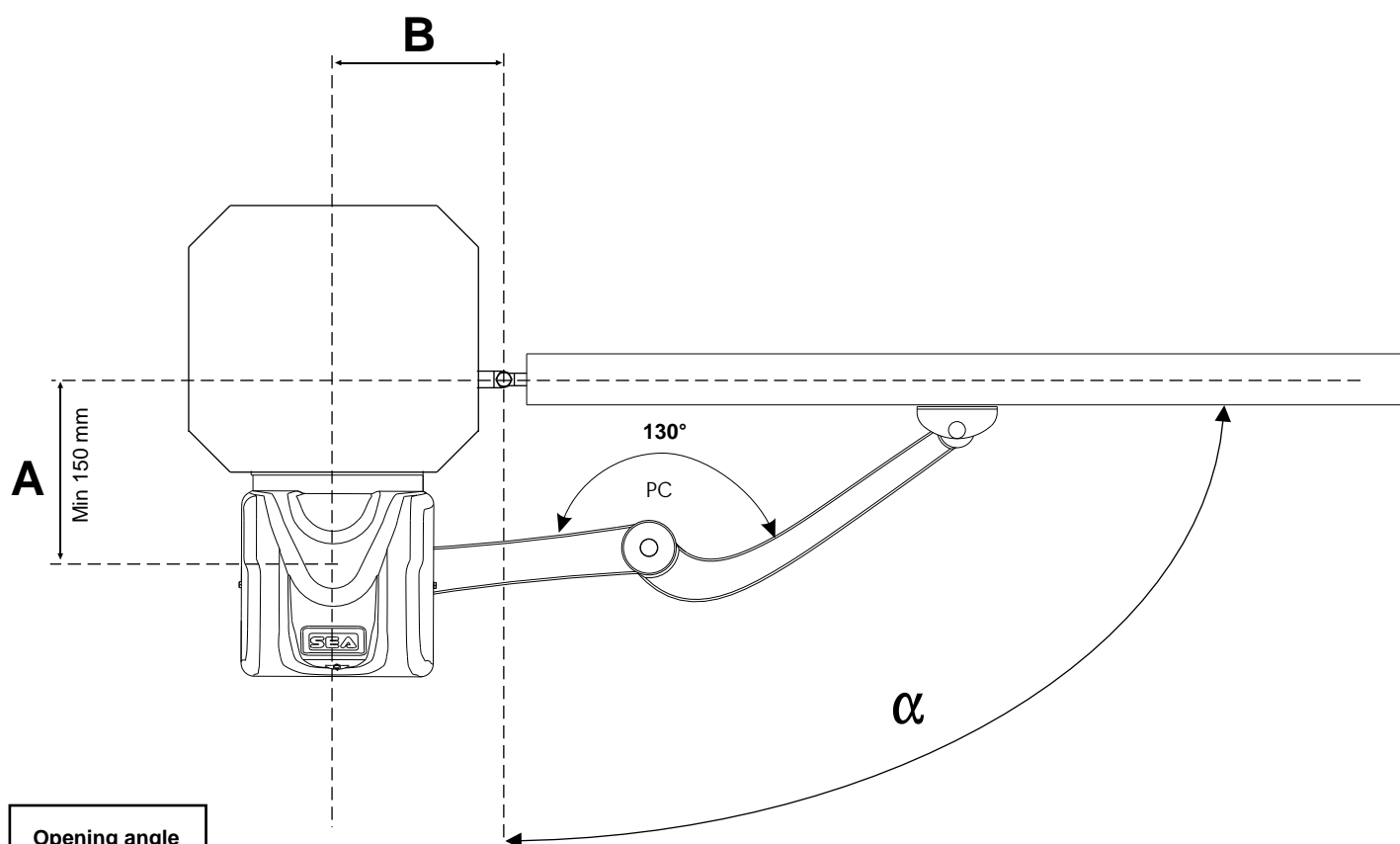

Opening angle α				
90°	A	150	200	250
	B	200	150	150
110°	A	150	200	
	B	200	220	

PC: Point of central rotation

Fig. 4

MOUNTING PLATE ATTACHMENT AND MOUNTING OF THE MOTOR

- Attach the mounting plate to the pilaster with 4 screws and 4 washers (Fig. 5). Make sure that the plate is positioned perfectly levelled.
- Mount the motor on the plate using the 3 furnished screws and successively mount the carter, fixing it laterally with the 2 furnished screws (Fig. 6)

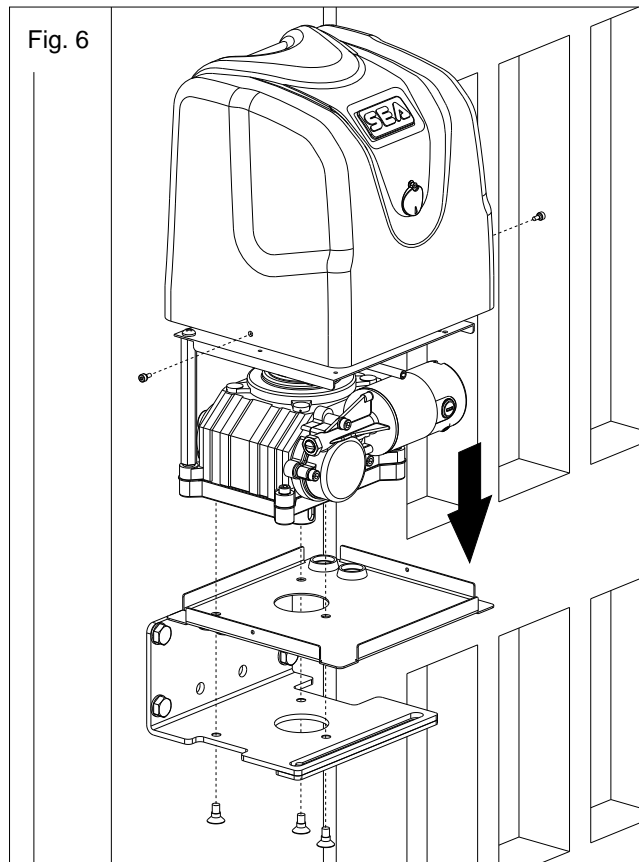
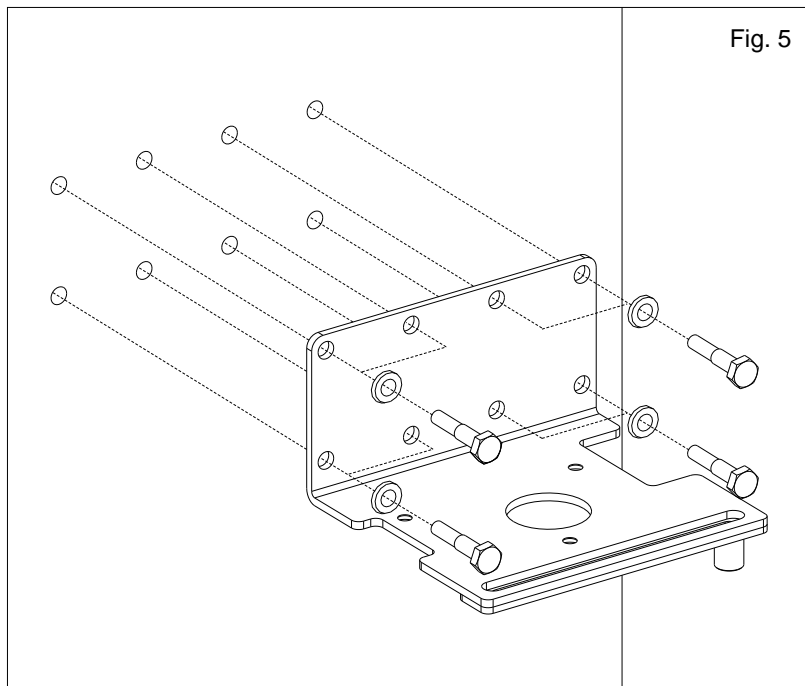

ASSEMBLING OF THE ARTICULATED ARM

- The two articulated arms must be assembled differently, distinguishing the right arm from the left one. See Fig. 7 and 8.

Note: Before inserting the pivots lubricate them with water repellent grease

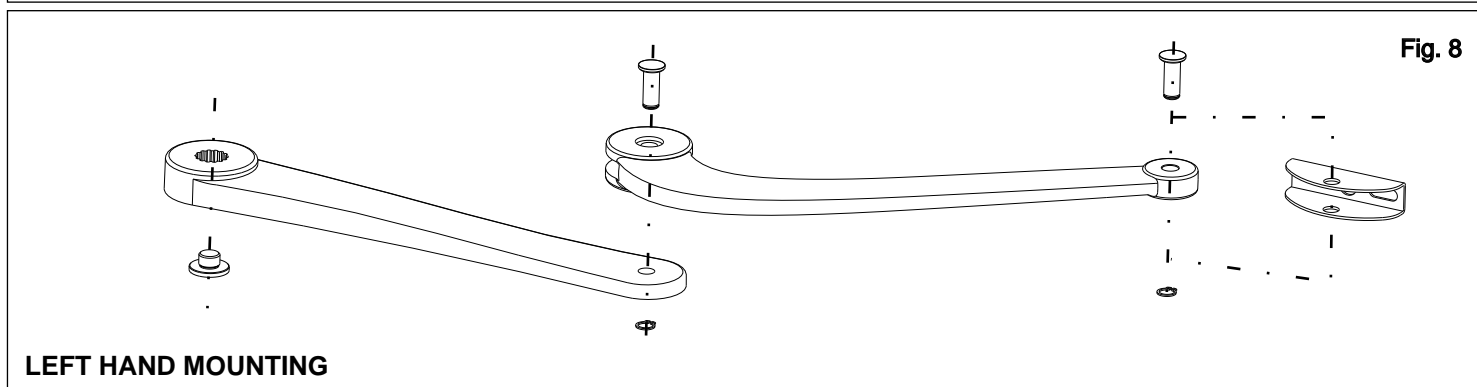
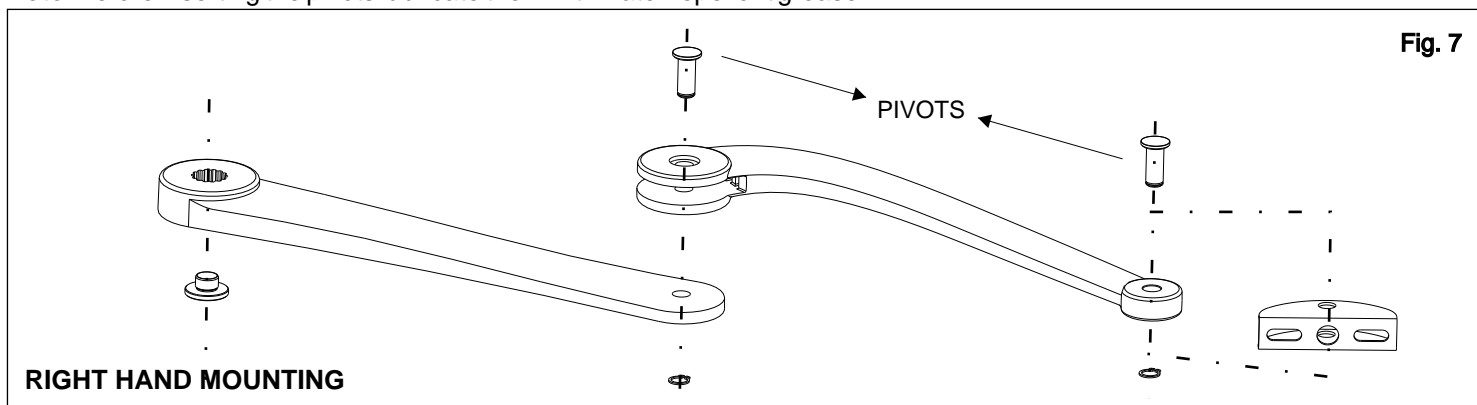



SEA
Sistemi elettronici
di Aperture Porte e Cancelli



ARM

FITTING AND CONNECTION INSTRUCTIONS



ATTACHMENT OF THE ARTICULATED ARM TO THE MOTOR

- Fit the articulated arm into the motor shaft and lock it with the special screws (Fig. 9).

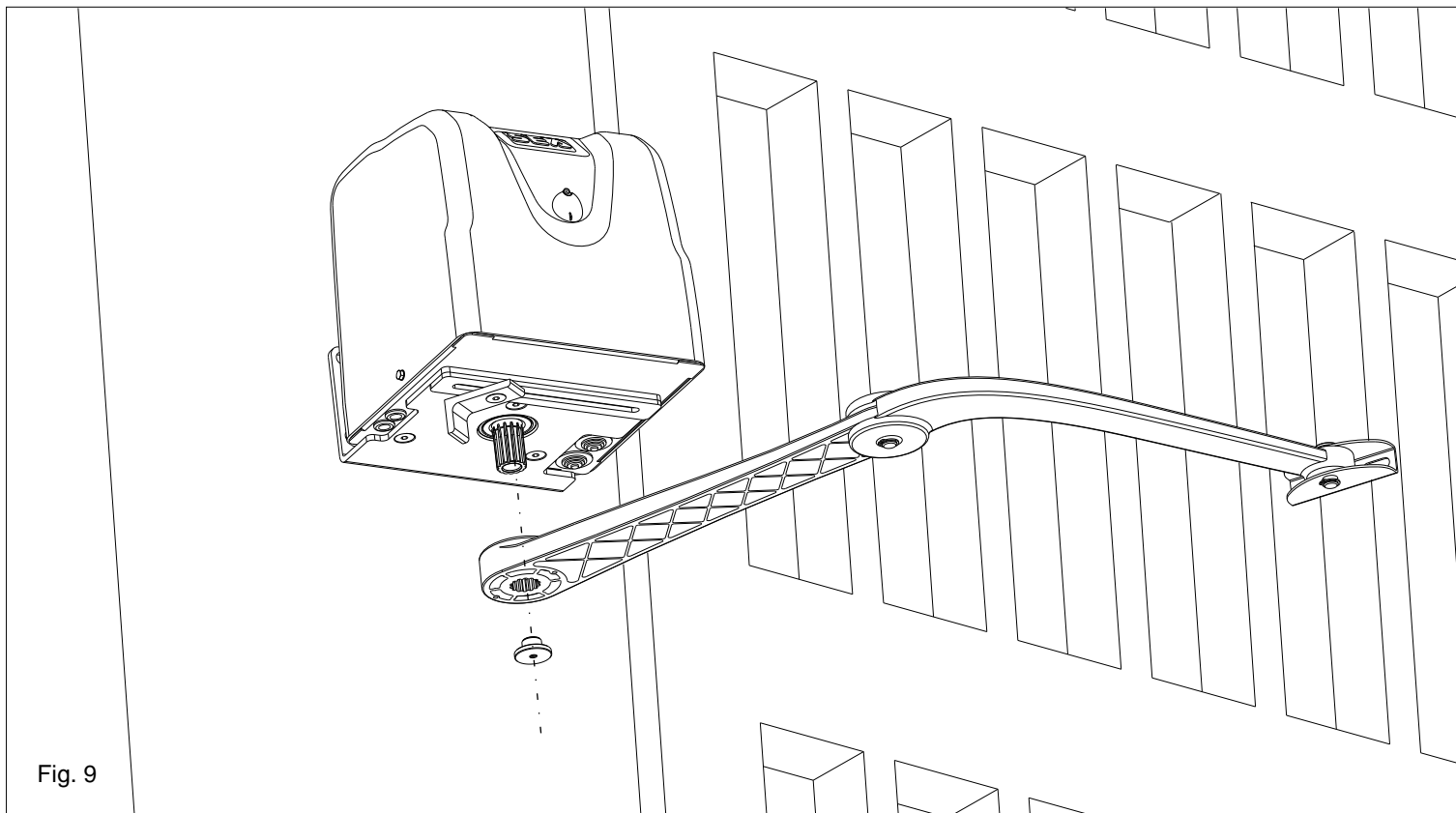

Fig. 9

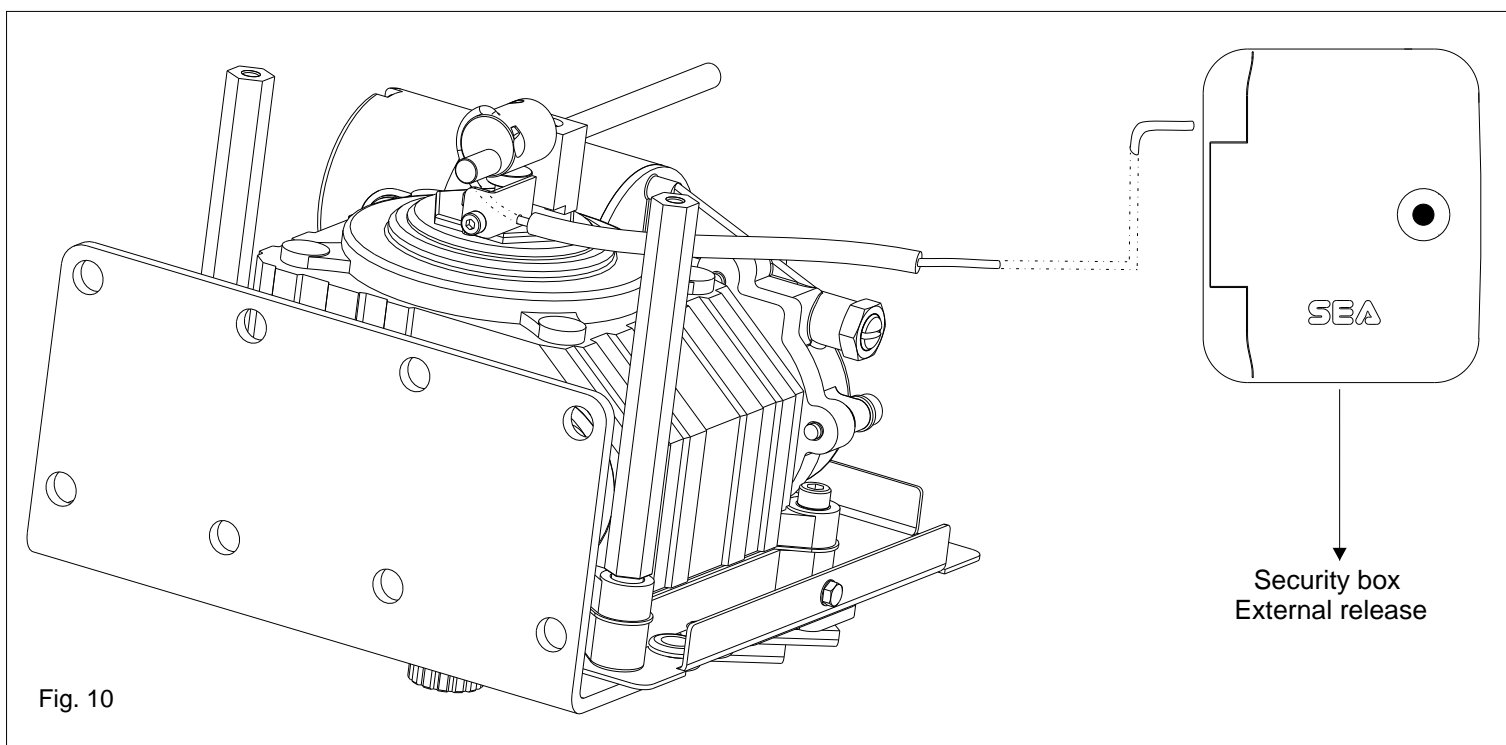

Fig. 10

Optional external release



FIXING OF THE FRONT BRACKET

- Close the leaf completely
- Release the motor (see next paragraph)
- Extend the articulated arm as in Fig. 4, lean the adjustable front bracket on the gate and make two marks on the centre of the two buttonholes (Fig. 11)
- Perforate the leaf and attach the front bracket with the screws (Fig. 12)
- Before tightening the screws move the front bracket to the right or to the left for a good positioning of the arm on the gate (Fig. 13)

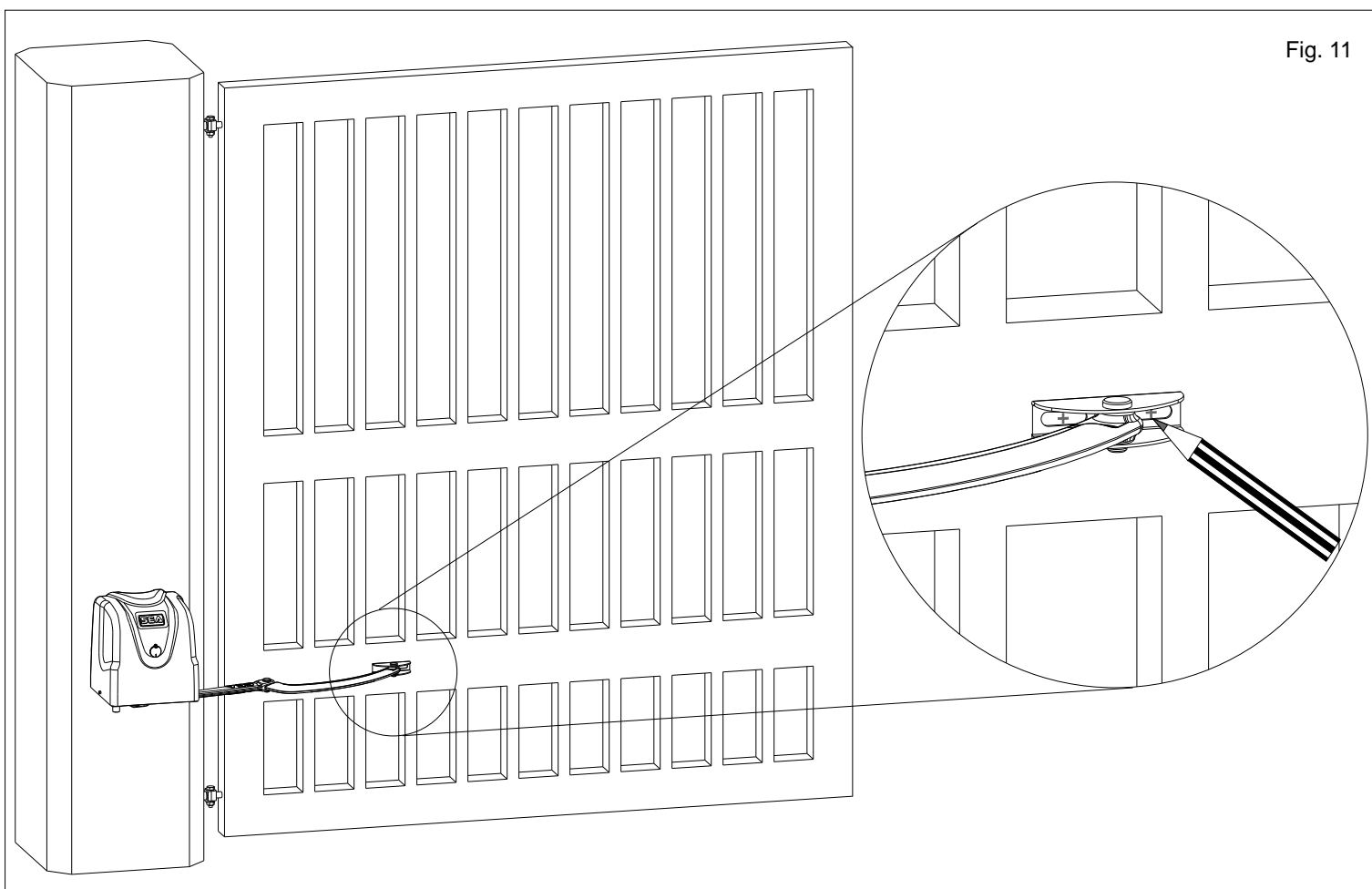

Fig. 11

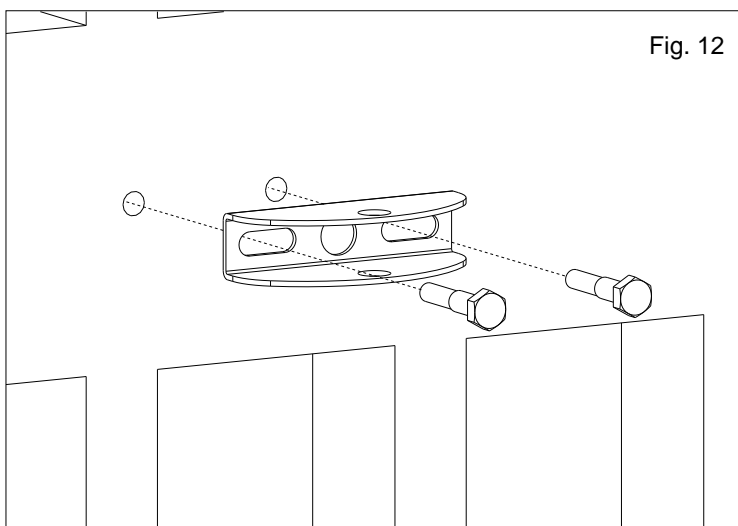

Fig. 12

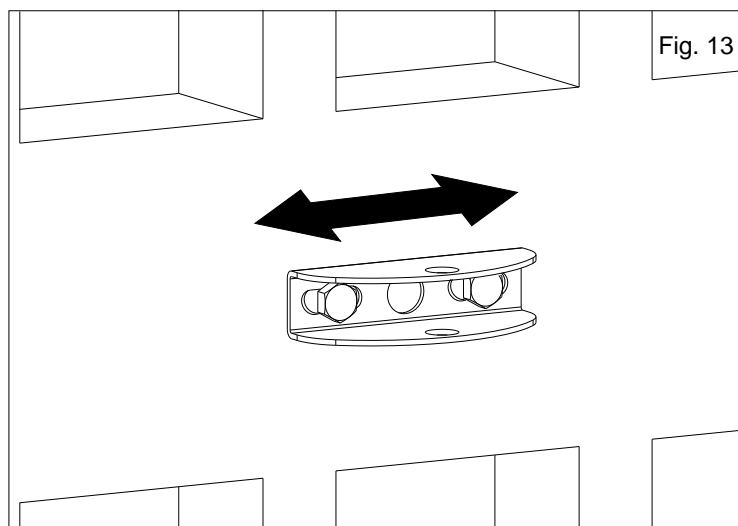

Fig. 13



SEA
Sistemi elettronici
di Aperture Porte e Cancelli



ARM

FITTING AND CONNECTION INSTRUCTIONS

CE

ENGLISH

RELEASE SYSTEM

To release operate as follows:

- Turn the release door and insert the furnished hexagonal T-key into the special hole (Fig. 14)
- Turn the release key about 180° clockwise (Fig. 15).
- Extract the key and close the door
- Open manually the leaf

To block again operate as follows:

- Insert the hexagonal key and turn it about 180° anticlockwise
- Move the leaf manually to allow the re-coupling of the gear before using in automatic.
- Extract the key and close the door

Fig. 14



Fig. 15

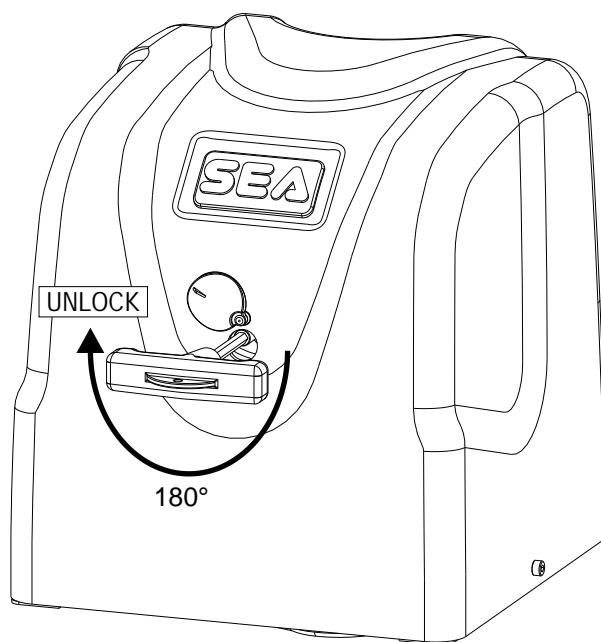



MECHANICAL POSITIVE STOP ADJUSTMENT IN OPENING

- Release the motor
- Bring the leaf in complete opening or to the desired opening point.
- Put the stop bracket S on the stop with the articulated arm and lock the screw 1 (left-hand side motor Fig. 16, right-hand side Fig. 17).

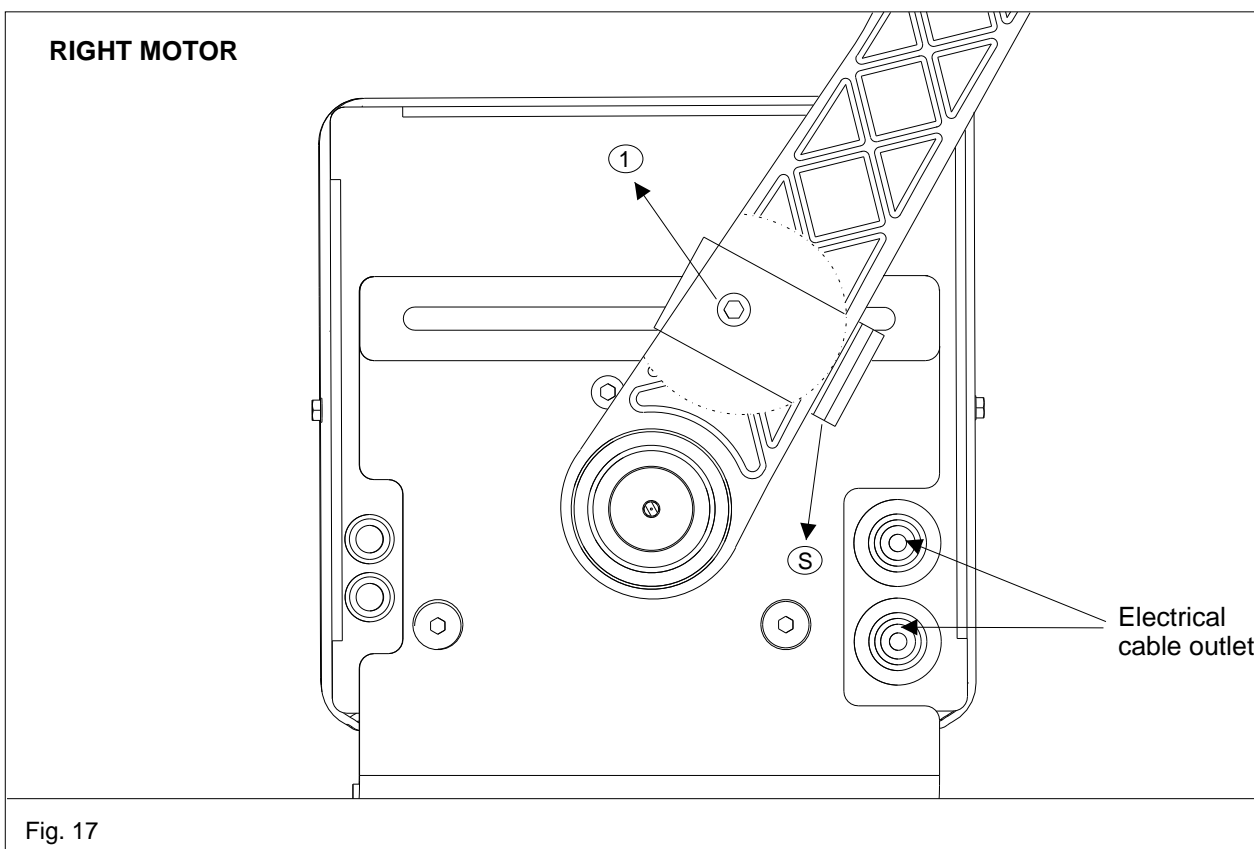
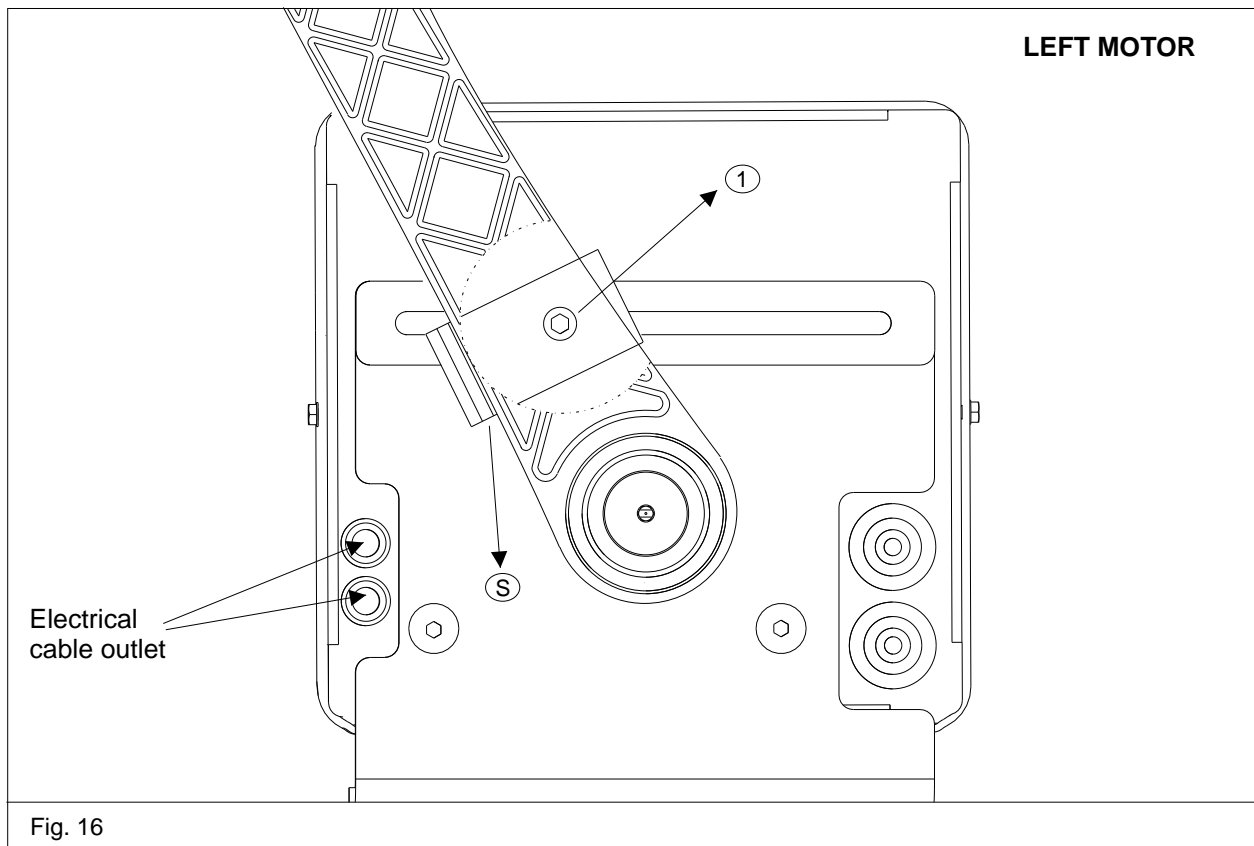



SEA
Sistemi elettronici
di Aperture Porte e Cancelli



ARM

FITTING AND CONNECTION INSTRUCTIONS

CE

ENGLISH

RISK EXAMINATION

The points pointed by arrows in Fig. 18 are potentially dangerous.

The installer must take a close risk examination to prevent crushing, conveying, cutting, grappling, trapping so to guarantee a safe installation for people, things and animals

(Re. Laws in force in the country where the installation has been made).

Fig. 18

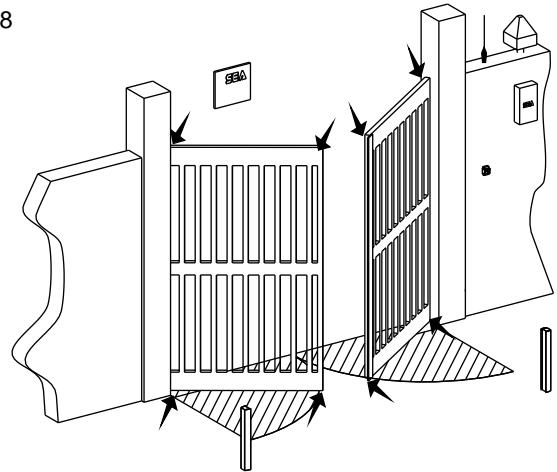

DECLARATION OF CONFORMITY

SEA declares under its responsibility that the products

ARM

meets the essential requisites provided for by the following European Directive and following changes:

89/392/CEE (Machine Directive)

89/336/CEE (Electromagnetic Compatibility Directive)

73/23/CEE (Low Tension Directive)

SAFETY PRECAUTIONS:

All electrical work should conform to current regulations. A 16 A 0,030 A differential switch must be incorporated into the source of the operators main electrical supply and the entire system properly earth bonded. Always run mains carrying cables in separate ducts to low voltage control cables to prevent mains interference.

INTENDED USE:

ARM operator has been designed to be used only for the automation of swing gates.

SPARE PARTS:

To obtain spare parts contact:

SEA S.r.l. - Zona Ind.le S.Atto, 64020 S. Nicolò a Tordino - Teramo - ITALIA

SAFETY AND ENVIRONMENTAL COMPATIBILITY:

Don't waste product packing materials and/or circuits.

When being transported this product must be properly packaged and handled with care.

MAINTENANCE AND OUT OF SERVICE:

The decommission and maintenance of ARM must only be carried out by specialised and authorised personnel.

NOTE: THE MANUFACTURER CAN NOT BE DEEMED RESPONSIBLE FOR ANY DAMAGE OR INJURY CAUSED BY IMPROPER USE OF THIS PRODUCT.

SEA reserves the right to do changes or variations that may be necessary to its products with no obligation to notice.



SEA
Sistemi elettronici
di Aperture Porte e Cancelli

SEA S.r.l.
Zona industriale 64020 S.ATTO Teramo - (ITALY)
Tel. 0861 588341 r.a. Fax 0861 588344

www.seateam.com

seacom@seateam.com