

**SEA®**

Sistemi Elettronici  
di Apertura Porte e Cancelli  
International registered trademark n. 804888



**Italiano**

**English**

**Français**

**Español**

**ATTUATORE OLEODINAMICO PER CANCELLI A BATTENTE**  
**HYDRAULIC OPERATOR FOR SWING GATE**  
**ACTUATEUR HYDRAULIQUE POUR PORTAIL À BATTANTS**  
**ACTUADOR OLEODINAMICO PARA CANCELAS ABATIBLES**

**FULL TANK**

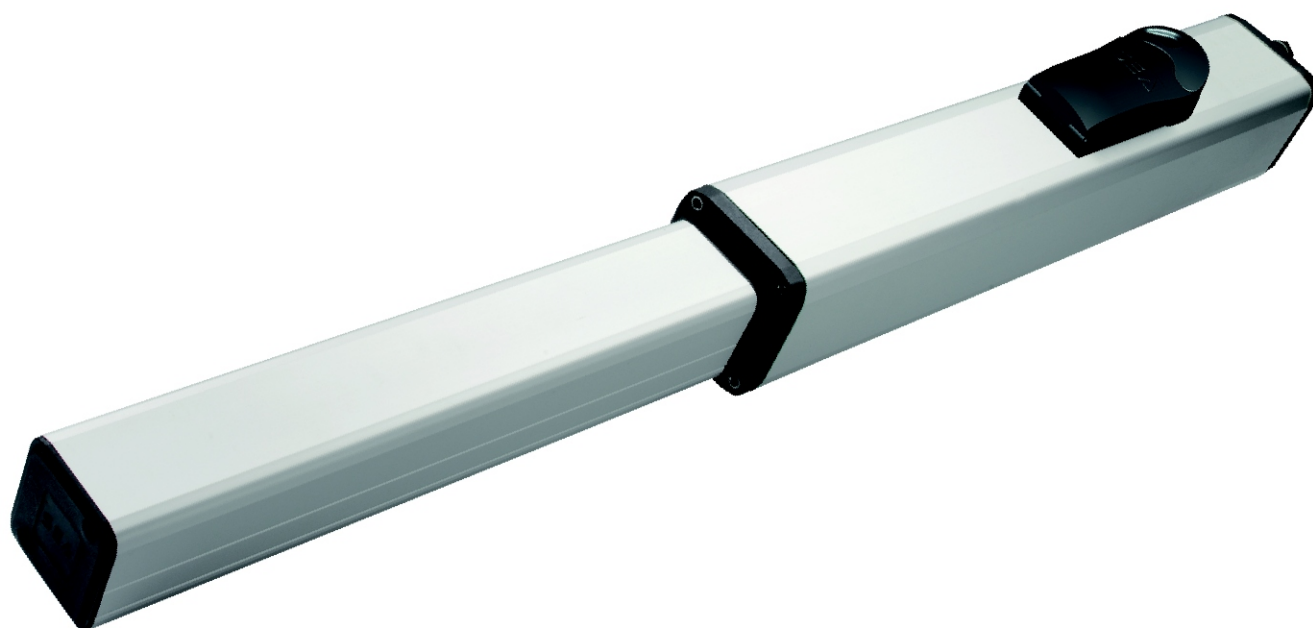

**MANUALE D'INSTALLAZIONE**  
**ed informazioni sulla sicurezza**

**INSTALLATION MANUAL**  
**and Security Information**

## FEATURES AND SPECIFICATIONS

The **FULL TANK** is a high quality hydraulic operator for condominium use for gates with leaf lengths up to max. 7 m.

Available in the following versions:

**AC** (*with lock in opening and closing*)

**SA** (*with lock only in opening*)

**SC** (*with lock only in closing*)

**SB** (*without lock*)

The lock is guaranteed for leaf lengths up to 180 m with the 270 version and up to 2,20 m with the 390 version. For leaf lengths exceeding 2,20 m it is necessary, in all versions, to install an electric lock.

The Full Tank is supplied with by-pass valves for the power regulation in both opening and closing. Electronic adjustable slow down in opening and closing with electronic control board. For the European laws and directives actually in force it is strongly recommended to use the Safety Gate (device for the reading of the gate position), for reverse in case of obstacle.

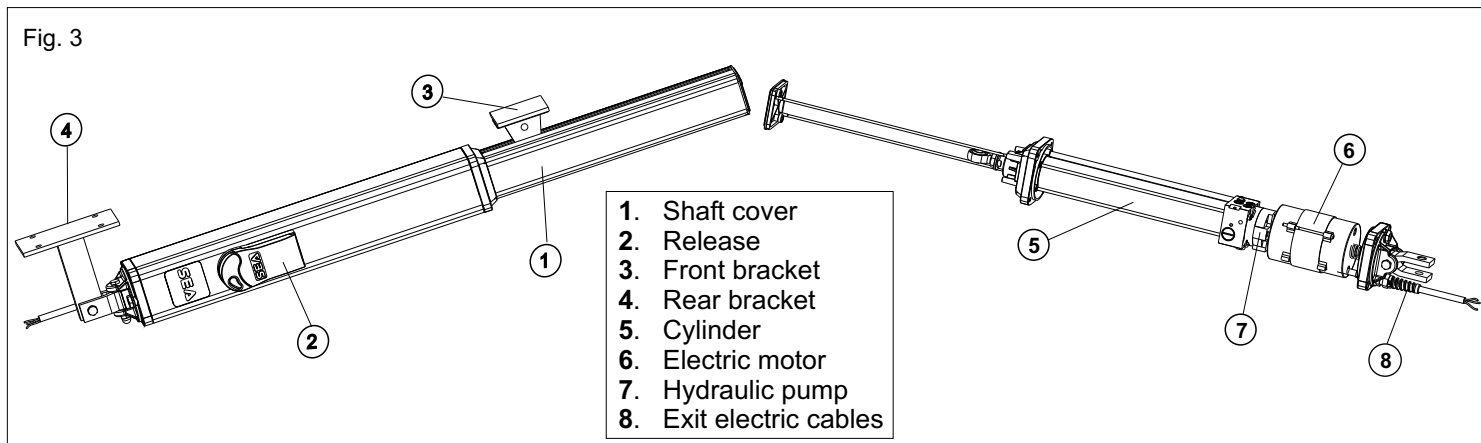
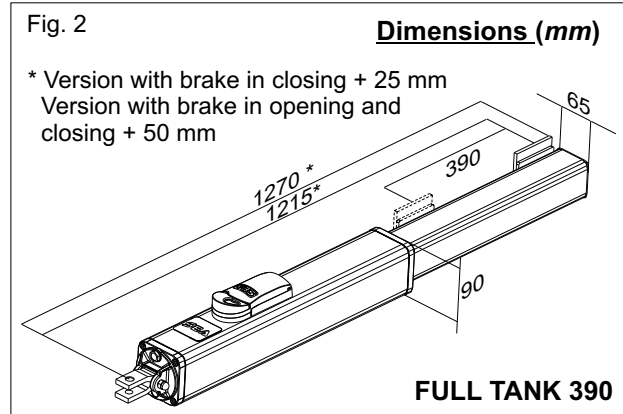
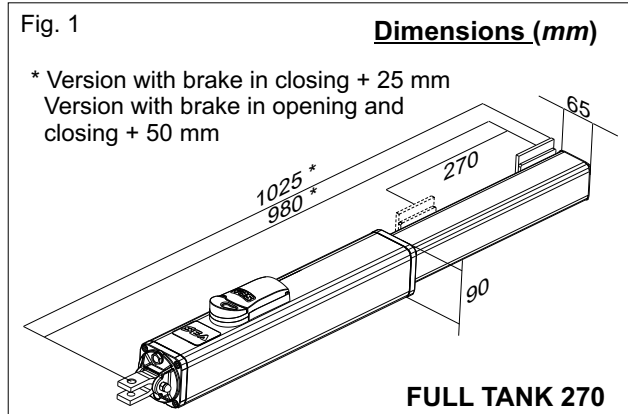

TECHNICAL FEATURES	FT 270 (230V)	FT 390 (230V)	FT 270 (120V)	FT 390 (120V)
Power supply	230V (±5%) 50/60 Hz		120V 60 Hz	
Power	220 W		300 W	
Absorbed current	1 A		2,45 A	
Stroke	270 mm	390 mm	270 mm	390 mm
Cycles hour (at a temp. of 20°C)	70			
Max working pressure	40 bar	30 bar	40 bar	
Operating temperatures	-20°C ↯ +55°C ↯			
Thermal protection	130°C			
Max Thrust	640da N			480 daN
Capacitor	12,5uF		60uF	
Weight	12,8 kg	15,2 kg	12,8 kg	15,2 kg
Protection class	Ip55			
Max leaf lenght	6 m	7 m	6 m	7 m
Opening degree of the leaf	90° / 125°			

**Note:** The frequency of use is valid only for the first hour at 20°C room temperature.

**Note:** in non-automatic logic, use operators without lock.

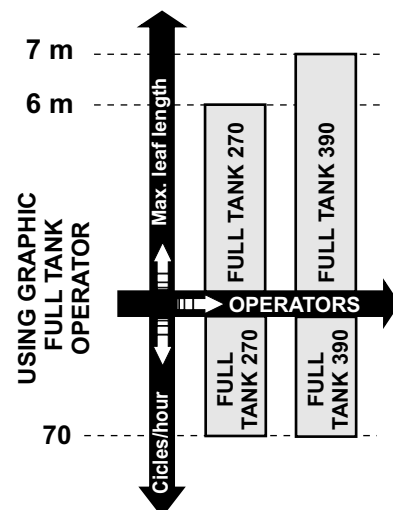

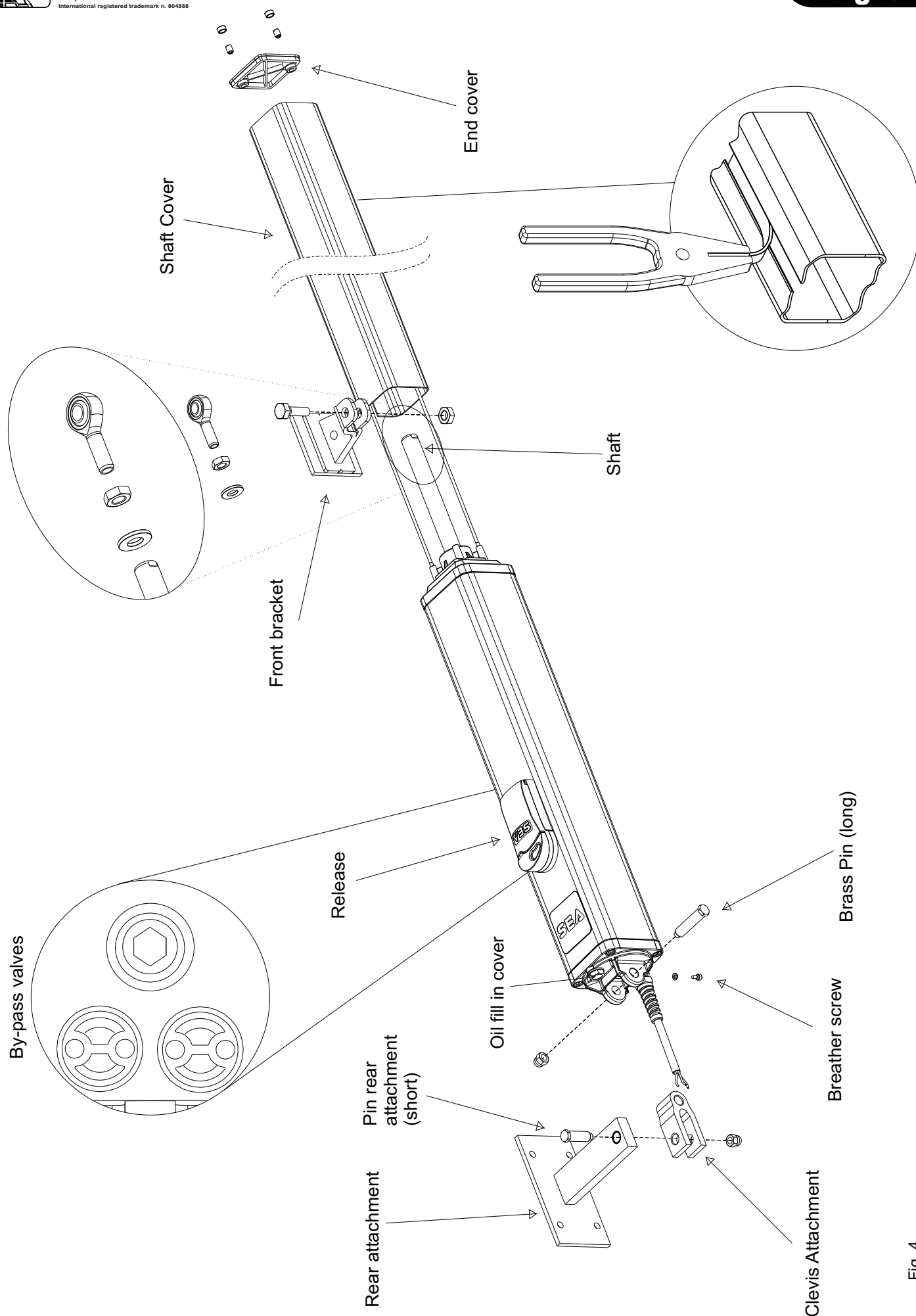
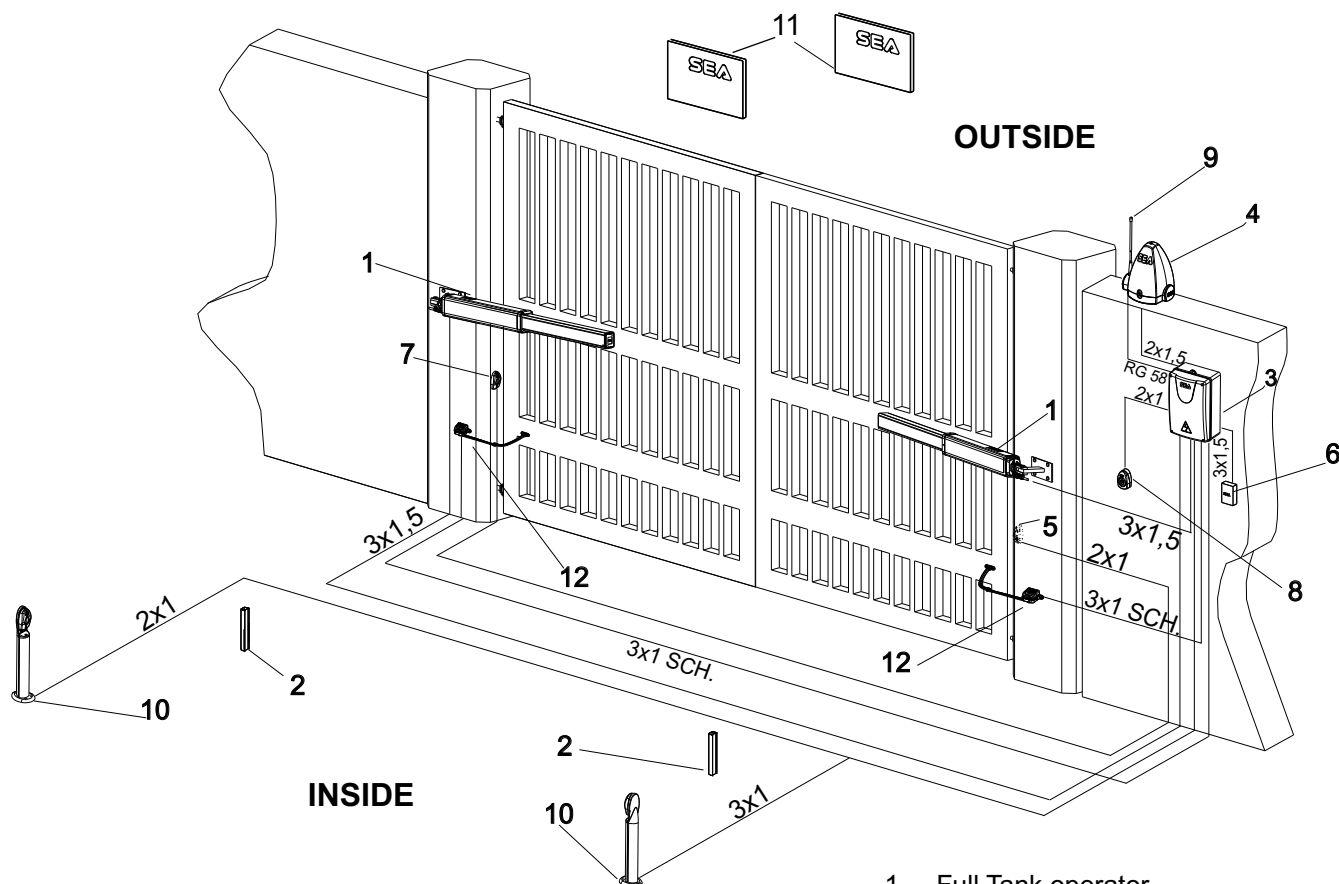

Fig. 4

## TYPICAL INSTALLATION



1. Full Tank operator
2. Mechanical stop
3. Control board
4. Warning lamp
5. Photocell tx
6. Differential switch 16A-0,03A
7. Photocell rx
8. Key switch start-stop
9. Antenna
10. Column for photocells
11. Warning notice
12. Safety Gate

## TYPE OF INSTALLATION

It is possible to install the Full Tank with opening inside (Fig.5) or opening outside (Fig.6).

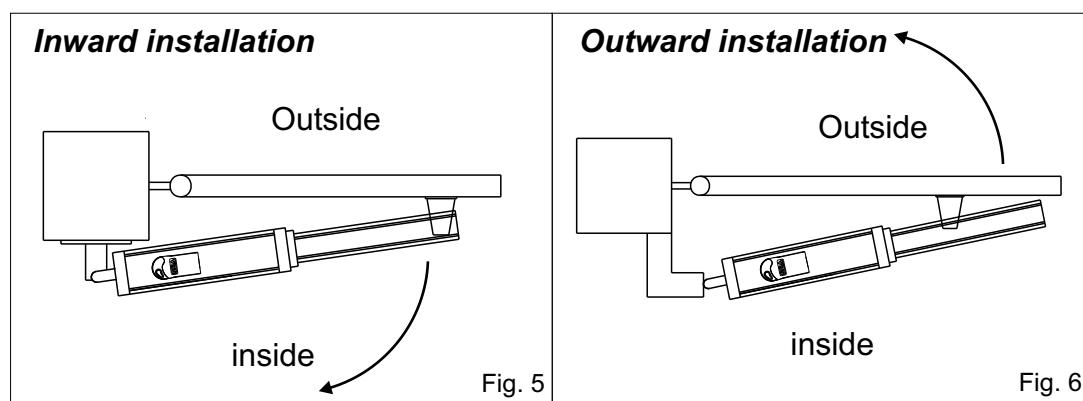

Install the operator always  
inside the property.

## INSIDE OPENING INSTALLATION

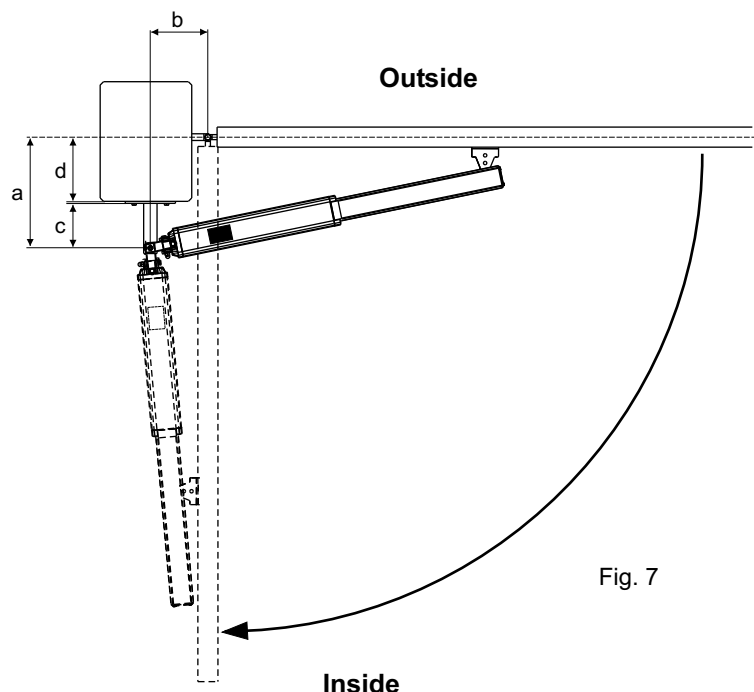

**Total stroke 270 mm - max. recommended stroke 250 mm**

a (mm)	b (mm)	d <sub>max</sub> (mm)	Max. Opening Angle	Max. Stroke (mm)	Stroke for 90°(mm)
100	115	50	110°	250	215
100	150	50	90°	250	
105	110	55	110°	245	215
105	145	55	90°	250	
120	105	70	106°	250	225
120	130	70	90°	250	
125	125	75	90°	250	
140	95	90	100°	250	235
140	110	90	90°	250	
145	95	95	100°	255	242
145	105	95	90°	250	
150	100	100	90°	250	
155	85	105	96°	250	242
160	90	110	90°	253	
170	75	120	92°	250	
180	65	130	92°	250	

To obtain 110° with d > 55 mm it is necessary to make a niche in the gate.

## INSIDE OPENING INSTALLATION

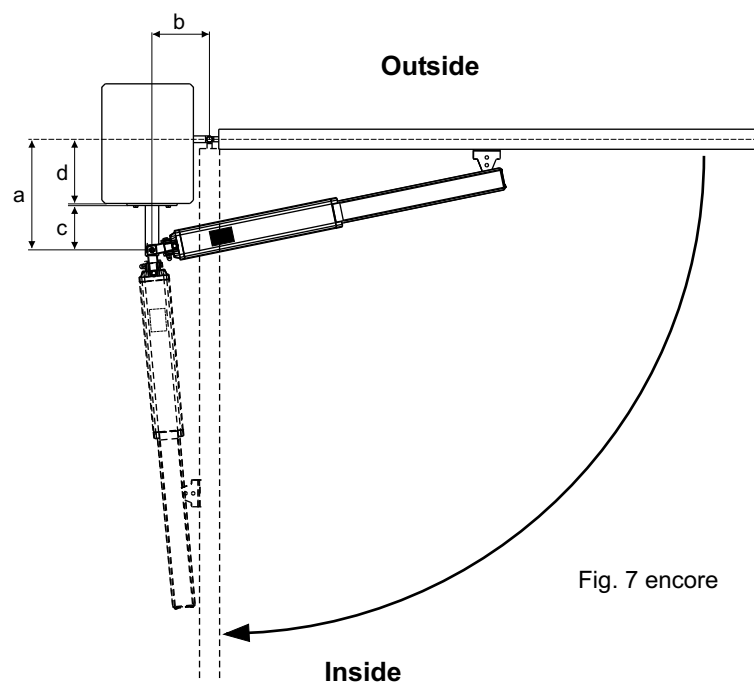

**Total stroke 390 mm - max. recommended stroke 370 mm**

a (mm)	b (mm)	d <sub>max</sub> (mm)	Max. Opening Angle	Stroke max (mm)	Stroke for 90°(mm)
125	170	75	125°	368	295
130	170	80	125°	372	300
140	235	90	90°	370	
145	165	95	120°	372	310
145	230	95	90°	370	
160	210	110	90°	370	
175	195	120	90°	370	
185	145	130	110°	370	330
185	190	130	90°	370	
195	140	140	110°	371	355
195	175	140	90°	370	
240	110	185	100°	370	355
240	125	185	90°	370	
250	105	195	95°	370	360
250	115	195	90°	370	
260	95	205	95°	369	365
260	100	205	90°	370	
270	90	215	90°	370	
280	80	230	90°	370	
295	65	245	90°	369	

To obtain 125° with d > 55 mm it is necessary to make a niche in the gate.

## OUTSIDE OPENING INSTALLATION

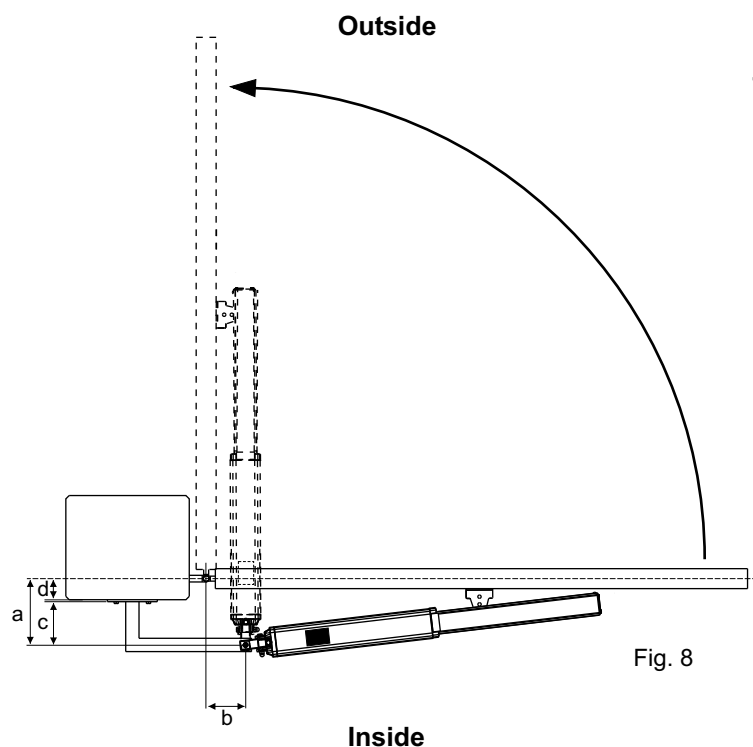

**Total stroke 270 mm - max. recommended stroke 250 mm**

a (mm)	b (mm)	Max. Opening Angle	Stroke max (mm)	Stroke for 90°(mm)
150	90	95°	250	240
160	90	90°	250	
165	80	95°	249	243
175	80	90°	250	
180	70	90°	250	
180	65	90°	241	

## OUTSIDE OPENING INSTALLATION

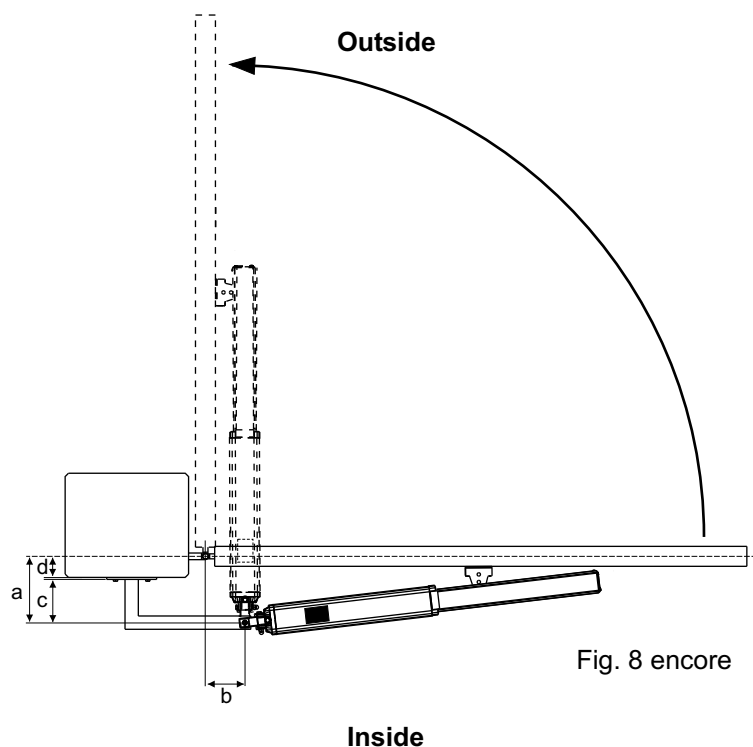

**Stroke 390 mm - max. recommended stroke 370 mm**

a (mm)	b (mm)	Max. Opening angle	Max. Stroke (mm)	Stroke for 90°(mm)
250	100	100°	356	342
255	95	95°	345	336
265	95	95°	342	335
270	90	90°	330	
275	90	90°	325	
275	90	90°	319	

## INSTALLATION ON MASONRY PILLARS, MAKING A NICHE

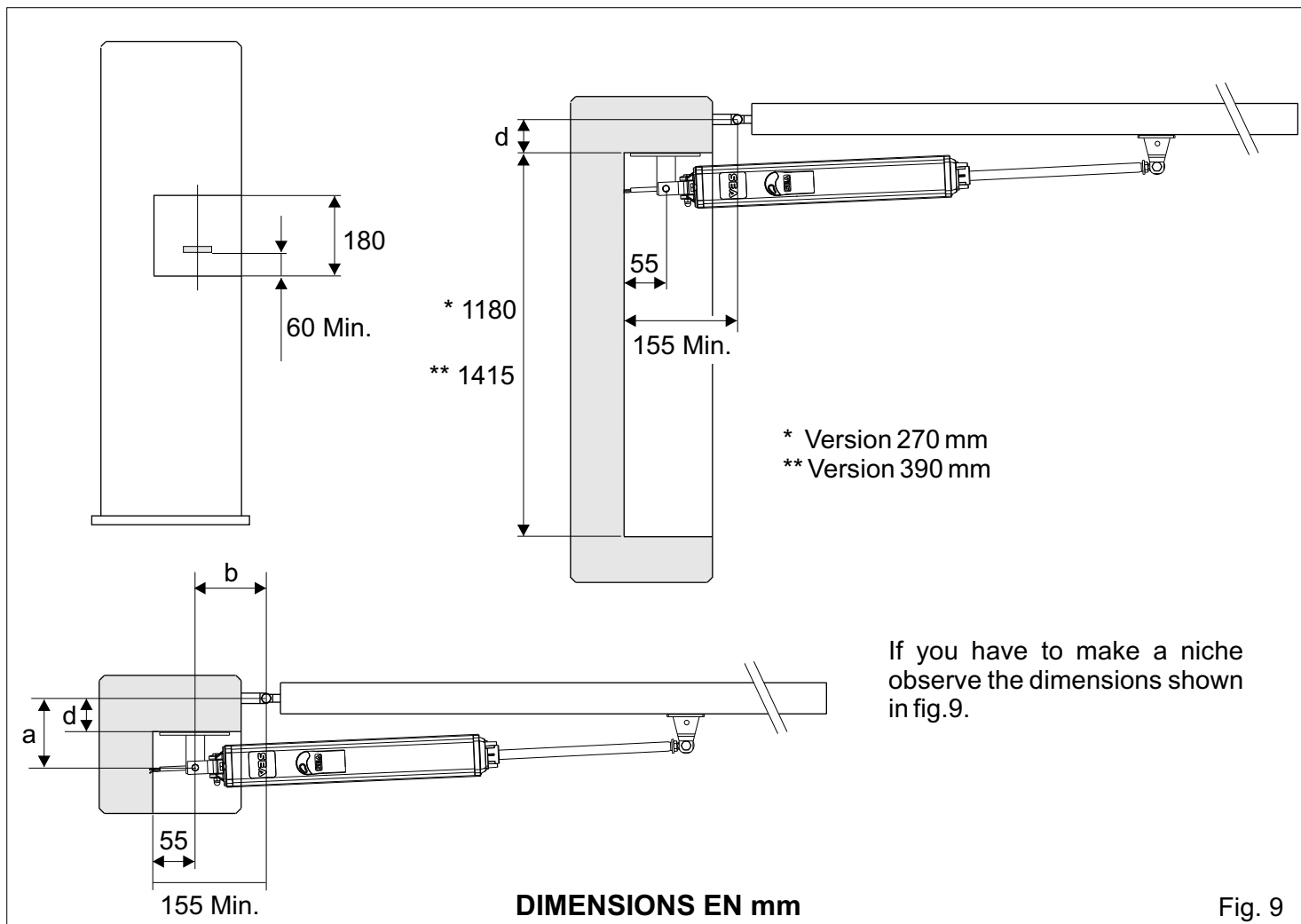

Fig. 9

## RELEASE MOUNTING

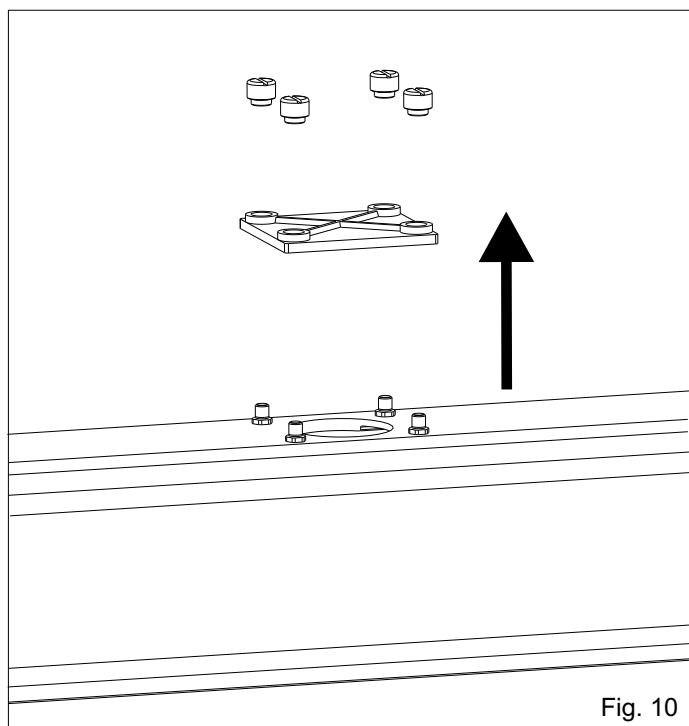

Fig. 10

Remove the transporting plate as shown in Fig. 10.

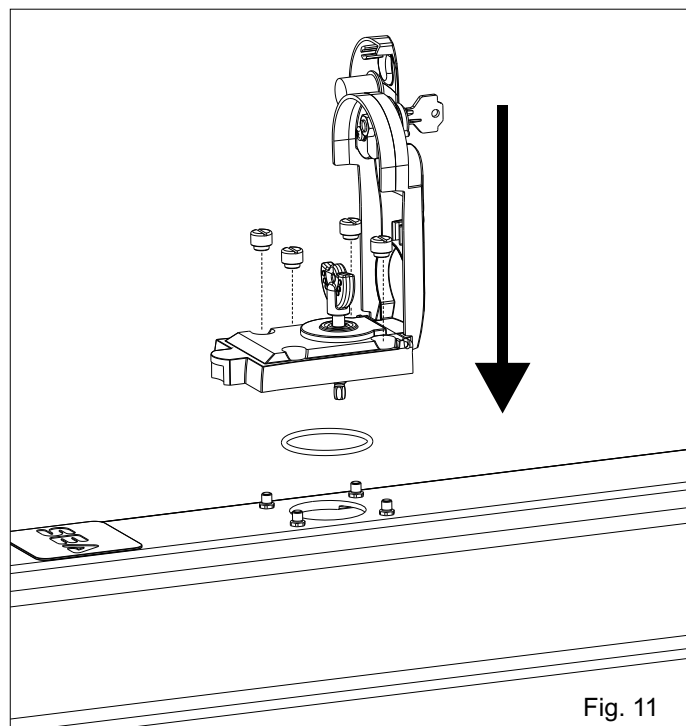

Fig. 11

Mount the release as shown in Fig. 11.

## INSTALLATION OF THE OSCILLATING REAR BRACKET

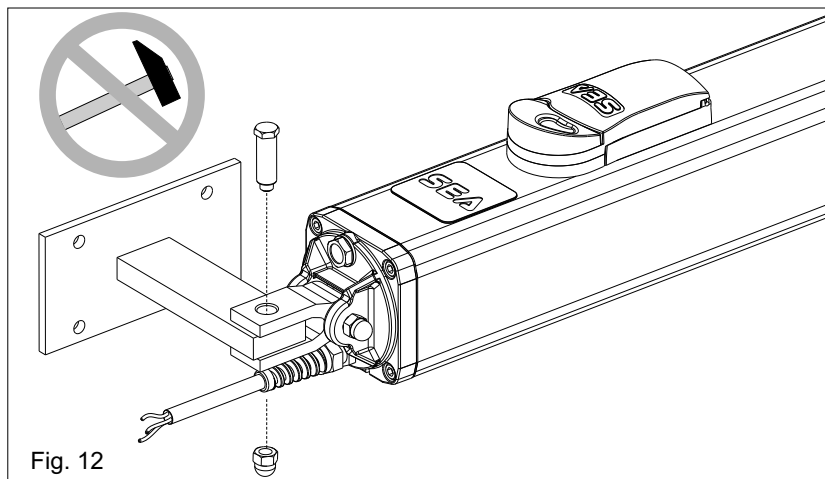

Fig. 12

### **PRELIMINARY:**

- Open carefully the package, making sure not to loose parts which are listed in fig. 4.
- Attach the rear oscillating bracket as shown in fig. 12

**Attention:** Do not use a hammer for the insertion of the short brass pin; its fitting into the bracket and clevis attachment must be done by the simple pressure of the hands.

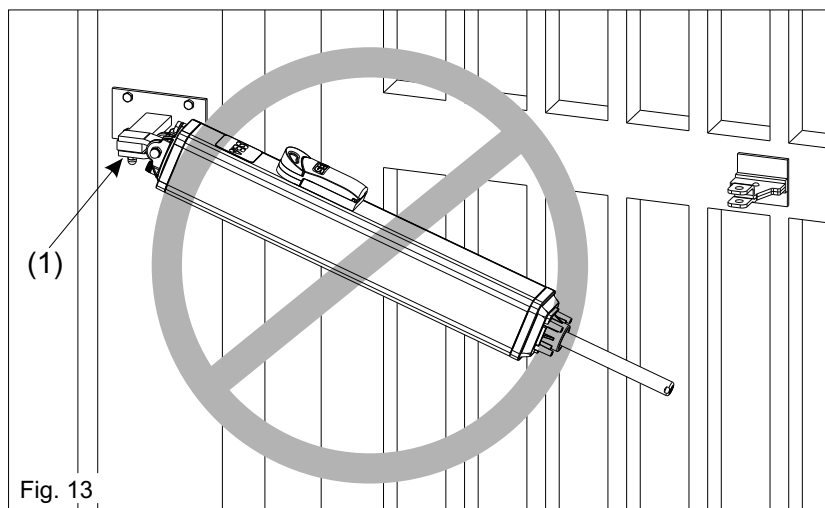

Fig. 13

**Attention:** Do not incline the hydraulic operator further than the allowed angle of the oscillating bracket (1), risks the possible braking of it.

## INSTALLATION OF REAR BRACKET

According to the type of opening that you have chosen (inside or outside) and to the chosen leaf rotation (see pag. 19-20), the rear bracket must first be cut respecting the quote "a" on pag. 19-20 and then welded as in fig. 15.

The support must be positioned so that the operator is perfectly levelled (Fig. 15, Fig. 16)

Adjustable rear bracket (with screws)  
(Accessory on demand)

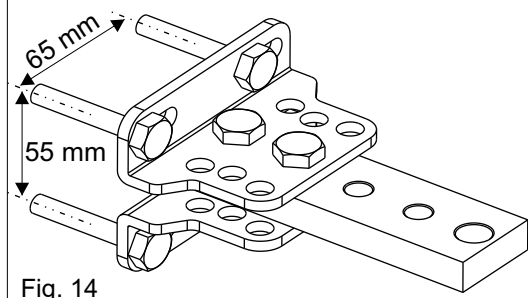

Fig. 14

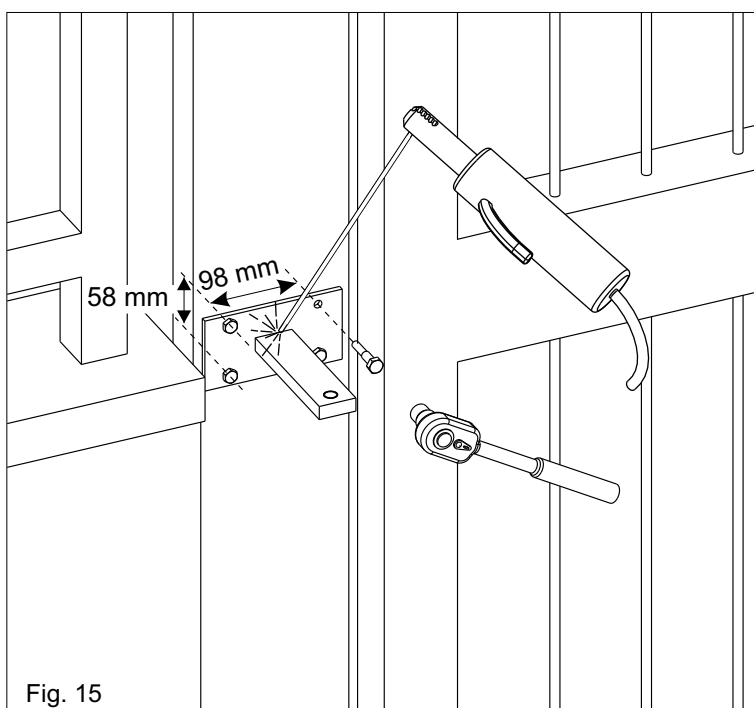

Fig. 15

## POSITIONING OF THE FRONT BRACKET

Once the operator is attached to the post and the leaf set in the closed position execute the following operations:

1. Release the operator.
2. Pull-out completely the chromate shaft and push it back in 1 cm.
3. Attach the shaft to the front bracket (Fig. 17).
4. Set the operator perfectly levelled and mark the position of the front bracket (Fig. 16).

**Attention:** avoid the welding of the front bracket to the shaft of the hydraulic operator already attached; the welding scraps (daps) could ruin the chromium plating of the shaft.

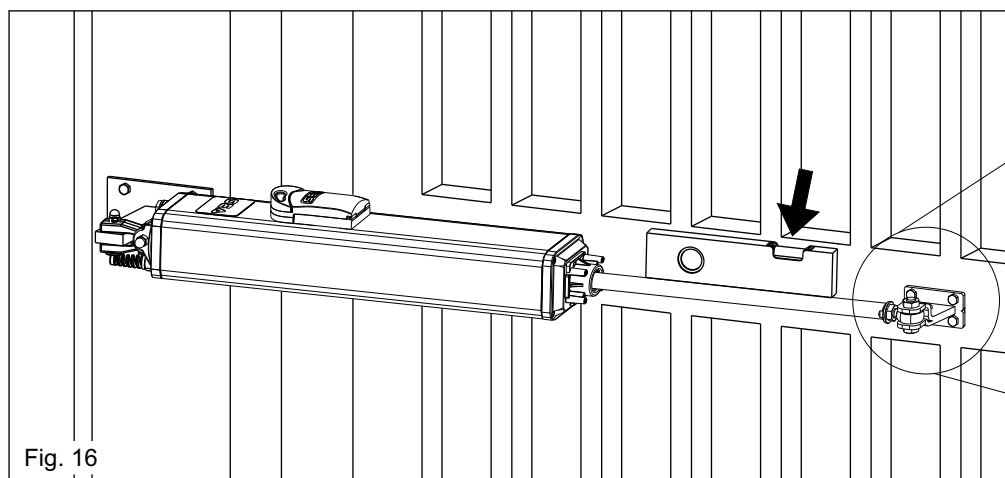

Fig. 16

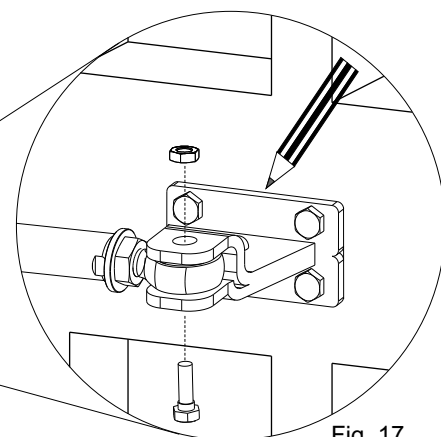

Fig. 17

## WELDING OF THE FRONT BRACKET TO THE GATE

*The front bracket must be positioned so that the operator is perfectly levelled*

**According to the nature of the gate the front bracket (wood, steal, Aluminium) can be:**

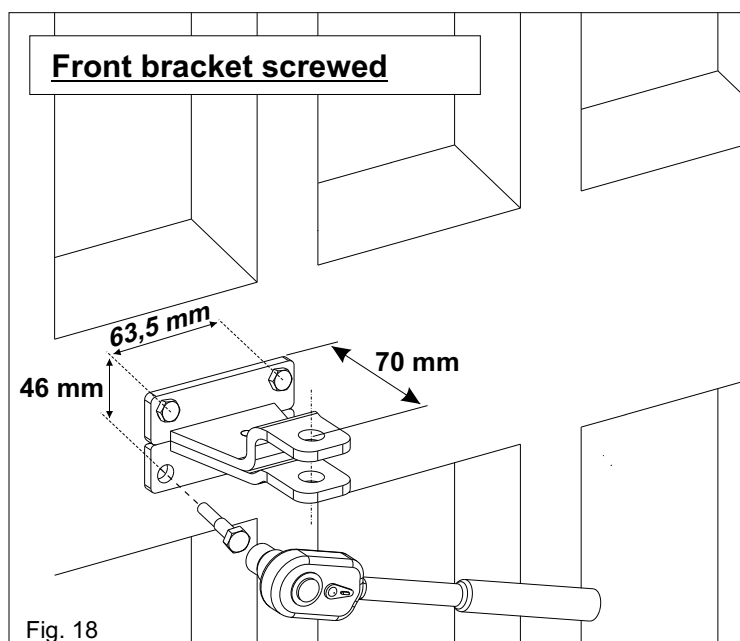

Fig. 18

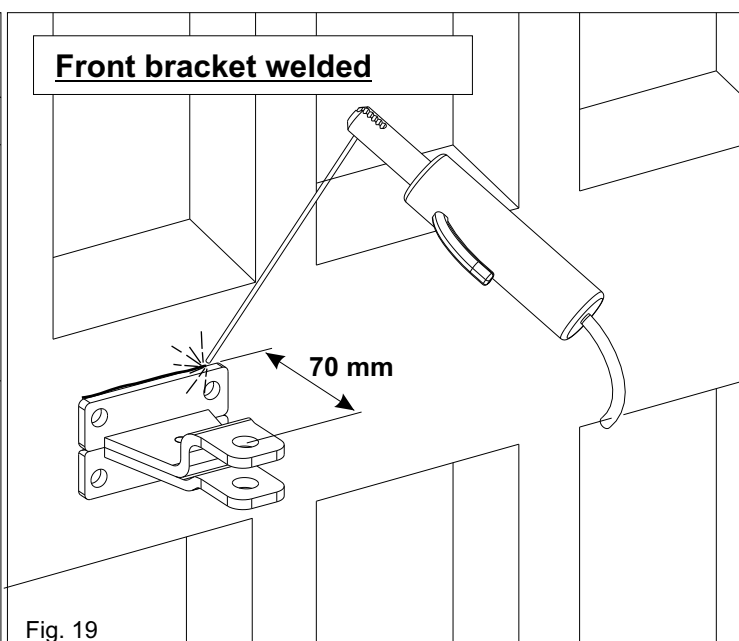
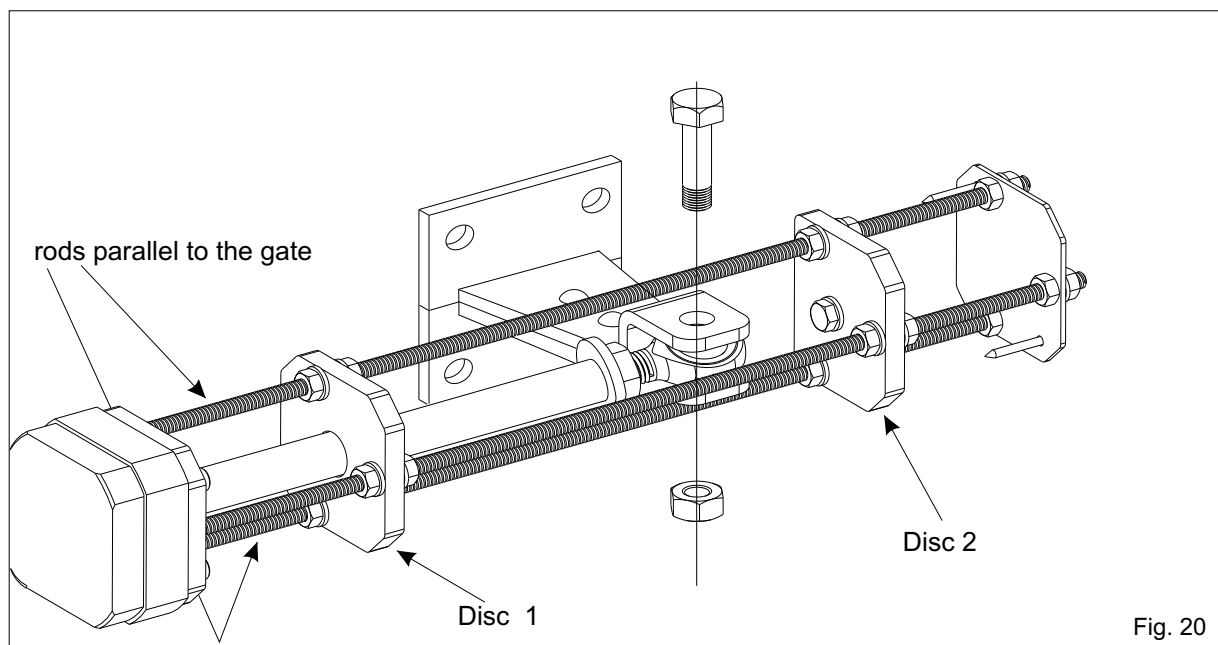

Fig. 19

## INSTALLATION OF POSITIVE STOPS (Accessories on request)

- Release the unit.
- Make the shaft come out for  $\frac{3}{4}$  of its stroke.
- Put the positive stops into the front flange of the unit with the two tie rods (of the three present on the stops) which are parallel to the gate (Fig.20).
- Fix the positive stops with the provided screws.
- Insert the ball joint after having installed the stops.
- At this point couple the shaft to the front bracket.
- To adjust the positive stops in opening act on disk 1 and in closing act on disk 2.

**Attention:** The mounting of the mechanical positive stops does not cause the reduction of the shaft stroke.



## BREATHER SCREW

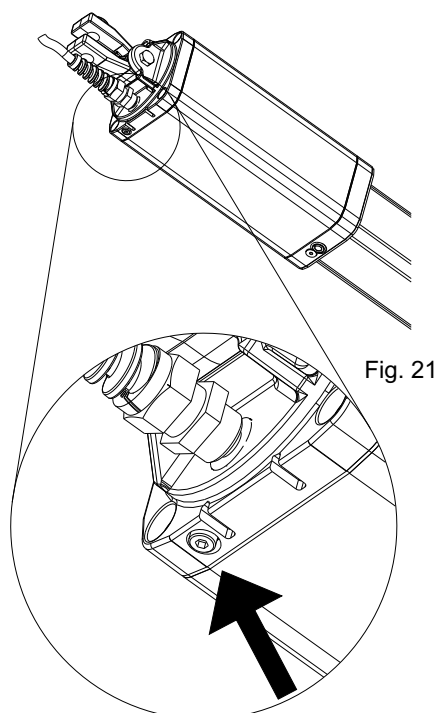

### ATTENTION

It is obligatory to remove the breather screw at the end of the installation.



**Unscrew and remove the screw under the operator at the end of installation**

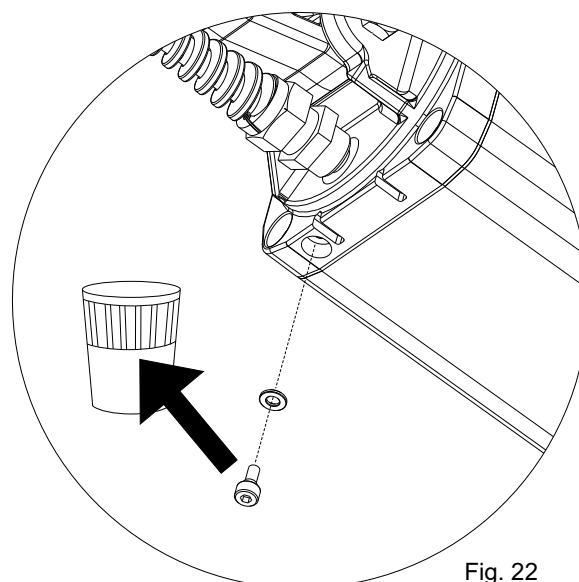

## TORQUE ADJUSTMENT (by pass valves)

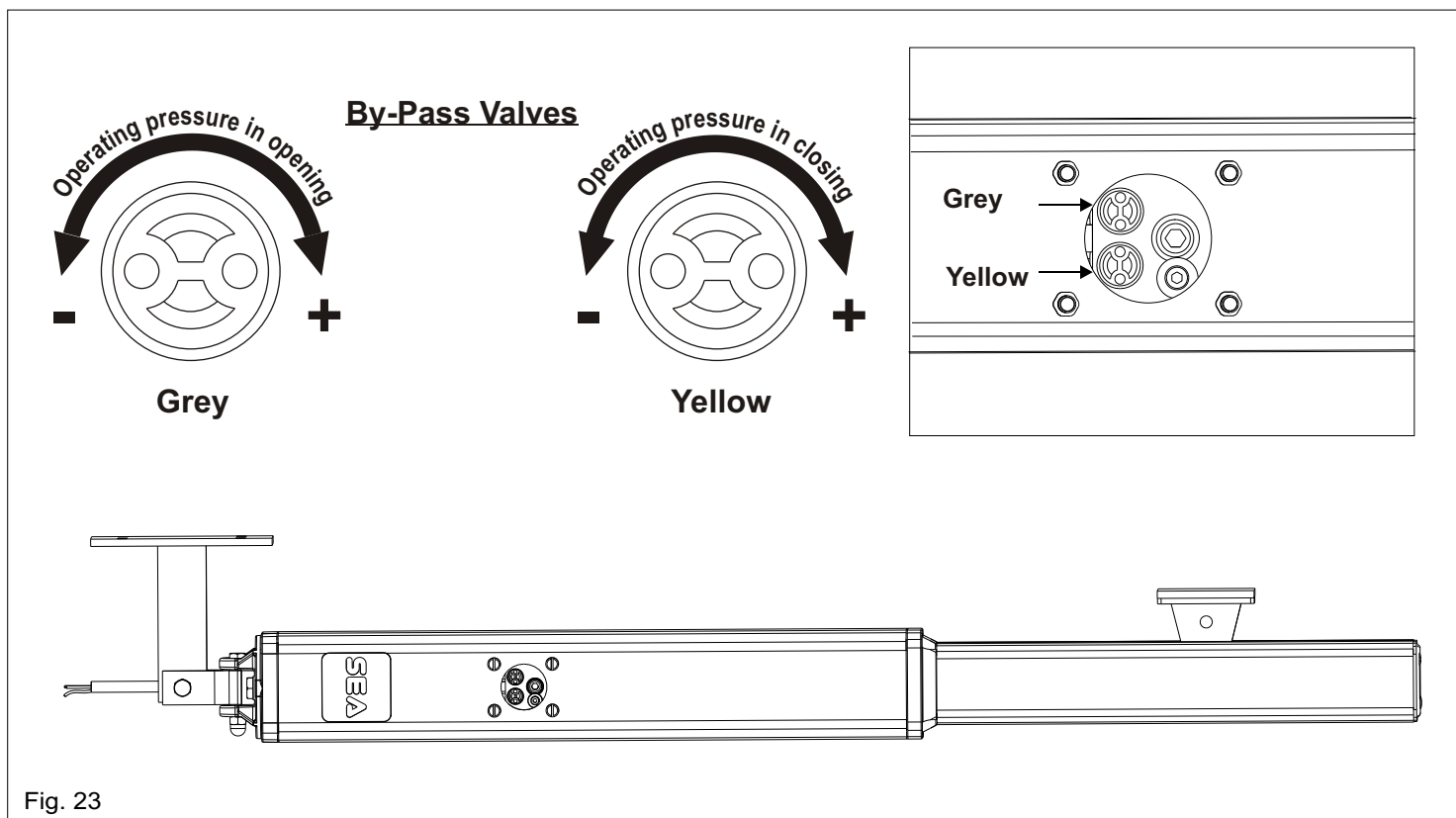

Adjust the opening and closing forces of the gate so that the diagram of the force is respected (present in the regulation EN 12453); Anyway the max. thrust force should never be superior of 15 kgF.

## INSTALLATION OF THE CHROME PLATED SHAFT COVER

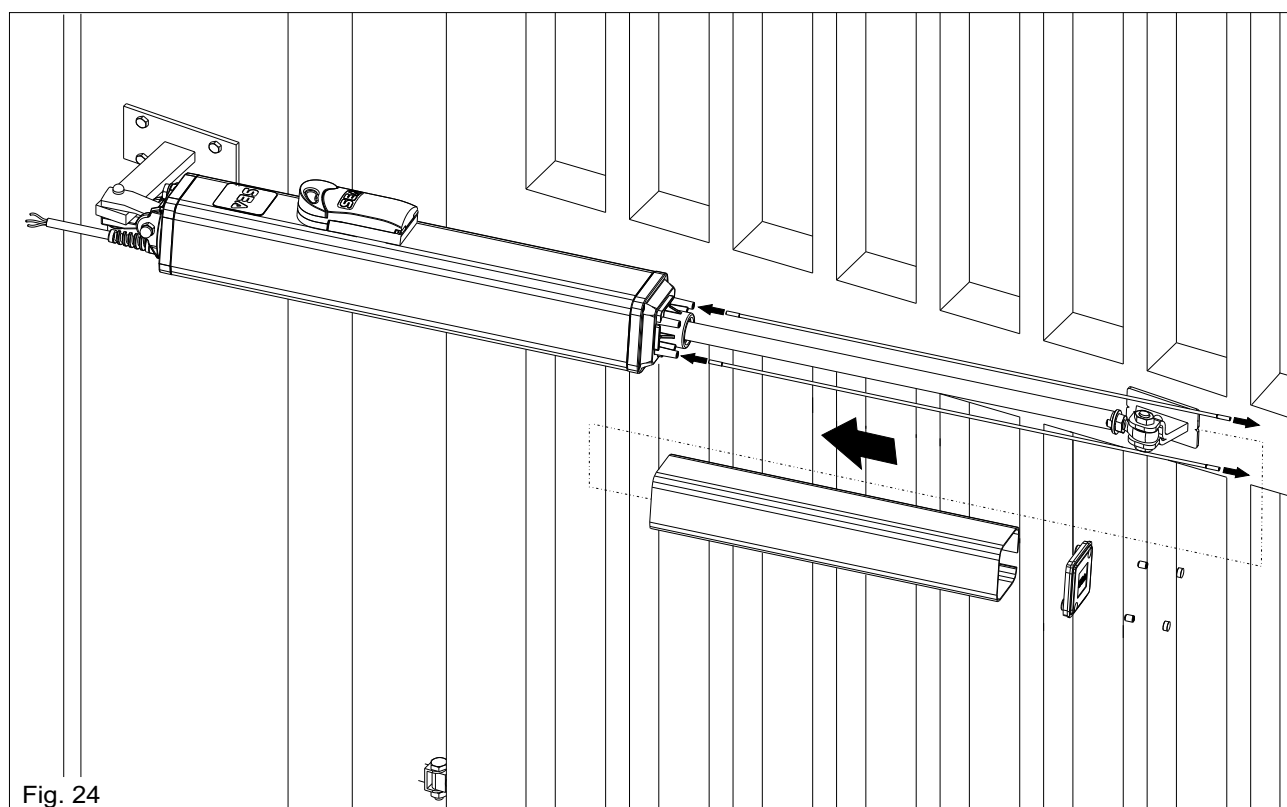

## OIL LEVEL MEASUREMENT

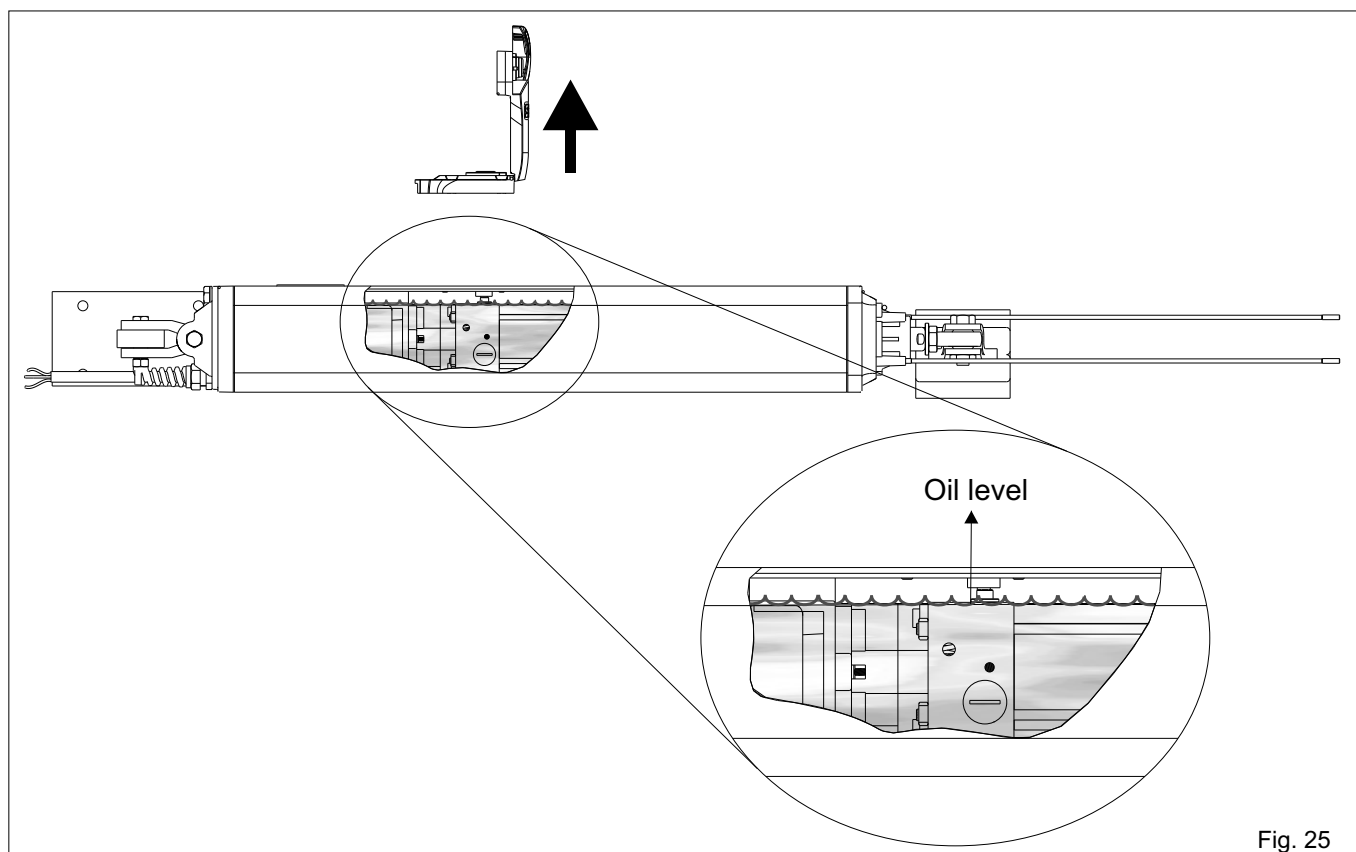
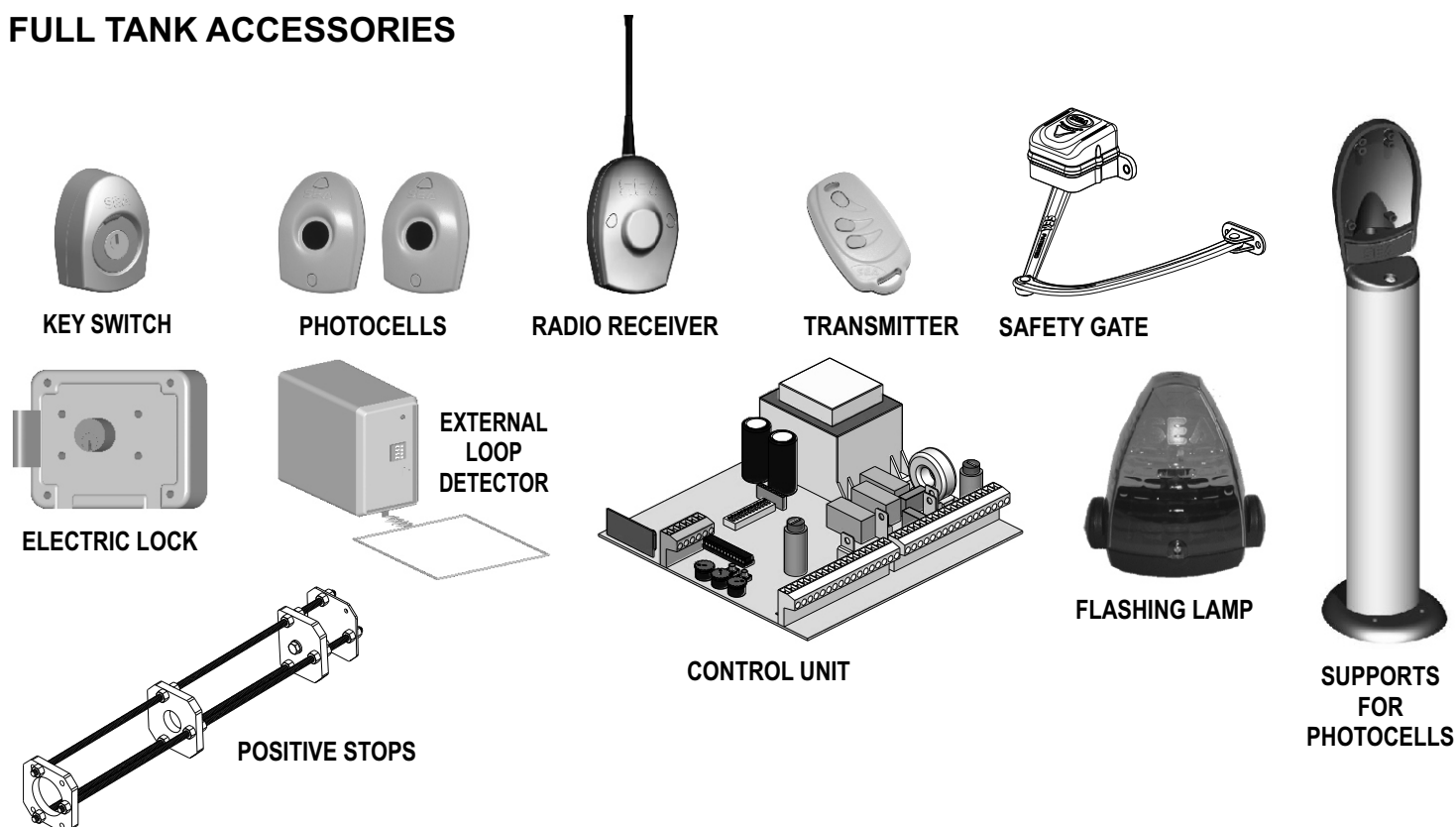

Fig. 25

The oil level should be measured with the rod inserted into the actuator and must stand in accordance with the distributor.

## FULL TANK ACCESSORIES



## RISK EXAMINATION

The points pointed by arrows in fig. 26 are potentially dangerous. The installer must take a thorough risk examination to prevent crushing, conveying, cutting, grappling, trapping so as to guarantee a safe installation for people, things and animals.

(Re. Laws in force in the country where installation has been made.)

As for misunderstandings that may arise refer to your area distributor or call our help desk. These instructions are part of the

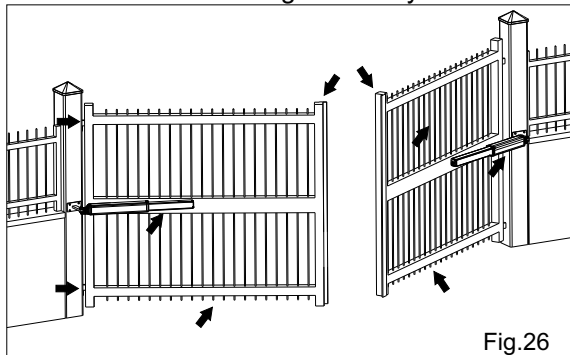

Fig.26

device and must be kept in a well known place. The installer shall follow the provided instructions thoroughly. SEA products must only be used to automate doors, gates and wings. Any initiative taken without SEA explicit authorization will preserve the manufacturer from whatsoever responsibility. The installer shall provide warning notices on not assessable further risks. SEA in its relentless aim to improve the products, is allowed to make whatsoever adjustment without giving notice. This doesn't oblige SEA to up-grade the past production. SEA can not be deemed responsible for any damage or accident caused by product breaking, being damages or accidents due to a failure to comply with the instructions herein. The guarantee will be void and the manufacturer responsibility will be nullified if SEA original spare parts are not being used. The electrical installation shall be carried out by a professional

technician who will release documentation as requested by the laws in force. Packaging materials such as plastic bags, foam polystyrene, nails etc must be kept out of children's reach as dangers may arise.

## INITIAL TEST AND STARTING OF THE AUTOMATION

After having completed the necessary operations for a correct installation of the Full Tank product, as described in this manual, and after having valued all resting risks which could arise in any installation, **it is necessary to test the automation to guaranty**

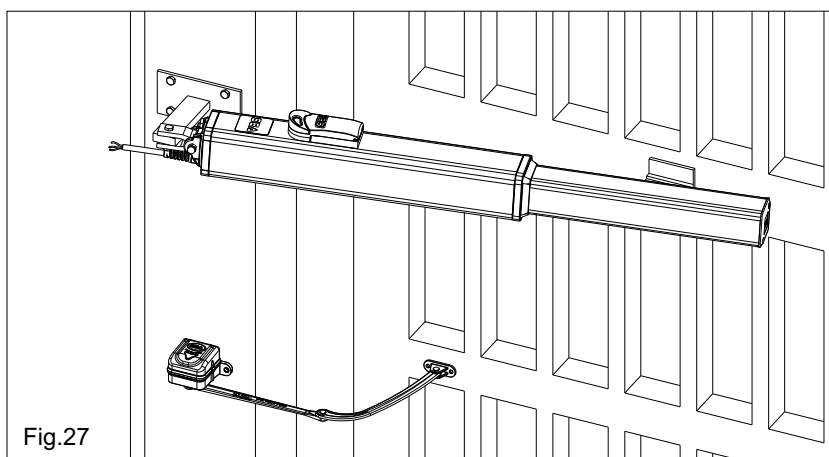

Fig.27

**the maximum security and, in particular way, to guaranty that the laws and norms of this sector are fully respected.** Especially the test must be executed following the norm **EN 12445** which establishes the methods of tests for checking the gate automations respecting the limits established by the rule **EN 12453**.

### SAFETY GATE

For a correct and safe installation it is strongly recommended to install a Safety Gate, **which allows the fulfilment of the force diagram included in the norm EN 12453** and consequently the test and start of the whole installation.

### SAFETY PRECAUTIONS:

All electrical work should conform to current regulations. A 16 A 0,030 A differential switch must be incorporated into the source of the operators main electrical supply and the entire system properly earth bonded. Always run mains carrying cables in separate ducts to low voltage control cables to prevent mains interference.

### INTENDED USE:

The operator Full Tank has been planned to be used for the automation of swing gate operator only.

### SPARE PARTS:

To obtain spare parts contact: **SEA S.p.A. - Zona Ind.le, 64020 S. ATTO Teramo Italia**

### SAFETY AND ENVIRONMENTAL COMPATIBILITY:

Don't waste product packing materials and/or circuits.

When being transported this product must be properly packaged and handled with care.

### LIMIT OF GUARANTEE

For the guarantee see the sales conditions on the official SEA price list.

### MAINTENANCE AND OUT OF SERVICE:

The decommission and maintenance of this unit must only be carried out by specialised and authorised personnel.

**NOTE: THE MANUFACTURER CAN NOT BE DEEMED RESPONSIBLE FOR ANY DAMAGE OR INJURY CAUSED BY IMPROPER USE OF THIS PRODUCT.**

*SEA reserves the right to do changes or variations that may be necessary to its products with no obligation to notice.*

## To the attention of users and technicians

### MANUAL RELEASE SYSTEM

**WARNING:** Always switch off the main power (110V or 230V) before servicing the operator.

#### RELEASE SYSTEM VERSION 1

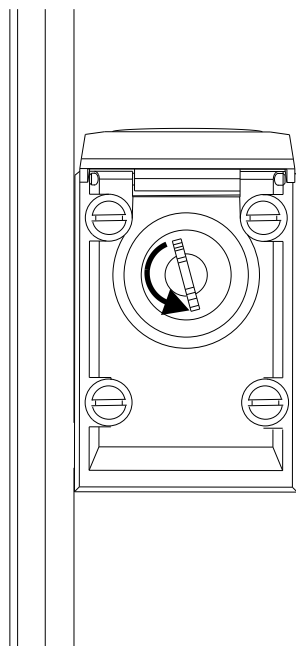

Fig. 28

**To release operate as follows:**

open the lid, insert the key, rotate starting from the stop of departure from  $\frac{1}{2}$  turn to a maximum of 1 turn ( $360^\circ$ ) in anti-clockwise direction (see fig.28).

**To relock the operator do as follows:**

turn the key into clockwise direction to the maximum, afterwards bring back the key into the position 0, turn it again in anti-clockwise direction (see fig. 29), remove the key and close the little door again.

**Attention:** Turning the key over 1 turn ( $360^\circ$ ) could damage the release.

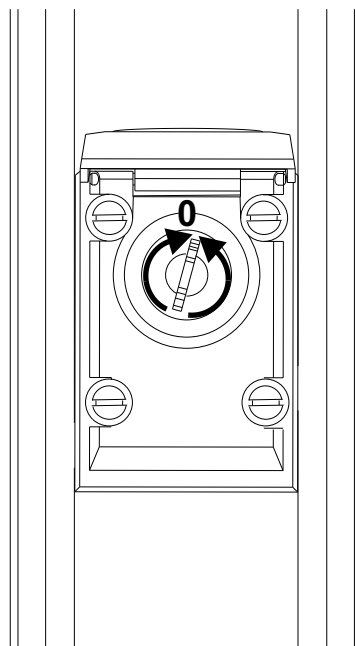

Fig. 29

#### RELEASE SYSTEM VERSION 2

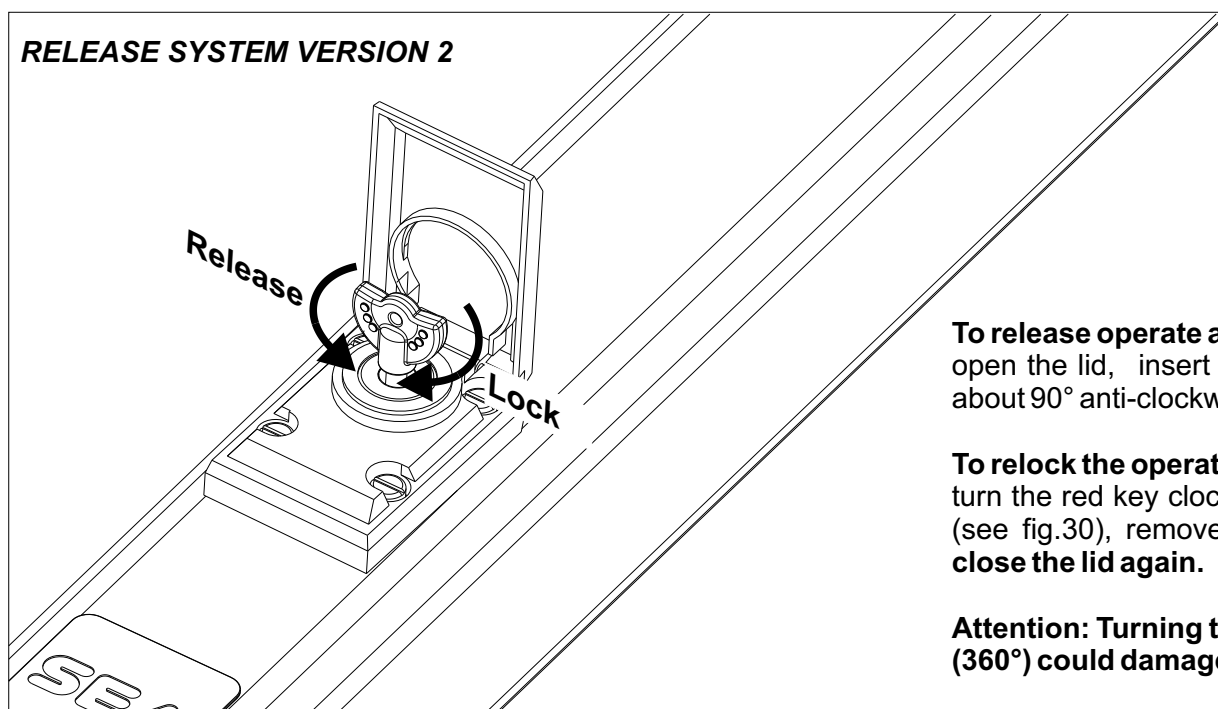

Fig. 30

**To release operate as follows:**

open the lid, insert the red key, turn it about  $90^\circ$  anti-clockwise (see fig.30).

**To relock the operator do as follows:**

turn the red key clockwise until it stops (see fig.30), remove the red key and close the lid again.

**Attention:** Turning the key over 1 turn ( $360^\circ$ ) could damage the release.

**WARNING:** SEA recommends to the end user to release the operator only after having switched off the electric power.

Always contact a professional installer in case of not correct working of the operator.

## To the attention of users and technicians

### RELEASE SYSTEM VERSION 3

#### To release operate as follows:

open the lock cover, insert the key, turn it about 90° clockwise (see fig.31) and open the lid.  
Take the red key located under the lid, insert it and turn it about 90° anti-clockwise (see fig.32).

#### To relock the operator do as follows:

turn the red key clockwise until it stops (see fig.32), remove it, put it under the lid and close the lid again.

**Attention: Turning the key over 1 turn (360°) could damage the release.**

Turn the key anti-clockwise to tighten the lid, remove the key and close the lock cover.

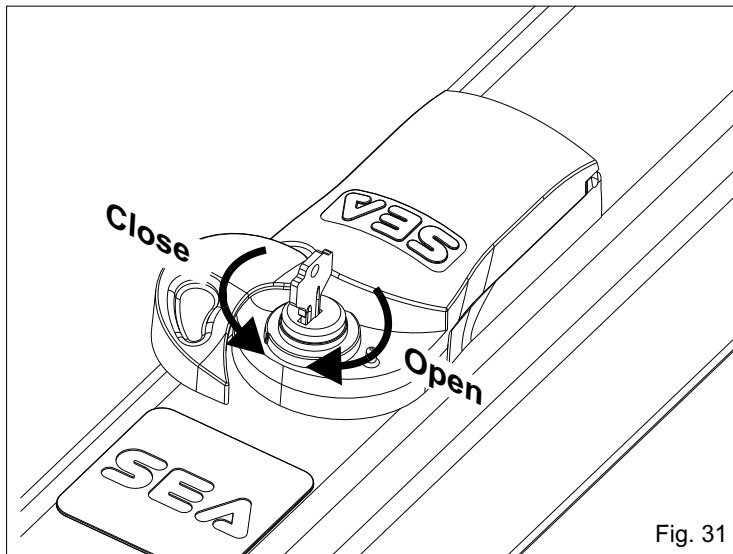

Fig. 31

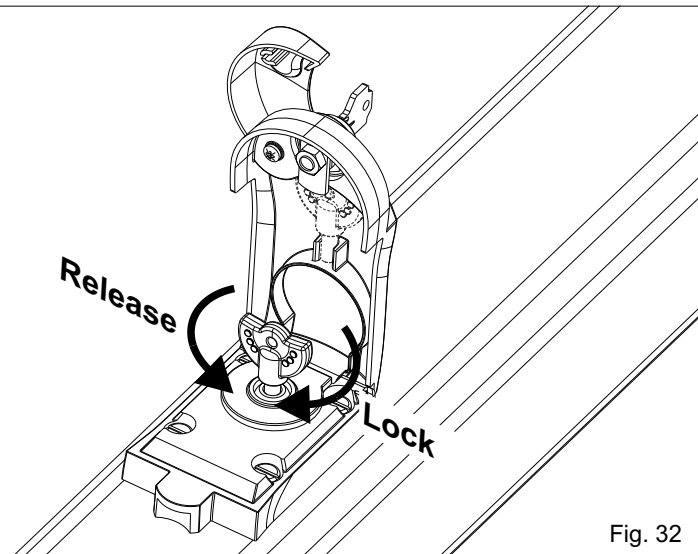

Fig. 32

**WARNING:** SEA recommends to the end user to release the operator only after having switched off the electric power.  
Always contact a professional installer in case of not correct working of the operator.

### PERIODICAL MAINTENANCE

1) Check the solidity and the stability of the gate, especially the points of support and/or rotation of the gate (pivots).	Annual
2) Check the oil level of the hydraulic/in oil bath operators (cap on rear cover of the Full Tank)	Annual
3) Change the hydraulic oil with the one recommended from the head company	4 years
4) Check the release function	Annual
5) Check the by-pass valves function	Annual
6) Check and lubricate the fixing pins	Annual
7) Check the integrity of the connection cables	Annual
8) Check the function and the positive stops condition in opening and closing (where there is present a mechanical positive stop accessory)	Annual
9) Check the good status of all parts which are forced (rear bracket, oscillating bracket and front bracket).	Annual
10) Check the operating of all accessories, especially the function of all safety devices and of the Safety Gate.	Annual
11) Lubricate the shaft (see page 17) with SEA grease (GREASE GL 00 Cod.65000009)	Annual
12) After having executed the periodical maintenance operations it is necessary to repeat the test and the putting in service of the automation	Annual

**All the above described operations MUST be made exclusively by an authorized installer.**

## CONDIZIONI DI VENDITA

**EFFICACIA DELLE PRESENTI CONDIZIONI GENERALI DI VENDITA:** Le presenti condizioni generali di vendita si applicano a tutti gli ordini indirizzati a SEA S.p.A. Tutte le vendite fatte da SEA ai clienti sono regolate secondo le presenti condizioni di vendita che costituiscono parte integrante del contratto di vendita ed annullano ogni clausola contraria o pattuizioni particolari presenti nell'ordine o in altro documento proveniente dall'acquirente (cliente)

**AVVERTENZE GENERALI** Gli impianti di automazioni porte e cancelli vanno realizzati esclusivamente con componenti SEA, salvo accordi specifici. L'inosservanza delle norme di sicurezza vigenti (Norm. EUROPEE EN 12453 - EN 12445 e altro) e di buona tecnica esclude la SEA da ogni responsabilità. La SEA non risponde del mancato rispetto della corretta e sicura installazione secondo le norme.

**1) PROPOSTA D'ORDINE** La proposta d'ordine si intenderà accettata solo dopo la sua approvazione da parte della SEA. Conseguenza della sua sottoscrizione, l'acquirente sarà vincolato alla stipula di un contratto d'acquisto, secondo quanto contenuto nella stessa proposta d'ordine e nelle presenti condizioni di vendita. Viceversa, la mancata comunicazione all'acquirentedel'approvazione della proposta d'ordine, non comporta la sua automatica accettazione da parte della SEA

**2) VALIDITÀ OFFERTA** Le offerte proposte dalla SEA o dalla sua struttura commerciale periferica, avranno una validità di 30 giorni solari, salvo diversa comunicazione in merito.

**3) PREZZI** I prezzi della proposta d'ordine sono quelli del listino in vigore alla data della redazione della stessa. Gli sconti applicati dalla struttura commerciale periferica della SEA si intenderanno validi solo dopo la loro accettazione da parte della SEA. I prezzi si intendono per merce resa franco ns. stabilimento in Teramo, esclusi IVA ed imballaggi speciali. La SEA si riserva il diritto di modificare in qualsiasi momento il listino, dando opportuno preavviso alla rete di vendita. Le condizioni speciali riservate agli acquisti con formula agevolata Qx, Qx1, Qx2, Qx3 sono riservate ai distributori ufficiali dietro accettazione scritta da parte della direzione SEA.

**4) PAGAMENTI** Le forme di pagamento ammesse sono quelle comunicate o accettate di volta in volta dalla SEA. Il tasso di interesse sul ritardo da pagamento è del 1,5% mensile e comunque non oltre il tasso massimo legalmente consentito.

**5) CONSEGNA** La consegna avverrà indicativamente ma non tassativamente entro 30 giorni lavorativi dalla data di ricezione dell'ordine, salvo diverse comunicazioni in merito. Il trasporto degli articoli venduti sarà effettuato a spese ed a rischio dell'acquirente. La SEA si libera dall'obbligo della consegna rimettendo la merce al vettore, sia esso scelto dalla SEA oppure dall'acquirente. Eventuali smarrimenti e/o danneggiamenti della merce dovuti al trasporto, sono a carico dell'acquirente.

**6) RECLAMI** Eventuali reclami e/o contestazioni dovranno pervenire alla SEA entro 8 giorni solari dalla ricezione della merce, supportati da idonei documenti provanti la loro veridicità.

**7) FORNITURA** L'ordine in oggetto viene assunto da SEA senza alcun impegno e subordinatamente alle possibilità di approvvigionamento delle materie prime occorrenti alla produzione; eventuali mancate esecuzioni totali o parziali non possono dar luogo a reclami e riserve per danni. La fornitura SEA è strettamente limitata alla sola merce di sua produzione, esclusi il montaggio, l'installazione ed il collaudo. La SEA declina pertanto ogni responsabilità per danni che dovessero derivare, anche a terzi, dall'inosservanza delle norme di sicurezza e della buona regola d'arte nelle fasi dell'installazione e dell'impiego dei prodotti venduti.

**8) GARANZIA** La garanzia minima è di 12 mesi e può essere estesa, come di seguito, in caso di riconsegna del certificato di garanzia.

**SILVER:** Le parti meccaniche degli operatori rientranti in tale categoria sono garantite per 24 mesi dalla data di fabbricazione riportata sull'operatore.

**GOLD:** Le parti meccaniche degli operatori rientranti in tale categoria sono garantite per 36 mesi dalla data di fabbricazione riportata sull'operatore.

**PLATINUM:** Le parti meccaniche degli operatori rientranti in tale categoria sono garantite per 36 mesi dalla data di fabbricazione riportata sull'operatore. La garanzia di base (36 mesi) sarà estesa per ulteriori 24 mesi (fino ad un totale di 60 mesi) qualora venga acquistato il certificato di garanzie che dovrà essere compilato e rispedito alla SEA S.p.A. entro 60 giorni dall'acquisto.

L'elettronica e le centrali di comando sono garantite per 24 mesi dalla data di fabbricazione. Nell'eventualità di difettosità del prodotto, la SEA si impegna alla sua sostituzione gratuita oppure alla sua riparazione, previa restituzione al proprio centro di riparazione. La definizione di stato di garanzia è ad insindacabile giudizio della SEA. I pezzi sostitutivi restano di proprietà della SEA.

In modo vincolante, il materiale dell'acquirente ritenuto in garanzia deve essere spedito al centro di riparazione della SEA in porto franco e sarà rispedito dalla SEA in porto assegnato. La garanzia non si estende alla manodopera eventualmente accorsa. I difetti riconosciuti non produrranno alcuna responsabilità e/o richiesta di danni, di qualsiasi natura essi siano, da parte dell'acquirente nei riguardi della SEA. La garanzia non è in ogni caso riconosciuta qualora sia stata apportata alla merce qualsivoglia modifica, oppure vi sia stato un uso improprio, oppure si sia in presenza di una qualsivoglia sua manomissione o di un montaggio non corretto, oppure se sia stata rimossa l'etichetta apposta dal produttore comprensiva del marchio SEA registrato n° 804888. La garanzia non è inoltre valida nel caso la merce SEA sia stata in parte o in toto accoppiata a componenti meccanici e/o elettronici non originali, ed in particolare in assenza di una specifica autorizzazione in merito, ed inoltre nel caso in cui l'acquirente non sia in regola con i pagamenti. La garanzia non comprende danni derivati dal trasporto, materiale di consumo, avarie dovute al mancato rispetto delle specifiche prestazionali dei prodotti indicate nel listino. Non è riconosciuto alcun indennizzo durante il tempo di riparazione e/o sostituzione della merce in garanzia. La SEA declina ogni responsabilità per danni a cose o persone derivanti dall'inosservanza delle norme di sicurezza e della non conforme installazione o dall'impiego errato dei prodotti venduti. La riparazione dei prodotti in garanzia e fuori garanzia è subordinata al rispetto delle procedure comunicate da SEA.

**9) RISERVATO DOMINIO** Sulla merce venduta è valida la clausola del riservato dominio, della quale la SEA deciderà autonomamente se avvalersi o meno, in virtù della quale l'acquirente acquisisce la proprietà della merce, solo dopo che il suo pagamento sia stato completamente effettuato.

**10) FORO COMPETENTE** Per qualsiasi controversia avente per oggetto l'applicazione di questo contratto, viene eletto competente il Foro di Teramo. La lingua valida nell'interpretazione di cataloghi, manuali di installazione, condizioni di vendita o altro è quella italiana. La SEA si riserva la facoltà di apportare modifiche tecniche atte a migliorare i propri prodotti, presenti o meno in questo Listino, in qualsiasi momento senza preavviso. La SEA declina ogni responsabilità derivante da possibili inesattezze contenute nel presente listino, derivanti da errori di stampa e/o trascrizione. Il presente Listino annulla e sostituisce quelli precedenti. L'acquirente ai sensi della legge 196/2003 (codice privacy) acconsente all'inserimento dei propri dati personali derivanti dal presente contratto negli archivi informatici e cartacei della SEAS.p.A. al loro trattamento per motivi commerciali ed amministrativi.

**Diritti di proprietà industriale:** il cliente, con l'acquisto, accetta le presenti condizioni di vendita e riconosce in capo a SEA la titolarità esclusiva del marchio internazionale SEA registrato n. 804888 apposto sulle etichette dei prodotti e/o sui manuali e/o su ogni altra documentazione, e si impegna ad utilizzare il medesimo nella propria attività di rivendita e/o installazione secondo modalità che non ne riducano in alcun modo i diritti, a non rimuovere, sostituire o alterare marchi o altri segni distintivi di qualsiasi genere apposti ai prodotti.

E' vietata ogni forma di riproduzione o utilizzo del marchio SEA e di ogni altro segno distintivo presente sui prodotti, salvo autorizzazione scritta di SEAS.p.A..

**Agli effetti dell'articolo 1341 del C.C. si approvano specificatamente per iscritto le clausole di cui ai numeri:**

**4) PAGAMENTI - 8) GARANZIA - 10) FORO COMPETENTE**

## TERMS OF SALES

**EFFICACY OF THE FOLLOWING TERMS OF SALE:** the following general terms of sale shall be applied to all orders sent to SEA S.p.A. All sales made by SEA to all costumers are made under the prescription of this terms of sales which are integral part of sale contract and cancel and substitute all apposed clauses or specific negotiations present in order document received from the buyer.

**GENERAL NOTICE** The systems must be assembled exclusively with SEA components, unless specific agreements apply. Non-compliance with the applicable safety standards (European Standards EM12453 – EM 12445) and with good installation practice releases SEA from any responsibilities. SEA shall not be held responsible for any failure to execute a correct and safe installation under the above mentioned standards.

**1) PROPOSED ORDER** The proposed order shall be accepted only prior SEA approval of it. By signing the proposed order, the Buyer shall be bound to enter a purchase agreement, according to the specifications stated in the proposed order.

On the other hand, failure to notify the Buyer of said approval must not be construed as automatic acceptance on the part of SEA.

**2) PERIOD OF THE OFFER** The offer proposed by SEA or by its branch sales department shall be valid for 30 solar days, unless otherwise notified.

**3) PRICING** The prices in the proposed order are quoted from the Price List which is valid on the date the order was issued. The discounts granted by the branch sales department of SEA shall apply only prior to acceptance on the part of SEA. The prices are for merchandise delivered ex-works from the SEA establishment in Teramo, not including VAT and special packaging. SEA reserves the right to change at any time this price list, providing timely notice to the sales network. The special sales conditions with extra discount on quantity basis (Qx, Qx1, Qx2, Qx3 formula) is reserved to official distributors under SEA management written agreement.

**4) PAYMENTS** The accepted forms of payment are each time notified or approved by SEA. The interest rate on delay in payment shall be 1.5% every month but anyway shall not be higher than the max. interest rate legally permitted.

**5) DELIVERY** Delivery shall take place, approximately and not peremptorily, within 30 working days from the date of receipt of the order, unless otherwise notified. Transport of the goods sold shall be at Buyer's cost and risk. SEA shall not bear the costs of delivery giving the goods to the carrier, as chosen either by SEA or by the Buyer. Any loss and/or damage of the goods during transport, are at Buyer's cost.

**6) COMPLAINTS** Any complaints and/or claims shall be sent to SEA within 8 solar days from receipt of the goods, proved by adequate supporting documents as to their truthfulness.

**7) SUPPLY** The concerning order will be accepted by SEA without any engagement and subordinately to the possibility to get it's supplies of raw material which is necessary for the production; Eventual completely or partially unsuccessful executions cannot be reason for complains or reservations for damage. SEA supply is strictly limited to the goods of its manufacturing, not including assembly, installation and testing. SEA, therefore, disclaims any responsibility for damage deriving, also to third parties, from non-compliance of safety standards and good practice during installation and use of the purchased products.

**8) WARRANTY** The standard warranty period is 12 months. This warranty time can be extended by means of expedition of the warranty coupon as follows:

**SILVER:** The mechanical components of the operators belonging to this line are guaranteed for 24 months from the date of manufacturing written on the operator.

**GOLD:** The mechanical components of the operators belonging to this line are guaranteed for 36 months from the date of manufacturing written on the operator.

**PLATINUM:** The mechanical components of the operators belonging to this line are guaranteed for 36 months from the date of manufacturing written on the operator. The base warranty (36 months) will be extended for further 24 months (up to a total of 60 months) when it is acquired the certificate of warranty which will be filled in and sent to SEA S.p.A. The electronic devices and the systems of command are guaranteed for 24 months from the date of manufacturing. In case of defective product, SEA undertakes to replace free of charge or to repair the goods provided that they are returned to SEA repair centre. The definition of warranty status is by unquestionable assessment of SEA. The replaced parts shall remain propriety of SEA. Binding upon the parties, the material held in warranty by the Buyer, must be sent back to SEA repair centre with fees prepaid, and shall be dispatched by SEA with carriage forward. The warranty shall not cover any required labour activities.

The recognized defects, whatever their nature, shall not produce any responsibility and/or damage claim on the part of the Buyer against SEA. The guarantee is in no case recognized if changes are made to the goods, or in the case of improper use, or in the case of tampering or improper assembly, or if the label affixed by the manufacturer has been removed including the SEA registered trademark No. 804888. Furthermore, the warranty shall not apply if SEA products are partly or completely coupled with non-original mechanical and/or electronic components, and in particular, without a specific relevant authorization, and if the Buyer is not making regular payments. The warranty shall not cover damage caused by transport, expendable material, faults due to non-conformity with performance specifications of the products shown in the price list. No indemnification is granted during repairing and/or replacing of the goods in warranty. SEA disclaims any responsibility for damage to objects and persons deriving from non-compliance with safety standards, installation instructions or use of sold goods. The repair of products under warranty and out of warranty is subject to compliance with the procedures notified by SEA.

**9) RESERVED DOMAIN** A clause of reserved domain applies to the sold goods; SEA shall decide autonomously whether to make use of it or not, whereby the Buyer purchases propriety of the goods only after full payment of the latter.

**10) COMPETENT COURT OF LAW** In case of disputes arising from the application of the agreement, the competent court of law is the tribunal of Teramo. SEA reserves the faculty to make technical changes to improve its own products, which are not in this price list at any moment and without notice. SEA declines any responsibility due to possible mistakes contained inside the present price list caused by printing and/or copying. The present price list cancels and substitutes the previous ones. The Buyer, according to the law No. 196/2003 (privacy code) consents to put his personal data, deriving from the present contract, in SEA archives and electronic files, and he also gives his consent to their treatment for commercial and administrative purposes.

**Industrial ownership rights:** once the Buyer has recognized that SEA has the exclusive legal ownership of the registered SEA brand num.804888 affixed on product labels and / or on manuals and / or on any other documentation, he will commit himself to use it in a way which does not reduce the value of these rights, he won't also remove, replace or modify brands or any other particularity from the products. Any kind of replication or use of SEA brand is forbidden as well as of any particularity on the products, unless preventive and expressed authorization by SEA.

**In accomplishment with art. 1341 of the Italian Civil Law it will be approved expressly clauses under numbers:**

**4) PAYMENTS - 8) GUARANTEE - 10) COMPETENT COURT OF LOW**

**Italiano** AVVERTENZE GENERALI PER INSTALLATORE E UTENTE

1. Leggere attentamente le **Istruzioni di Montaggio** e le **Avvertenze Generali** prima di iniziare l'installazione del prodotto. Conservare la documentazione per consultazioni future
2. Non disperdere nell'ambiente i materiali di imballaggio del prodotto e/o circuiti
3. Questo prodotto è stato progettato e costruito esclusivamente per l'utilizzo indicato in questa documentazione. Qualsiasi altro utilizzo non espressamente indicato potrebbe pregiudicare l'integrità del prodotto e/o rappresentare fonte di pericolo. L'uso improprio è anche causa di cessazione della garanzia. La SEA S.p.A. declina qualsiasi responsabilità derivata dall'uso improprio o diverso da quello per cui l'automatismo è destinato.
4. I prodotti SEA sono conformi alle Direttive: Macchine (2006/42/CE e successive modifiche), Bassa Tensione (2006/95/CE e successive modifiche), Compatibilità Elettromagnetica (2004/108/CE e successive modifiche). L'installazione deve essere effettuata nell'osservanza delle norme EN 12453 e EN 12445.
5. Non installare l'apparecchio in atmosfera esplosiva.
6. SEA S.p.A. non è responsabile dell'inosservanza della Buona Tecnica nella costruzione delle chiusure da motorizzare, nonché delle deformazioni che dovessero verificarsi durante l'uso.
7. Prima di effettuare qualsiasi intervento sull'impianto, togliere l'alimentazione elettrica e scollegare le batterie. Verificare che l'impianto di terra sia realizzato a regola d'arte e collegarvi le parti metalliche della chiusura.
8. Per ogni impianto SEA S.p.A. consiglia l'utilizzo di almeno una segnalazione luminosa nonché di un cartello di segnalazione fissato adeguatamente sulla struttura dell'infisso.
9. SEA S.p.A. declina ogni responsabilità ai fini della sicurezza e del buon funzionamento della automazione, in caso vengano utilizzati componenti di altri produttori.
10. Per la manutenzione utilizzare esclusivamente parti originali SEA.
11. Non eseguire alcuna modifica sui componenti dell'automazione.
12. L'installatore deve fornire tutte le informazioni relative al funzionamento manuale del sistema in caso di emergenza e consegnare all'Utente utilizzatore dell'impianto il libretto d'avvertenze allegato al prodotto.
13. Non permettere ai bambini o persone di sostare nelle vicinanze del prodotto durante il funzionamento. L'applicazione non può essere utilizzata da bambini, da persone con ridotte capacità fisiche, mentali, sensoriali o da persone prive di esperienza o del necessario addestramento. Tenere inoltre fuori dalla portata dei bambini radiocomandi o qualsiasi altro datore di impulso, per evitare che l'automazione possa essere azionata involontariamente.
14. Il transito tra le ante deve avvenire solo a cancello completamente aperto.
15. Tutti gli interventi di manutenzione, riparazione o verifiche periodiche devono essere eseguiti da personale professionalmente qualificato. L'utente deve astenersi da qualsiasi tentativo di riparazione o d'intervento e deve rivolgersi esclusivamente a personale qualificato SEA. L'utente può eseguire solo la manovra manuale.
16. La lunghezza massima dei cavi di alimentazione fra centrale e motori non deve essere superiore a 10 m. Utilizzare cavi con sezione 2.5 mm<sup>2</sup>. Utilizzare cablaggi con cavi in doppio isolamento (cavi con guaina) nelle immediate vicinanze dei morsetti specie per il cavo di alimentazione (230V). Inoltre è necessario mantenere adeguatamente lontani (almeno 2.5 mm in aria) i conduttori in bassa tensione (230V) dai conduttori in bassissima tensione di sicurezza (SELV) oppure utilizzare un'adeguata guaina che fornisca un isolamento supplementare avente uno spessore di almeno 1 mm.

**English** GENERAL NOTICE FOR THE INSTALLER AND THE USER

1. Read carefully these **Instructions** before beginning to install the product. Store these instructions for future reference
2. Don't waste product packaging materials and /or circuits.
3. This product was designed and built strictly for the use indicated in this documentation. Any other use, not expressly indicated here, could compromise the good condition/operation of the product and/or be a source of danger. SEA S.p.A. declines all liability caused by improper use or different use in respect to the intended one.
4. The mechanical parts must be comply with Directives: Machine Regulation 2006/42/CE and following adjustments), Low Tension (2006/95/CE), electromagnetic Consistency (2004/108/CE) Installation must be done respecting Directives: EN12453 and EN12445.
5. Do not install the equipment in an explosive atmosphere.
6. SEA S.p.A. is not responsible for failure to observe Good Techniques in the construction of the locking elements to motorize, or for any deformation that may occur during use.
7. Before attempting any job on the system, cut out electrical power and disconnect the batteries. Be sure that the earthing system is perfectly constructed, and connect it metal parts of the lock.
8. Use of the indicator-light is recommended for every system, as well as a warning sign well-fixed to the frame structure.
9. SEA S.p.A. declines all liability as concerns the automated system's security and efficiency, if components used, are not produced by SEA S.p.A..
10. For maintenance, strictly use original parts by SEA.
11. Do not modify in any way the components of the automated system.
12. The installer shall supply all information concerning system's manual functioning in case of emergency, and shall hand over to the user the warnings handbook supplied with the product.
13. Do not allow children or adults to stay near the product while it is operating. The application cannot be used by children, by people with reduced physical, mental or sensorial capacity, or by people without experience or necessary training. Keep remote controls or other pulse generators away from children, to prevent involuntary activation of the system.
14. Transit through the leaves is allowed only when the gate is fully open.
15. The User must not attempt to repair or to take direct action on the system and must solely contact qualified SEA personnel or SEA service centers. User can apply only the manual function of emergency.
16. The power cables maximum length between the central engine and motors should not be greater than 10 m. Use cables with 2,5 mm<sup>2</sup> section. Use double insulation cable (cable sheath) to the immediate vicinity of the terminals, in particular for the 230V cable. Keep an adequate distance (at least 2.5 mm in air), between the conductors in low voltage (230V) and the conductors in low voltage safety (SELV) or use an appropriate sheath that provides extra insulation having a thickness of 1 mm.

**Français** CONSIGNES POUR L'INSTALLATEUR ET L'UTILISATEUR

1. Lire attentivement les **instructions** avant d'installer le produit. Conserver les instructions en cas de besoin.
2. Ne pas disperser dans l'environnement le matériel d'emballage du produit et/ou des circuits
3. Ce produit a été conçu et construit exclusivement pour l'usage indiqué dans cette fiche. Toute autre utilisation non expressément indiquée pourraient compromettre l'intégrité du produit et/ou représenter une source de danger. SEA S.p.A. décline toute responsabilités qui dériverait d'usage impropre ou différent de celui auquel l'automatisme est destiné. Une mauvaise utilisation cause la cessation de la garantie.
4. Les composants doivent répondre aux prescriptions des Normes: Machines (2006/42/CE et successifs changements); Basse Tension (2006/95/CE et successifs changements); EMC (2004/108/CE et successifs changements). L'installation doit être effectuée conformément aux Normes EN 12453 et EN 12445.
5. Ne pas installer l'appareil dans une atmosphère explosive.
6. SEA S.p.A. n'est pas responsable du non-respect de la Bonne Technique de construction des fermetures à motoriser, ni des déformations qui pourraient intervenir lors de l'utilisation.
7. Couper l'alimentation électrique et déconnecter la batterie avant toute intervention sur l'installation. Vérifier que la mise à terre est réalisée selon les règles de l'art et y connecter les pièces métalliques de la fermeture.
8. On recommande que toute installation soit dotée au moins d'une signalisation lumineuse, d'un panneau de signalisation fixé, de manière appropriée, sur la structure de la fermeture.
9. SEA S.p.A. décline toute responsabilité quant à la sécurité et au bon fonctionnement de l'automatisme si les composants utilisés dans l'installation n'appartiennent pas à la production SEA.



**Dichiarazione di conformità**  
**Declaration of Conformity**

La SEA S.p.A. dichiara sotto la propria responsabilità e, se applicabile, del suo rappresentante autorizzato che il prodotto:

*SEA S.p.A. declares under its proper responsibility and, if applicable, under the responsibility of its authorised representative that the product:*

<b>Descrizione / Description</b>	<b>Modello / Model</b>	<b>Marca / Trademark</b>
Full Tank 270 AC (e tutti i suoi derivati)	10601005	SEA
<i>Full Tank 270 AC (and all its by-products)</i>	<i>10601005</i>	<i>SEA</i>
Full Tank 390 AC (e tutti i suoi derivati)	10701010	SEA
<i>Full Tank 390 AC (and all its by-products)</i>	<i>10701010</i>	<i>SEA</i>

è costruito per essere incorporato in una macchina o per essere assemblato con altri macchinari per costruire una macchina ai sensi della Direttiva 2006/42/CE:

*is built to be integrated into a machine or to be assembled with other machinery to create a machine under the provisions of Directive 2006/42/CE:*

è conforme ai requisiti essenziali di sicurezza relativi al prodotto entro il campo di applicabilità delle Direttive Comunitarie 2006/95/CE e 2004/108/CE.

*it is conforming to the essential safety requirements related to the product within the field of applicability of the Community Directives 2006/95/CE and 2004/108/CE.*

**COSTRUTTORE o RAPPRESENTANTE AUTORIZZATO:**  
**MANUFACTURER or AUTHORISED REPRESENTATIVE:**

SEAS.p.A.  
DIREZIONE E STABILIMENTO:  
Zona industriale 64020 S.ATTO Teramo - (ITALY)  
Tel. 0861 588341 r.a. Fax 0861 588344  
[Http://www.seateam.com](http://www.seateam.com)

I test sul prodotto sono stati effettuati in configurazione standard e in riferimento alle norme specifiche per la sua classe d'utilizzo.

*The products have been tested in standard configuration and with reference to the special norms concerning the classe of use.*

(Luogo, data di emissione)  
(Place, date of issue)  
Teramo, 05/11/2013

L'Amministratore  
The Administrator  
Ennio Di Saverio  

# CERTIFICATO DI ESTENSIONE GARANZIA CERTIFICATE OF WARRANTY EXTENTION

*n.*

## PRODOTTO/ PRODUCT

- Modello/Model \_\_\_\_\_
- Matricola n. /Serial Number \_\_\_\_\_
- Data di acquisto/Date of order \_\_\_\_\_
- Data di installazione/Date of installation \_\_\_\_\_

**Centrale/Control unit**

SEA ☐

Altri/Others ☐

**Fotocellule/Photocells**

SEA ☐

Altri/Others ☐

**RX - TX**

SEA ☐

Altri/Others ☐

**Altri accessori /Other accessories**

SEA ☐

Altri/Others ☐

## UTENTE/Customer

Nome e Cognome \_\_\_\_\_

*First Name and Family Name* \_\_\_\_\_

Indirizzo/Address \_\_\_\_\_

## INSTALLATORE/Installer

Ragione sociale/Company Name \_\_\_\_\_

Nome e Cognome/First and Family Name \_\_\_\_\_

Indirizzo/Address \_\_\_\_\_

## INSTALLATORE/INSTALLER

Firma per il trattamento dei dati personali 196/2003

Agreement of law No. 196/2003 (Privacy Code)

Copia da restituire

*Copy to be returned*

Firma e Timbro

*Sign and Stamp* \_\_\_\_\_

N.B: L'estensione della garanzia legale di 12 mesi a 24 mesi e 36 mesi è valida solo se il presente modulo viene rispedito per posta o fax a SEA S.p.A. entro 15gg dalla data di acquisto. Allegare relativa fattura d'acquisto.

Note: The extension of the legal standard warranty of 12 months to 24 months and to 36 months, is valid only if the present form is returned by mail or fax to SEA S.p.A within 15days from the date of purchase. Attach customer invoice.



**SEA®**  
Sistemi Elettronici  
di Apertura Porte e Cancelli  
International registered trademark n. 804888

SEA S.p.A. - Zona Industriale San Atto- 64020 Teramo (Italy)

Phone +39 0861 588341- Fax +39 0861588344

[www.seateam.com](http://www.seateam.com) - [info@seateam.com](mailto:info@seateam.com)



**SEA<sup>®</sup>**  
Sistemi Elettronici  
di Apertura Porte e Cancelli  
International registered trademark n. 804888



**SEA S.p.A.**  
**Zona industriale 64020 S.ATTO Teramo - (ITALY)**  
**Tel. +39 0861 588341 r.a. Fax +39 0861 588344**

**[www.seateam.com](http://www.seateam.com)**

**[seacom@seateam.com](mailto:seacom@seateam.com)**