

SEA®

Sistemi Elettronici
di Apertura Porte e Cancelli
International registered trademark n. 804888

CE

ITALIANO

BATTUTA MECCANICA REGOLABILE PER ALPHA

Nota: Se la piastra forata (A) è già montata, seguire le istruzioni iniziando dal punto 6, nel caso contrario seguire le istruzioni di montaggio iniziando dal punto 1.

1. Svitare i 2 dadi esagonali che si trovano sull'operatore ALPHA di ca. 3/5 mm o solo del minimo essenziale per inserire una pinza a punta per bloccare il tirante interno, a questo punto svitare completamente i dadi (Fig. 1).

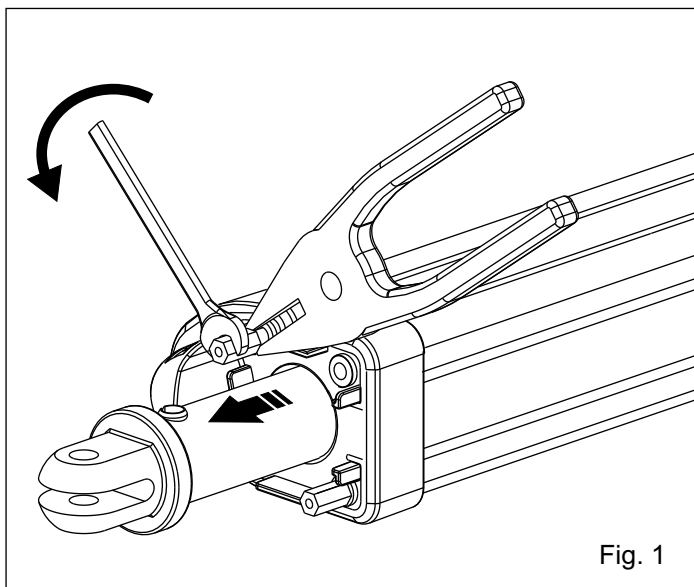

Fig. 1

2. Avvitare completamente i 2 dadi esagonali forniti con la battuta meccanica (Fig. 2).

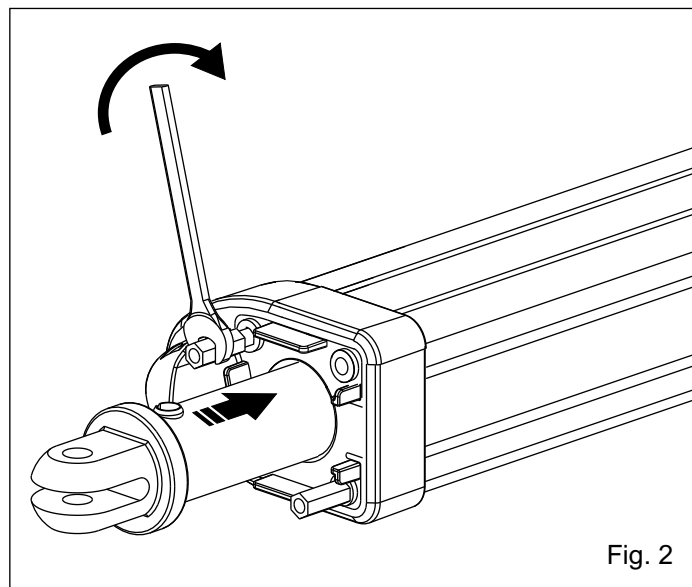

Fig. 2

3. Ruotare in senso orario lo stelo per tirarlo fuori di 15 cm ed estrarre la spina di serratura della **forcella** anteriore usando un estrattore di spine con Ø 10 ed un martello (Fig. 3).
AVVERTENZA: Verificare che tutto il lavoro sia effettuato su una superficie molto solida.

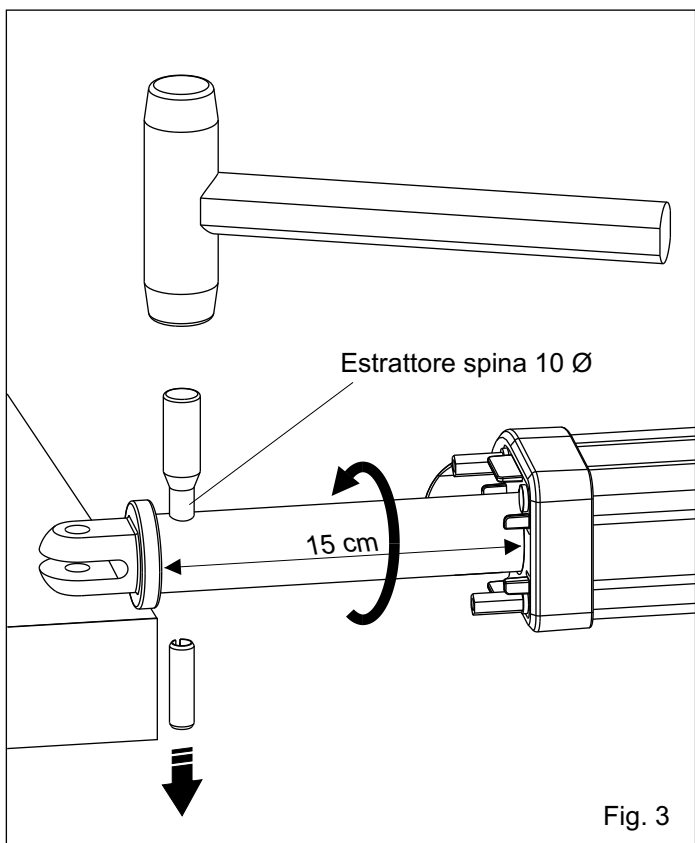

Fig. 3

4. Estrarre la forcella anteriore ed inserire la piastra forata nello stelo come in Fig. 4.

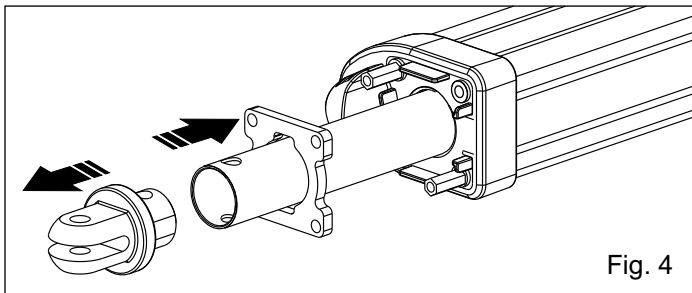

Fig. 4

5. Reinserire la forcella anteriore nello stelo e bloccarla inserendo la spina adatta (Fig. 5). Assicurarsi che la spina fuoriesca nella stessa misura da ambo i lati.

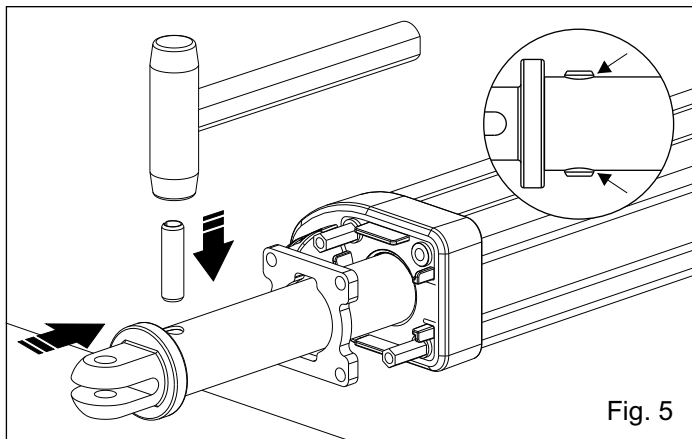
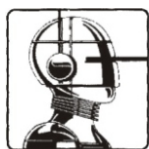

Fig. 5



SEA®

Sistemi Elettronici
di Apertura Porte e Cancelli
International registered trademark n. 804888



ITALIANO

6. Inserire i dadi ed avvitare i 4 tiranti fino al serraggio (Fig. 6).

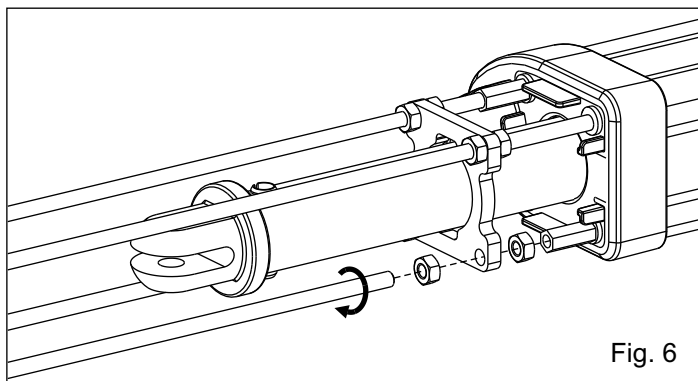

Fig. 6

7. Inserire la piastra forata nei tiranti, poi avvitare 2 dei 4 dadi precedentemente rimossi in corrispondenza delle 2 viti a morsetto del copristelo (Fig. 7).

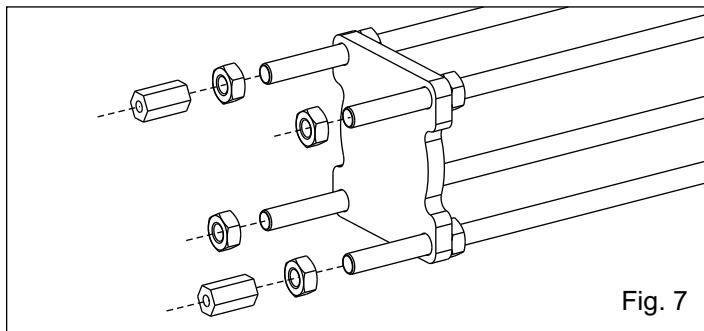

Fig. 7

8. Regolare la battuta meccanica secondo le proprie necessità, usando i dati adatti (Fig. 8).

Nota importante: la forcella anteriore deve combaciare perfettamente con la piastra 1 (fig. 9-10),

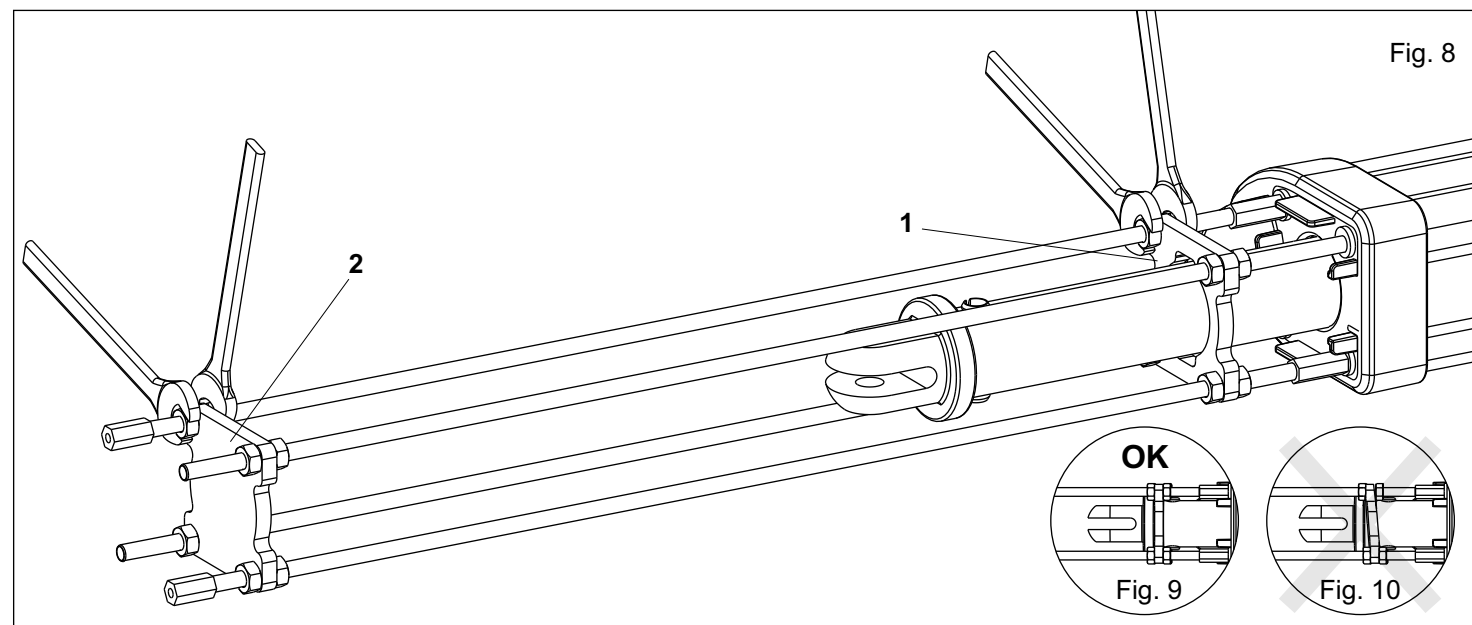

Fig. 8

9. Dopo aver terminato la regolazione, installare il copristelo (Fig. 11).

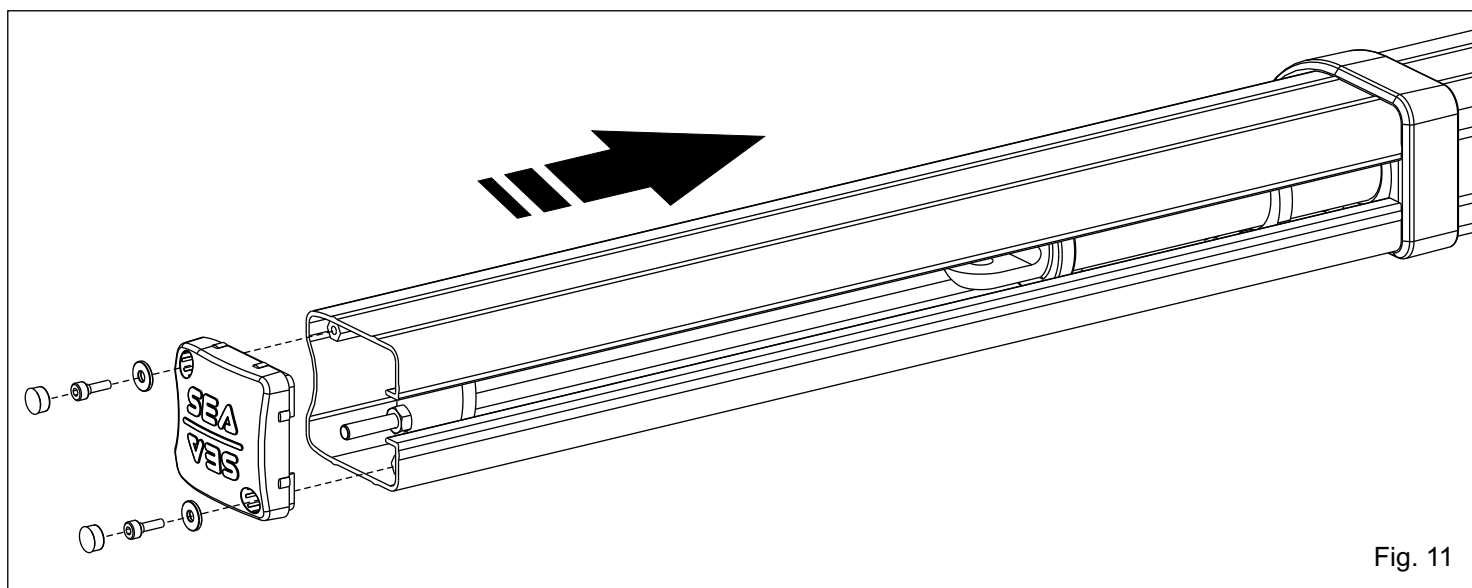
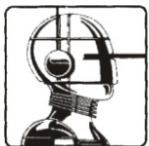

Fig. 11

Per ottimizzare la funzione dello stop, si raccomanda vivamente di installare una centralina elettronica con rallentamento in apertura e chiusura.



SEA®

Sistemi Elettronici
di Apertura Porte e Cancelli
International registered trademark n. 804888

CE

ENGLISH

ADJUSTABLE MECHANICAL STOP FOR ALPHA

Note: If the pierced plate (A) is already mounted, follow the instructions starting from point 6, in the contrary case follow the mounting instructions starting from point 1.

1. Unscrew the 2 hexagonal nuts that you find on ALPHA operator of about 3/5 mm or just the minimum essential in order to insert a tip chuck for blocking the internal tie rod, at this point unscrew completely the nuts (Fig. 1).

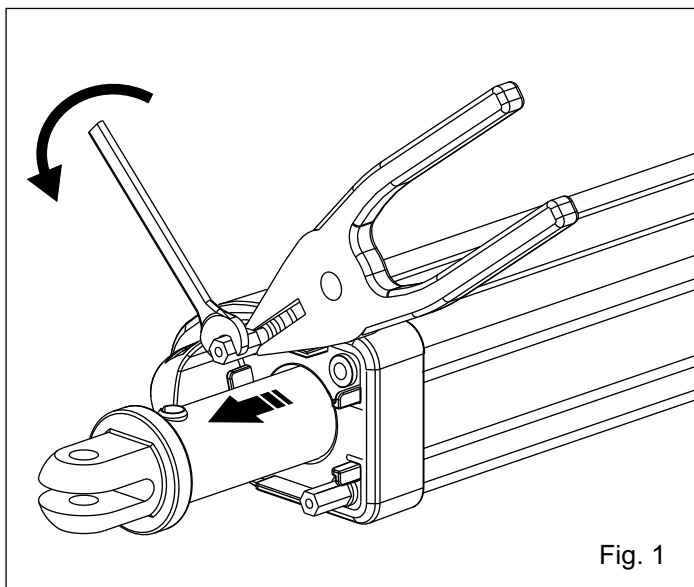

Fig. 1

2. Screw completely the 2 hexagonal nuts which are supplied with the mechanical stop (Fig. 2).

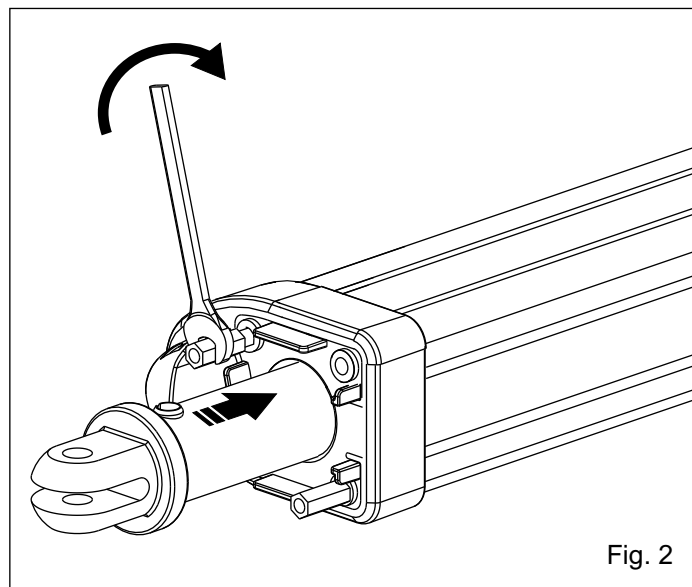

Fig. 2

3. Rotate clockwise the stem in order to pull it out of 15 cm and take out the lock pin of the front fork using a 10 Ø pin extractor and a hammer (Fig. 3).

WARNING: Take care to do everything on a very firm surface.

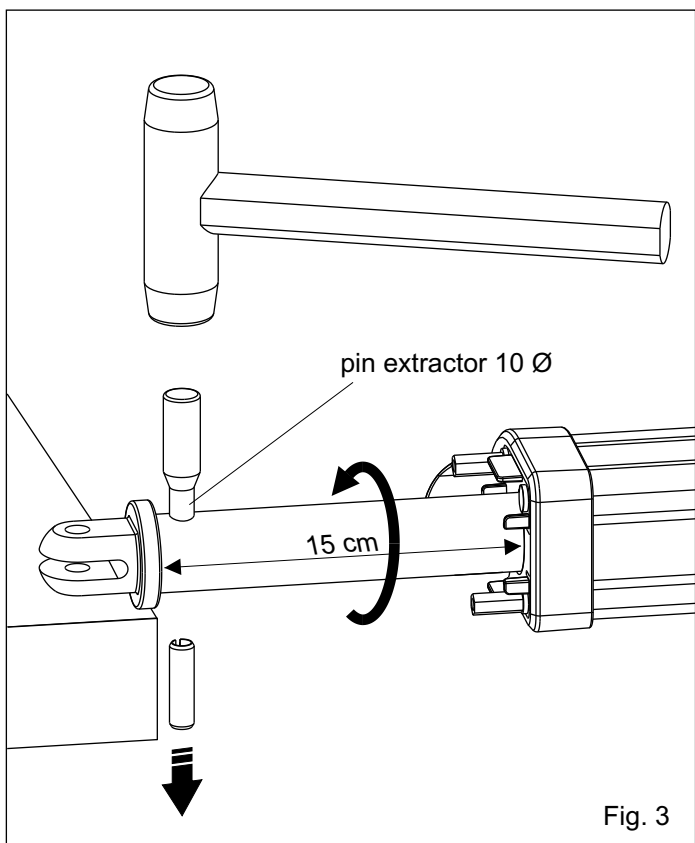

Fig. 3

4. Extract the front fork and insert the small pierced plate in the stem as in Fig. 4.

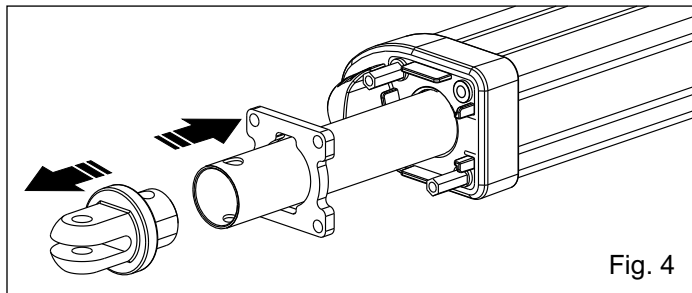

Fig. 4

5. Reinsert the front fork in the stem and lock it inserting the appropriate pin (Fig. 5).
Assure that the pin pulls in the same measure out from both sides.

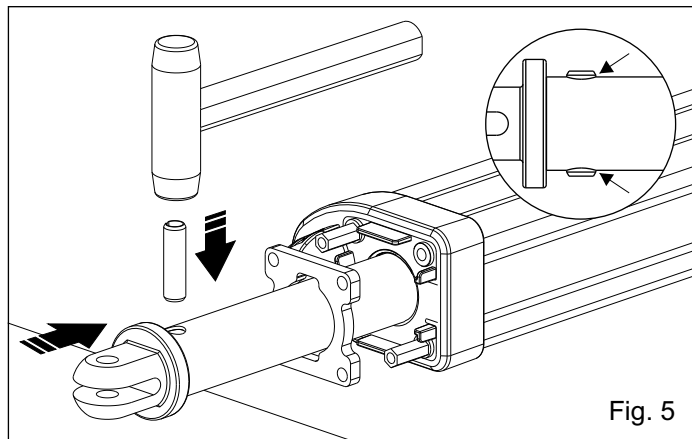
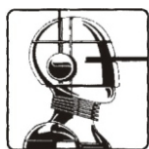

Fig. 5



SEA®

Sistemi Elettronici
di Apertura Porte e Cancelli
International registered trademark n. 804888

CE

ENGLISH

6. Insert the nuts and screw the 4 tie rods until the stop (Fig. 6).

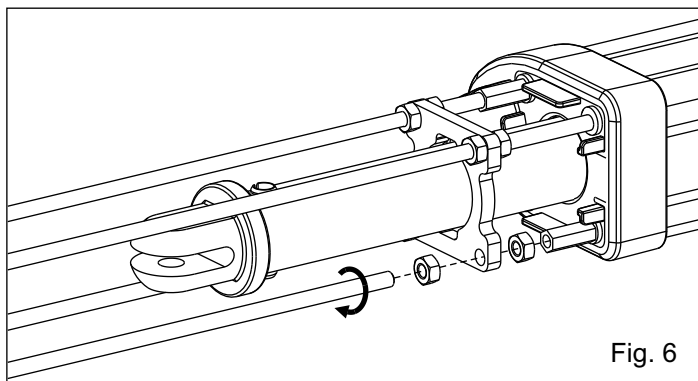

Fig. 6

7. Insert the small pierced plate in the tie rods, after that screw 2 of the 4 previously removed nuts in correspondence with the 2 clamp screws of the stem cover (Fig. 7).

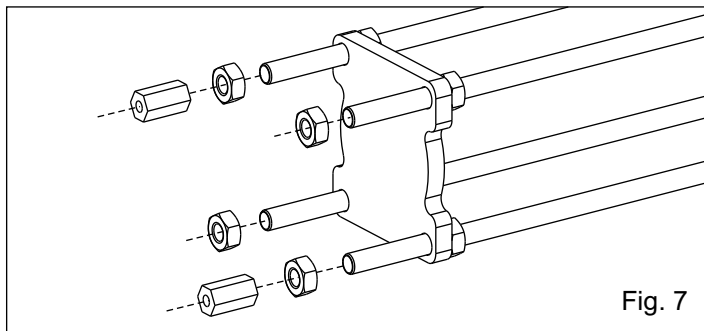

Fig. 7

8. Adjust the mechanical stop according to one's needs using the appropriate nuts (Fig. 8).

Important note: the front fork must match completely the small plate 1 (Fig. 9-10),

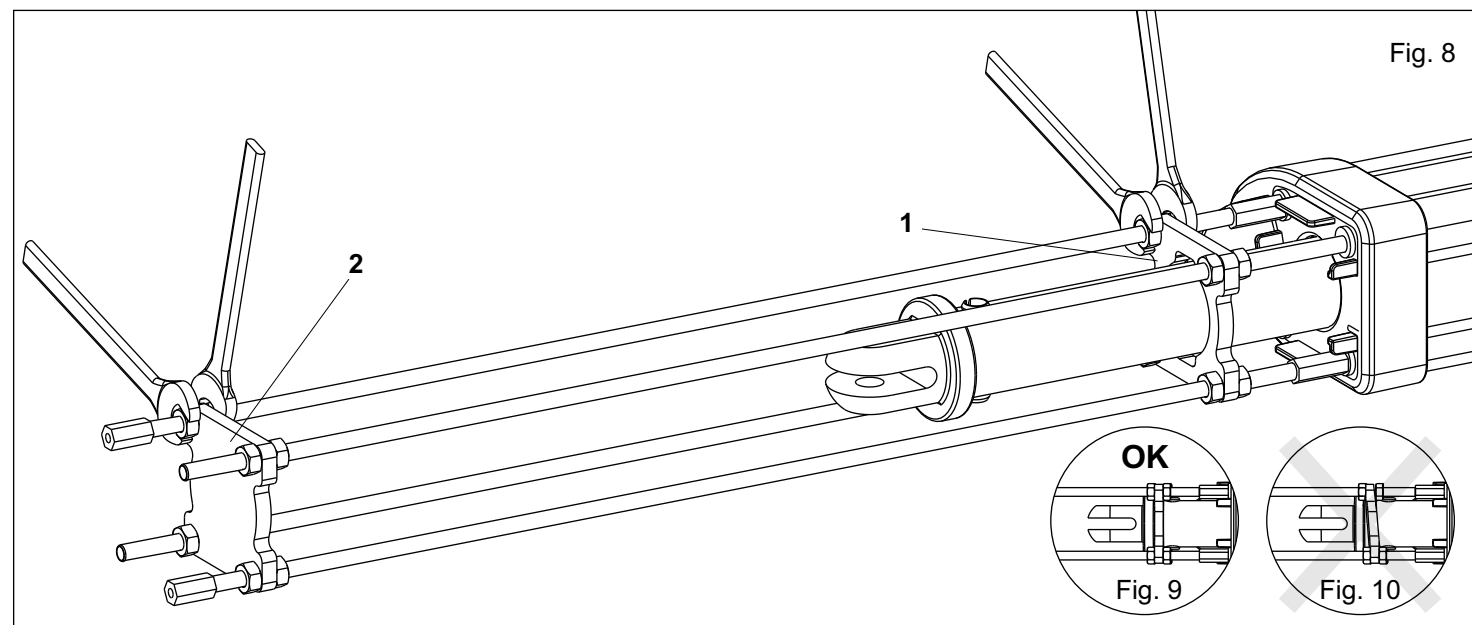

Fig. 8

9. When you finish the adjustment, install the stem cover (Fig. 11).

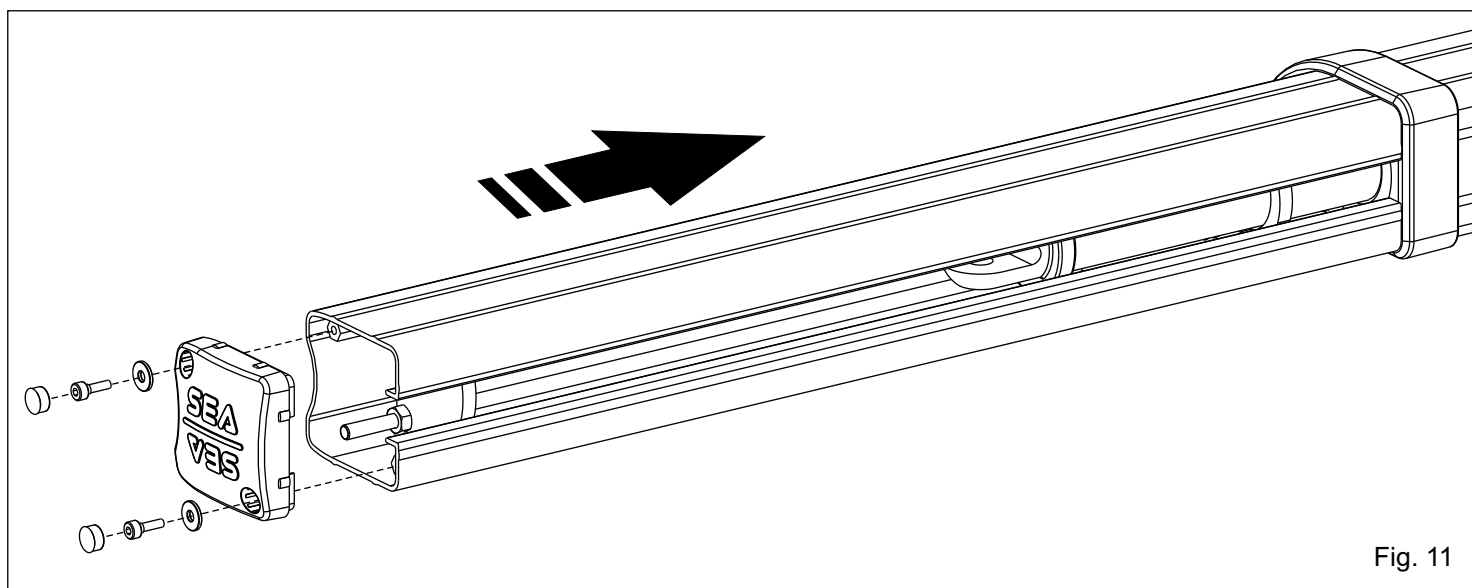

Fig. 11

In order to get a better stop functionality, it's warmly suggested to install a control unit with slowdown in opening and closing.