

CHAIN KIT

CHAIN UNIT KIT TO BE MOUNTED ON THE BIG 2000 OPERATOR

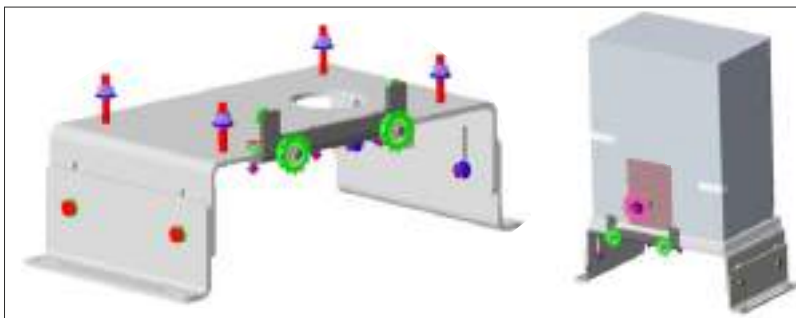

RACK PINION REPLACEMENT

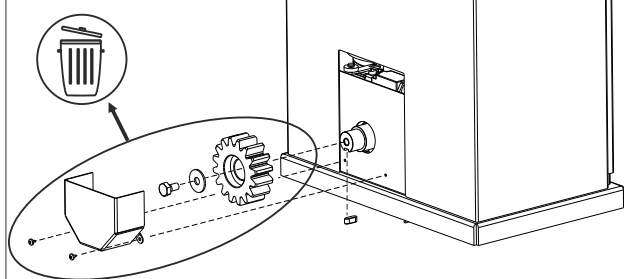

WITH THE CHAIN UNIT KIT IT IS POSSIBLE TO REPLACE THE RACK PINION WITH A CHAIN PINION

ADJUSTABLE BASE ASSEMBLY

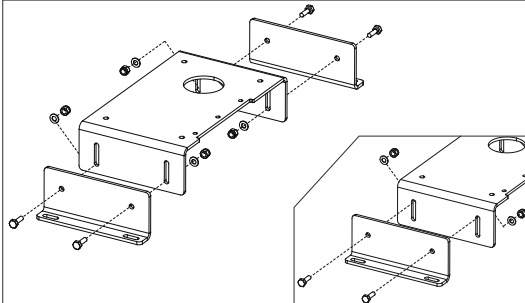

ASSEMBLE THE TWO SIDE SUPPORTS AND TIGHTEN (40 Nm) AT THE DESIRED HEIGHT
NOTE: MAKE SURE THAT THE HEIGHT OF THE TWO SUPPORTS MATCHES PERFECTLY

CHAIN SUPPORT

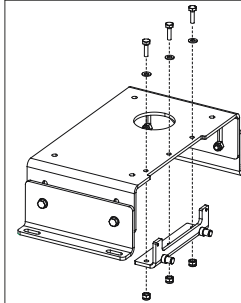

ASSEMBLE THE CHAIN SUPPORT AND TIGHTEN (40 Nm)

MOTOR UNIT ASSEMBLY

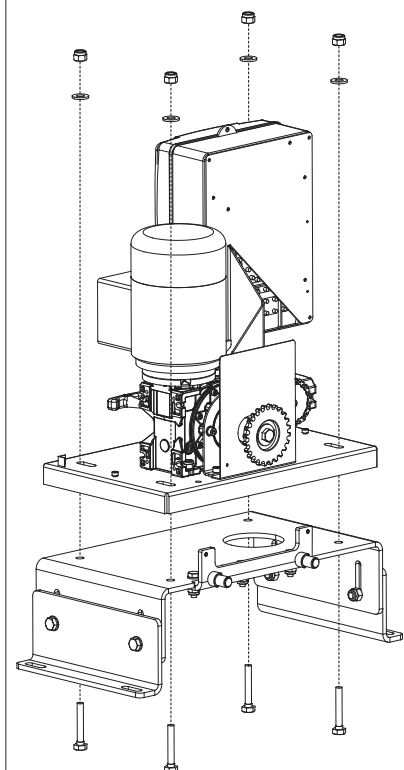

ASSEMBLE THE MOTOR UNIT ON THE BASE AND TIGHTEN (50 Nm)

CHAIN PINIONS ASSEMBLY

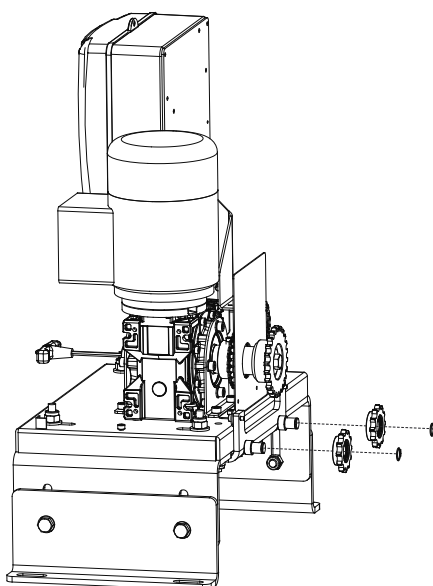

ASSEMBLE THE TWO CHAIN PINIONS AND TIGHTEN USING THE TWO LOCKS

DIMENSIONS FOR INSTALLATION

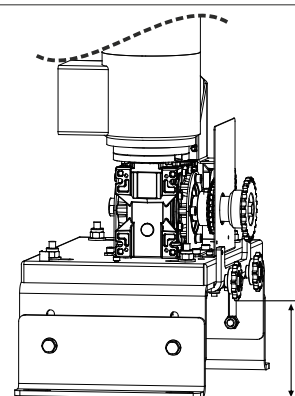
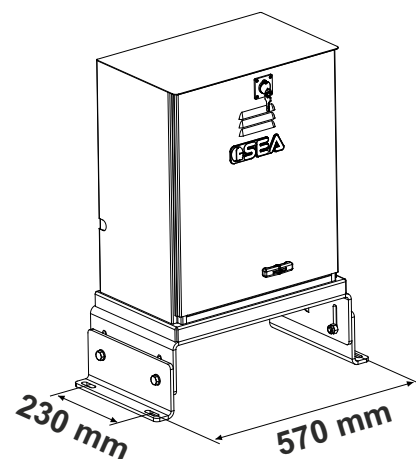

MAX. 146 mm
MIN. 96 mm

CONCRETE PAD EXCAVATION

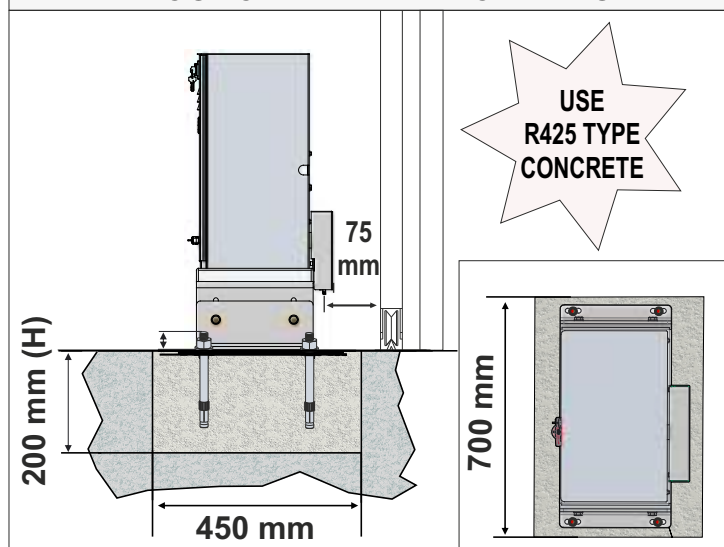

OPERATOR FASTENING ON CONCRETE PAD

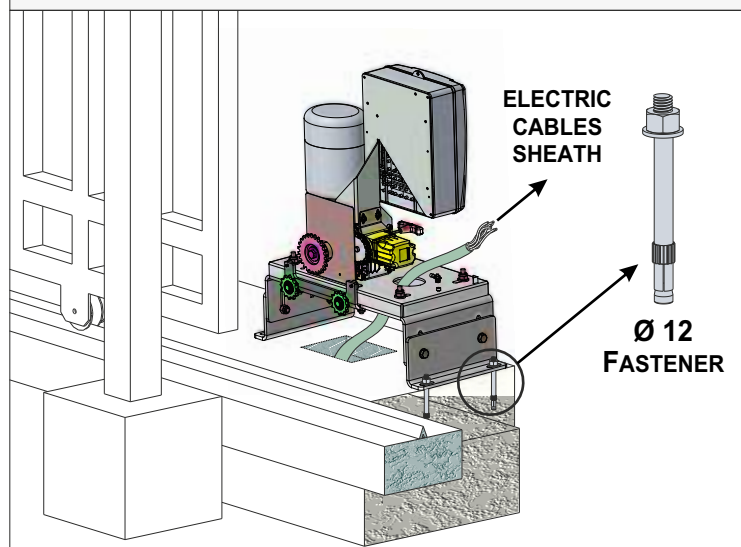

CHAIN INSTALLATION

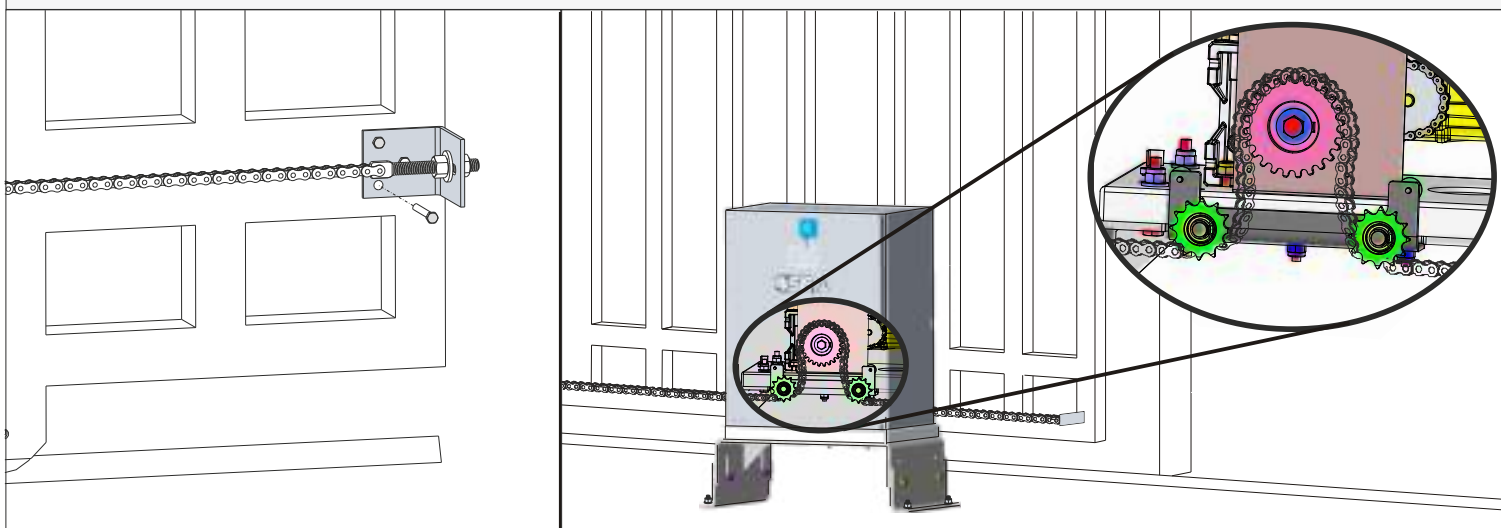

⚠ MAKE SURE THE CHAIN IS CORRECTLY INSTALLED

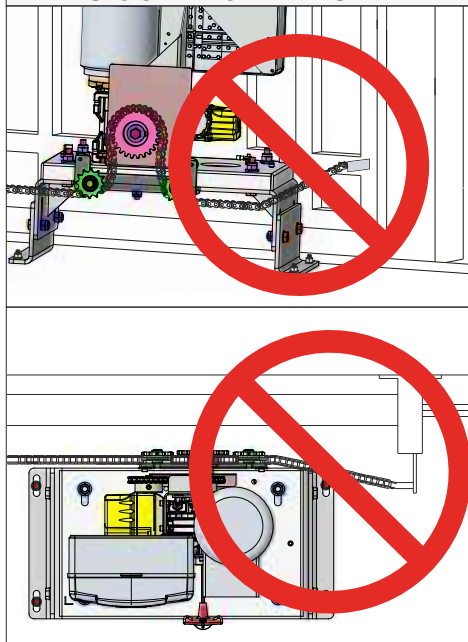

PINION COVER ASSEMBLY

